

Paper weight-110# (minimum)

Black nonfading ink required

U.S. PUBLIC LAND SURVEY MONUMENT RECORD

For Public Land Survey Corners In:

WI ADMINISTRATIVE CODE A-E 7.08 REQUIREMENT

T. 3 N. R. 10 E. 4th P.M.

REV 10/23/2004

USMONREC.DWG

CORNER CODE INDEX

MAGNOLIA TWP

ROCK COUNTY WI

IF AVAILABLE

ROCK COUNTY COORDINATES PREFERRED

	1	2	3	4	5	6	7	8	9	10	11	12	13	14	15	16	17	18	19	20	21	22	23	24	25		
A																											A
B																											B
C																											C
D																											D
E																											E
F																											F
G																											G
H																											H
J																											J
K																											K
L																											L
M																											M
N																											N
O																											O
P																											P
Q																											Q
R																											R
S																											S
T																											T
U																											U
V																											V
W																											W
X																											X
Y																											Y
Z																											Z

North _____ Elev. _____

East _____

Hor. Datum _____ Vert. Datum _____

LATITUDE _____ ELLIPS. HT. _____

LONGITUDE _____

NAD83(91) _____ NETWORK ADJ. YR 2010

GPS (X) _____ TRAVERSE (X) X

BASED ON THE FOLLOWING CONTROL:

1 2 3 4 5 6 7 8 9 10 11 12 13 14 15 16 17 18 19 20 21 22 23 24 25
PLACE MONUMENT SYMBOL AT PROPER LOCATION ON ABOVE INDEX

CORNER MONUMENT

WITNESS MONUMENT

BEARINGS ARE BASED ON: ROCK COUNTY PROJECTION

FIELD BOOK _____ PAGE # _____

OR OBSERVATION SHEET _____

SHEET 1 OF 1

SHOW A PLAN VIEW DRAWING DEPICTING THE CORNER MONUMENT AND SURROUNDING PHYSICAL FEATURES, INCLUDING THE EXCAVATION AREA AND DEPTH.

PLANNING & ZONING COMMITTEE ADOPTED THIS FORM ON 12/2/1982

CORNER CODE E-1(2)

Donald Burns
2-11-2011

AFFIDAVIT FOR STATE LINE
@ SEC 32 T1N R23E VAR 5-30E

REMARKS- THIS FOREGOING PAGES (FROM #1 TO #136) CONTAINS THE FIELD NOTES OF THE BASE LINE FOR THE SURVEY LYING WEST OF THE LAKE, WHICH BASE LINE WAS ESTABLISHED ON AND COINCIDES WITH THE LINE RUN AND ESTABLISHED AS THE NORTHERN BOUNDARY OF ILLINOIS IN 1832 & 1833. THE FOREGOING NOTES ARE HEREBY CERTIFIED TO BE CORRECT BY LUCIUS LYON D.S. AND LATE COMM?? ON THE PART OF THE U.S. DETROIT MI JUNE 21, 1833

↑ DIRECTION OF LINE RUN

FILE G:\MAGDISK\ACAD\TOWNSHINE JOG-GREEN

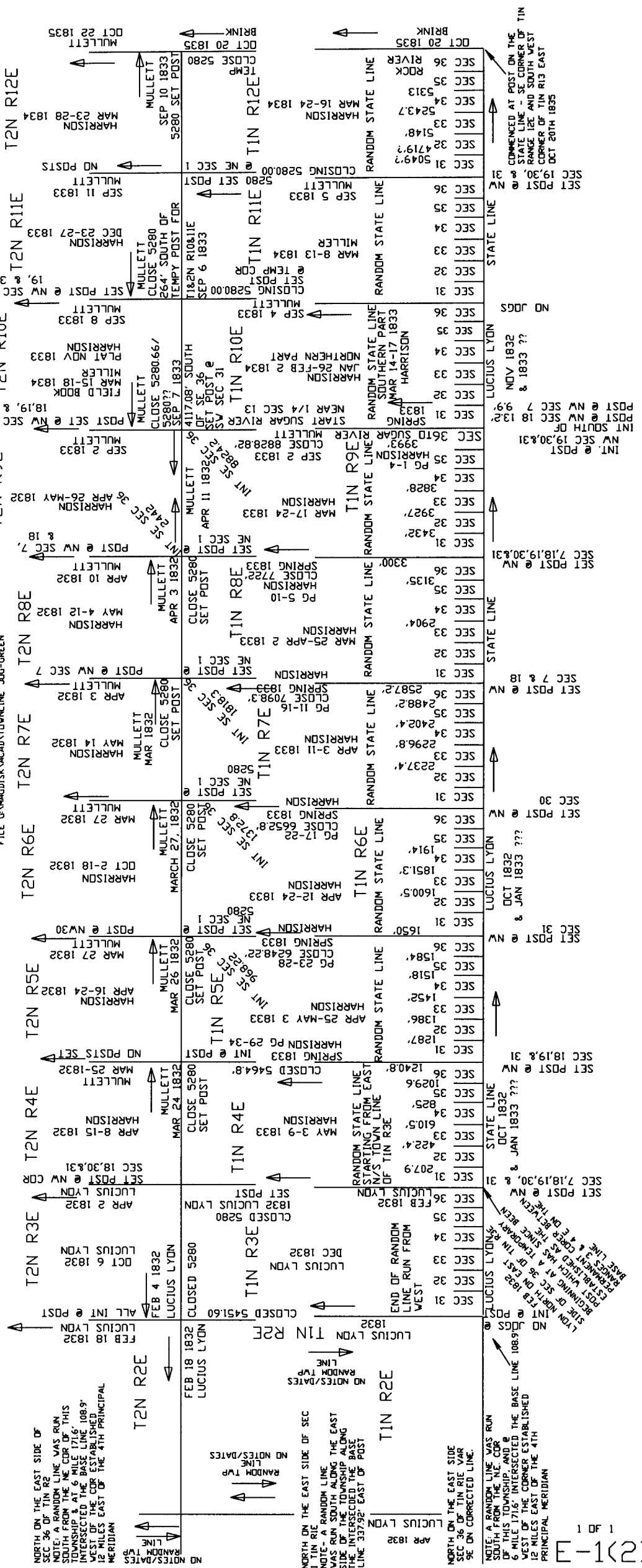

NORTH ON THE EAST SIDE OF
SEC 36 OF T1N R2E
NOTE: A RANDOM LINE WAS RUN
SOUTH FROM THE NE COR OF THIS
TOWNSHIP & AT 6 MILE 1716'
WEST OF THE COR ESTABLISHED
12 MILES EAST OF THE 4TH PRINCIPAL
MERIDIAN

NO NOTES/DATES
RANDOM LINE
↑

NORTH ON THE EAST SIDE OF SEC
1 T1N R1E
NOTE- A RANDOM LINE
WAS RUN SOUTH ALONG THE EAST
SIDE OF THE TOWNSHIP ALONG
THE INTERSECTION OF THE BASE
LINE 33792'-EAST OF POST

NO NOTES/DATES
RANDOM LINE
↑

NORTH ON THE EAST SIDE
SEC 36 OF T1N R1E VAR
9E ON CORRECTED LINE.

NOTE: A RANDOM LINE WAS RUN
SOUTH FROM THE NE COR
OF THE TOWNSHIP INTERSECTING THE BASE LINE 10892'
WEST OF THE CORNER ESTABLISHED
12 MILES EAST OF THE 4TH
PRINCIPAL MERIDIAN