

U.S. PUBLIC LAND SURVEY MONUMENT RECORD

For Public Land Survey Corners In:
T. 3N. R. 13E. 4th P.M.

WI ADMINISTRATIVE CODE A-E 7.08 REQUIREMENT
REV 10/23/2004 USMONREC.DWG

CORNER CODE INDEX

	1	2	3	4	5	6	7	8	9	10	11	12	13	14	15	16	17	18	19	20	21	22	23	24	25
A																									
B																									
C																									
D																									
E																									
F																									
G																									
H																									
J																									
K																									
L																									
M																									
N																									
O																									
P																									
Q																									
R																									
S																									
T																									
U																									
V																									
W																									
X																									
Y																									
Z																									

HARMONY TWP
ROCK COUNTY WI

IF AVAILABLE
ROCK COUNTY COORDINATES PREFERRED

North _____ Elev. _____

East _____

Hor. Datum _____ Vert. Datum _____

LATITUDE _____ ELLIPS. HT. _____

LONGITUDE _____

NAD83(91) _____ NETWORK ADJ. YR 2010

GPS (X) _____ TRAVERSE (X) X

BASED ON THE FOLLOWING CONTROL:

PLACE MONUMENT SYMBOL AT PROPER LOCATION ON ABOVE INDEX

CORNER MONUMENT

WITNESS MONUMENT

BEARINGS ARE BASED ON: ROCK COUNTY PROJECTION

FIELD BOOK _____ PAGE # _____

OR OBSERVATION SHEET _____

SHEET 1 OF 5

SHOW A PLAN VIEW DRAWING DEPICTING THE CORNER MONUMENT AND SURROUNDING PHYSICAL FEATURES, INCLUDING THE EXCAVATION AREA AND DEPTH.

PLANNING & ZONING COMMITTEE ADOPTED THIS FORM ON 12/2/1982

CORNER CODE A-17(1)

HAR509 NWCORSEC2

(B) Describe any record evidence, monument evidence, occupational evidence, testimonial evidence or any other material evidence you considered, and whether the monument was found or placed.

1869 LEE VOL 2 PG 7 FD STUMPS OF W B.T & STUMPS OF SE BT & PLACE OF OLD STAKE SET HH ON TOP. VAR 4-45 2631.42 TO SET HH @ N 1/4 COR SEC 2.

1870 RUGER REMON. SET CUT LIMESTONES.
EAST ON NORTH LINE OF NW QUARTER SEC 3 ON A VAR 4-50 INTERSECTED QUARTER LINE OF SEC 34 T4N R13 AT QUARTER COR CONTINUED EAST ON NORTH LINE OF THE NE QUARTER OF SEC 3 ON A VAR 4-50 OFFSET SOUTH 7.92'; OFFSET NORTH 28.38'; OFFSET NORTH 27.72'; OFFSET SOUTH 30.36'; OFFSET SOUTH-27.06 AT

5037.78 INTERSECTED EAST BOUNDARY LINE 0.66' SOUTH OF COR. CORRECTED VAR ON NORTH LINE OF NE QUARTER 4-38'; FD OLD STAKE ON NE COR OF SEC 3 AND STUMPS OF BOTH BEARING TREES ALSO FD OLD STAKE ON SE COR OF SEC 34 T4N R13 AND STUMP OF EAST BEARING TREE THE NE COR OF SEC AND THE SE COR OF SEC 34 AS THUS FOUND ARE 5.94' APART BEING THE DISTANCE GIVEN ON THE PLAT OF THE GOVERNMENT SURVEY ESTABLISHED NORTH-QUARTER COR OF SEC 3 ON TOWN LINE AND EQUAL DISTANT-FROM NW AND NE CORNERS OF SAID SEC IT- BEING 2617.89' FROM EACH.

EAST ON NORTH-LINE OF NW QUARTER OF SEC 2 ON A VAR 4-39' INTERSECTED QUARTER LINE OF SEC 35 T4 R 13 AT QUARTER COR CONTINUED EAST ON NORTH-LINE OF NE QUARTER OF SEC 2 ON A VAR 4-25 AT

5248.32 INTERSECTED EAST BOUNDARY LINE 6.27' SOUTH OF COR VAR 4-33' FD STONE ON COR & STUMP OF NE BEARING TREE THE DISTANCE IS 10.06' INSTEAD OF 8.74' AS GIVEN ON THE PLAT OF THE GOVERNMENT SURVEY THE ERROR HAVING PROBABLY BEEN MADE IN COPYING FROM THE ORIGINAL NOTES. ESTABLISHED NORTH QUARTER COR OF SEC 2 ON TOWN LINE AND EQUI DISTANT FROM NW AND NE CORNER OF SAID SECTION IT BEING 2624.16 FROM EACH

SOUTH ON WEST LINE OF NW QUARTER SEC 2 ON A VAR 7-30 AT

2863.24 INTERSECTED QUARTER LINE 3.3' WEST OF QUARTER COR FOUND HARD HEAD STONE ON COR AND STUMPS OF BOTH BEARING TREES. COR VAR 7-34

SOUTH ON WEST LINE OF SW QUARTER SEC 2 ON A VAR 7-55 OFFSET 13.86' AT

2635.38 INTERSECTED SOUTH BOUNDARY LINE 3.3' EAST OF COR. COR VAR 7-33

1871 RUGER REMON SET CUT LIMESTONES.
WEST ON SOUTH LINE OF SE 1/4 OF SEC 35 ON A VAR 4-33 AT

2669.70 INTERSECTED 1/4 LINE AT 1/4 COR FOUND OLD STAKE AT COR ALSO FOUND NW BEARING TREE AND WHERE STUMP OF NE BEARING TREE HAD BEEN DUG UP. THE SOUTH 1/4 COR OF SEC 35 MILTON IS 45.54' WEST OF NORTH 1/4 COR OF SEC 2 HARMONY.

Seal
Errol Bance
Emboss
May 15, 2012

HAR509 NWCORSEC2
WEST ON SOUTH-LINE OF SW 1/4 OF SEC 35 ON A VAR 4-39'
AT

2638.68 INTERSECTED WEST BOUNDARY LINE AT COR
FOUND OLD STAKE AT COR ALSO FOUND
STUMP OF EAST BEARING TREE. THE SOUTH
WEST COR OF SEC 35 MILTON IS 60.06' WEST
OF THE NW COR OF SEC 2 HARMONY.

WEST ON SOUTH-LINE OF SE 1/4 OF SEC 34 ON A VAR 4-38
AT

2639.34 INTERSECTED 1/4 LINE AT 1/4 COR. FOUND
OLD STAKE AT COR ALSO FOUND STUMP OF NW
BEARING TREE AND WHERE STUMP OF NE
BEARING TREE HAD BEEN DUG UP. THE SOUTH
1/4 COR OF SEC 34 MILTON IS 81.51' WEST OF
THE NORTH 1/4 COR OF SEC 3 HARMONY.

WEST ON SOUTH LINE OF SW 1/4 OF SEC 34 ON A VAR 4-50
AT

2639.34 INTERSECTED WEST BOUNDARY LINE AT COR
FOUND IRON PIN SURROUNDED BY STONES ON
COR ALSO FOUND STUMPS OF BEARING TREES.
THE SW COR OF SEC 34 MILTON IS 102.96'
WEST OF THE NW COR OF SEC 3 HARMONY.

- 1873 LEE VOL 2 PG 99 FD MON 2623.01 TO FD MON @ N 1/4 COR
SEC 2
- 1964 BATTERMAN VOL 4 PG 198 DUG 20X16X4 FD NOTHING.
- 1968 BATTERMAN VOL 4 PG 366 DUG & FD NOTHING SEE PG 485
VOL 4. SE COR SEC 34 MILTON TWP FD CUT STONE BROKEN
OFF BOTTOM PART REMAINS 2' DEEP. SET MON. BOX. PK
NAILS 5' S & 10" W. CORNER IS WEST OF HENKE RD.
- 1970 BATTERMAN VOL 4 PG 485 SET PIPE AT NE COR SEC 3. FD
PIPE IN MON BOX AT THE SW COR SEC 35 MILTON TWP.
59.40 EAST OF THE SW COR SEC 35. REFERENCED
CORNER.
- 1970 THOM GSM VOL 2 PG 13 RESET THE NW COR OF SEC 2 FROM
RUGER'S RESURVEY NOTES. SET PIPE. 59.40 TO SW COR
SEC 35.
- 1981 BARNES VOL 6 PG 165 FD CI. MON @ NW COR SEC 2, FD 1"
PIPE IN MON BOX @ SE COR SEC 34 MILTON TWP. 59.40
BETWEEN MONUMENTS. REFERENCED SAME.
- 1981 BARNES VOL 6 PG 210 SW COR SEC 35 FD 36" DEEP IN OLD
PVMT-SET ALUM. MON. NW COR SEC 2 HARMONY 40" DEEP
FD REMAINS OF SAST IRON MON. SET ALUM. 59.38
BETWEEN CORNERS.
- 1983 BARNES MILTON TWP PROJECT N87-45-15W 2640.73 TO S
1/4 COR SEC 34, S87-50-00E 2642.25 TO S 1/4 COR SEC
35, N0-40-13W 2650.45 TO E 1/4 COR SEC 34.
- 1985 BARNES HARMONY TWP PROJECT
NW COR SEC 2 TO N 1/4 COR SEC 2 S87-47-40E 2628.80
NW COR SEC 2 TO W 1/4 COR SEC 2 S0-41-42E 2868.48,
N 1/4 COR SEC 3 TO NW COR SEC 2 S87-41-16E 2618.21
NW COR SEC 3 TO N 1/4 COR SEC 3 S87-53-23E 2619.84,
N 1/4 COR SEC 2 TO NE COR SEC 2 S88-17-25E 2624.87
NW COR SEC 2 TO SW COR SEC 35 N87-43-58W 59.00
N 1/4 COR SEC 2 TO S 1/4 COR SEC 35 N87-47-21W 45.54
N 1/4 COR SEC 3 TO S 1/4 COR SEC 34 N88-22-01W 81.44

Seal

Donald Barnes

May 15, 2012

SHEET 2 OF 5
CORNER CODE A-17(1)

HAR509

NWCORSEC2

- 1990 COMBS GSM VOL 14 PG 282 FD ALUM @ NW COR SEC 2 & SE COR SEC 34. NW COR IS 59.27 EASTERLY OF SE COR SEC 34, SO-41-45E 2868.48 TO ALUM @ E 1/4 COR SEC 3. N87-41-45W TO N 1/4 COR SEC 3.
- 1993 COMBS GSM VOL 16 PG 315 ALUM MON SO-41-45E 2668.48 TO ALUM @ E 1/4 COR SEC 3
- 1994 BARNES A-17 NAD83(1991) COORDINATES WERE PROVIDED BY STRAND ASSOCIATES FOR STH 26 PROJECT. CONVENTIONAL TRAVERSE WAS USED TO CONNECT SECTION CORNERS TO DOT GPS STATIONS. GPS STATIONS WERE ESTABLISHED PRIOR TO ROCK COUNTY'S GPS NETWORK. STRAND & ASSOCIATES USED A SCALE FACTOR OF 0.9999950000 FOR REDUCING GROUND TO GRID DISTANCE. I USED STRANS' STATE PLANE COORDINATES TO COMPUTE THE ABOVE LATITUDE, LONGITUDE, COUNTY COORDINATES, SCALE FACTOR, AND ANGLE BETWEEN THE TRUE NORTH AND COUNTY MAPPING PROJECTION NORTH. LAT 42-45-29.44550 LON 88-56-07.65355 N/S 296,593.53; E/W 516,731.52 SCALE 0.9999975413 ANGLE +0-05-34.3
- 1997 VOL 6 PG 451 DOT R/W PROJECT #1390-03-21 DATED 1/12/96 WITH REVISION DATES 1/2/96 & 3/17/97 SIGNED & SEALED BY PETER WOOD SE SEC 34 MILTON TWP ALUM 278,162.10; 2,254,334.23
- 2001 COMBS BK 32 PG 507 "WATERMAN ESTATES" FD ALUM. MON. 2668.39 TO E 1/4 COR SEC 3.
- 2003 COMBS BK 32 PG 590 "WATERMAN ESTATES FIRST ADDITION" FD ALUM @ NE COR SEC 3 2668.39 TO CI @ E 1/4 COR SEC 3.

@ NW COR SEC 2 FD ALUM MON 7' SOUTH OF PVMT CENTER & @ SW COR SEC 35 FD ALUM. MON. 59.34 BETWEEN MONUMENTS. BASED ON RECORDS THERE SHOULD BE RECORD MONUMENTS ABOUT 5' DEEP.

C) Was the corner restored through acceptance of (1) an obliterated evidence location, or, (2) a found perpetuated location?

ACCEPTED MONUMENTS OF RECORD.

D) Describe any material discrepancy between the location of the corner as restored or reestablished and the location of that corner as previously restored or reestablished by distance and direction. Show the discrepancy on the plan view drawing under (a), above. Show the distances between the corner as previously restored or reestablished and (1) the corner as restored or reestablished, and (2) to at least 4 of the witness monuments shown on the drawing in (a), above.

(E) Was the corner reestablished through lost corner proportionate methods? If so, show the method, including the directions and distances to other public land survey corners used as evidence or used for proportioning the corner location.

I, **Donald Barnes**, hereby certify that the corner location as identified by the corner code index was determined by me under my direction and control and that this U.S. Public Land Survey Monument Record is correct and complete to the best of my knowledge and belief.

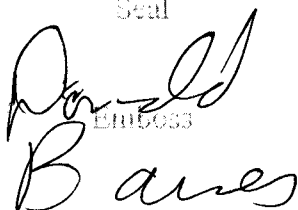
Seal

Embloss

SHEET 3 OF 5

CORNER CODE A-17(1)

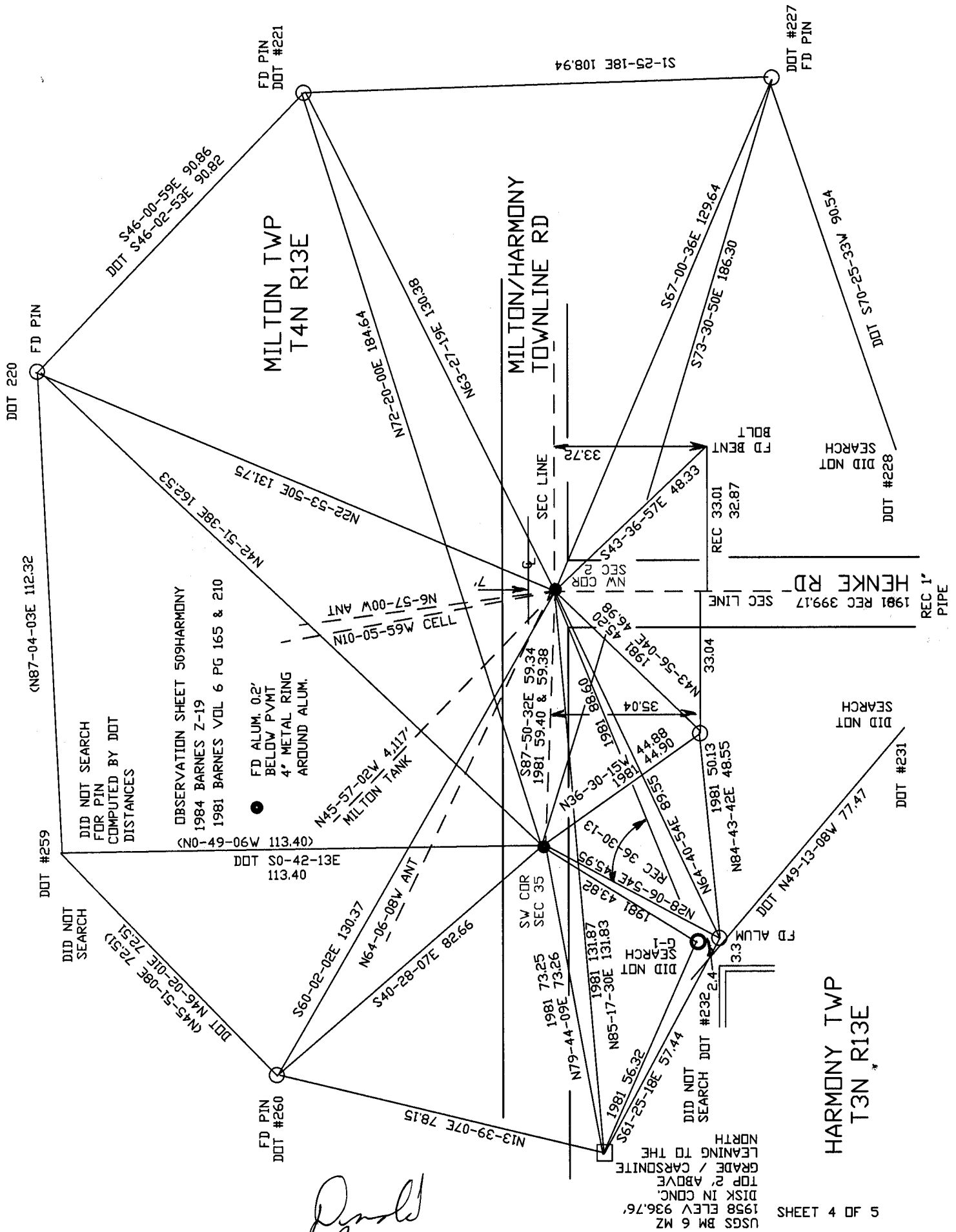
May 15, 2012 A.E. 7.08 REQUIREMENT



Donald Bruce
 EMBOSSED SEAL
 Bruce
 May 15, 2012

USGS BM 6 MZ
 1958 ELEV 936.76
 DISK IN CONC.
 TOP R ABOVE
 GRADE / CARSONITE
 LEANING TO THE
 NORTH

A-17(1)

1871 RUGER REMON VAR4-50 2639.34

1870 RUGER REMON VAR4-50 2617.89
1985 BARNES REMON S87-53-23E 2619.84

EMBOSSED SEAL

Arnold

*Baney
May 15, 2012*

1985 BARNES REMON S88-22-01E 81.44
1871 RUGER REMON 81.51

1983 BARNES REMON N87-45-15W 2640.73
1871 RUGER REMON VAR 4-38 2639.34

T4N R13E

SFC 34

1871 RUGER REMON VAR7-15 2647.92

1983 BARNES REMON NO-40-13W 2650.45

1836 LYDN 59.4
1871 RUGER REMON 60.06
1970 THOM CSM2-13 59.40
1970 BATTERMAN VOL 4 PG 485 59.40
1981 BARNES VOL6-165 59.40
1985 BARNES REMON N87-43-58W 59.00
1990 COMBS CSM14-282 59.27

SFC 35

1871 RUGER 45.54
1985 BARNES REMON S87-47-21E 45.54

1983 BARNES REMON S87-50-00E 2642.25
1871 RUGER VAR4-39 2638.68

1869 LEE VOL 2 PG 7 VAR4-45 2631.42
1870 RUGER REMON VAR4-25 2624.16
1873 LEE VOL 2 PG 99 2623.01
1985 BARNES REMON S87-47-40E 2628.80

1871 RUGER REMON VAR4-33 2669.70

1870 RUGER REMON VAR4-25 2624.16
1985 BARNES REMON S88-17-25E 2624.87

T3N R13E

SFC 2

1993 COMBS CSM16-315 S0-41-45E 266.48
1990 COMBS CSM14-282 S0-41-45E 266.48
1985 BARNES REMON S0-41-42E 286.40
1870 RUGER REMON VAR7-34 286.40