

Paper weight-110# (minimum)

Black nonfading ink required

U.S. PUBLIC LAND SURVEY MONUMENT RECORD

For Public Land Survey Corners In:

WI ADMINISTRATIVE CODE A-E 7.08 REQUIREMENT

T. 3N. R. 10E. 4th P.M.

REV 10/23/2004

USMONREC.DWG

CORNER CODE INDEX

	1	2	3	4	5	6	7	8	9	10	11	12	13	14	15	16	17	18	19	20	21	22	23	24	25	
A																										A
B																										B
C																										C
D																										D
E																										E
F																										F
G																										G
H																										H
J																										J
K																										K
L																										L
M																										M
N																										N
O																										O
P																										P
Q																										Q
R																										R
S																										S
T																										T
U																										U
V																										V
W																										W
X																										X
Y																										Y
Z																										Z

MAGNOLIA TWP

ROCK COUNTY WI

IF AVAILABLE
ROCK COUNTY COORDINATES PREFERRED

North _____ Elev. _____

East _____

Hor. Datum _____ Vert. Datum _____

LATITUDE _____ ELLIPS. HT. _____

LONGITUDE _____

NAD83(91) _____ NETWORK ADJ. YR 2010

GPS (X) _____ TRAVERSE (X) X

BASED ON THE FOLLOWING CONTROL:

1 2 3 4 5 6 7 8 9 10 11 12 13 14 15 16 17 18 19 20 21 22 23 24 25
PLACE MONUMENT SYMBOL AT PROPER LOCATION ON ABOVE INDEX

CORNER MONUMENT

WITNESS MONUMENT

(a) BEARINGS ARE BASED ON: ROCK COUNTY PROJECTION

FIELD BOOK _____ PAGE # _____

OR OBSERVATION SHEET _____

SHEET 1 OF 1

SHOW A PLAN VIEW DRAWING DEPICTING THE CORNER MONUMENT AND SURROUNDING PHYSICAL FEATURES, INCLUDING THE EXCAVATION AREA AND DEPTH.

PLANNING & ZONING COMMITTEE ADOPTED THIS FORM ON 12/2/1982

CORNER CODE J-1(3)

2-21-2011
 Donald Barnes

AFFIDAVIT FOR STATE LINE
 @ SEC 32 TIN R2E VAR 5-30E

REMARKS- THIS FOREGOING PAGES (FROM #1 TO #136) CONTAINS THE FIELD NOTES OF THE BASE LINE FOR THE SURVEY LYING WEST OF THE LAKE, WHICH BASE LINE WAS ESTABLISHED ON AND COINCIDES WITH THE LINE RUN AND ESTABLISHED AS THE NORTHERN BOUNDARY OF ILLINOIS IN 1832 & 1833. THE FOREGOING NOTES ARE HEREBY CERTIFIED TO BE CORRECT BY LUCIUS LYON D.S. AND LATE COMM?? ON THE PART OF THE U.S. DETROIT MI JUNE 21, 1833

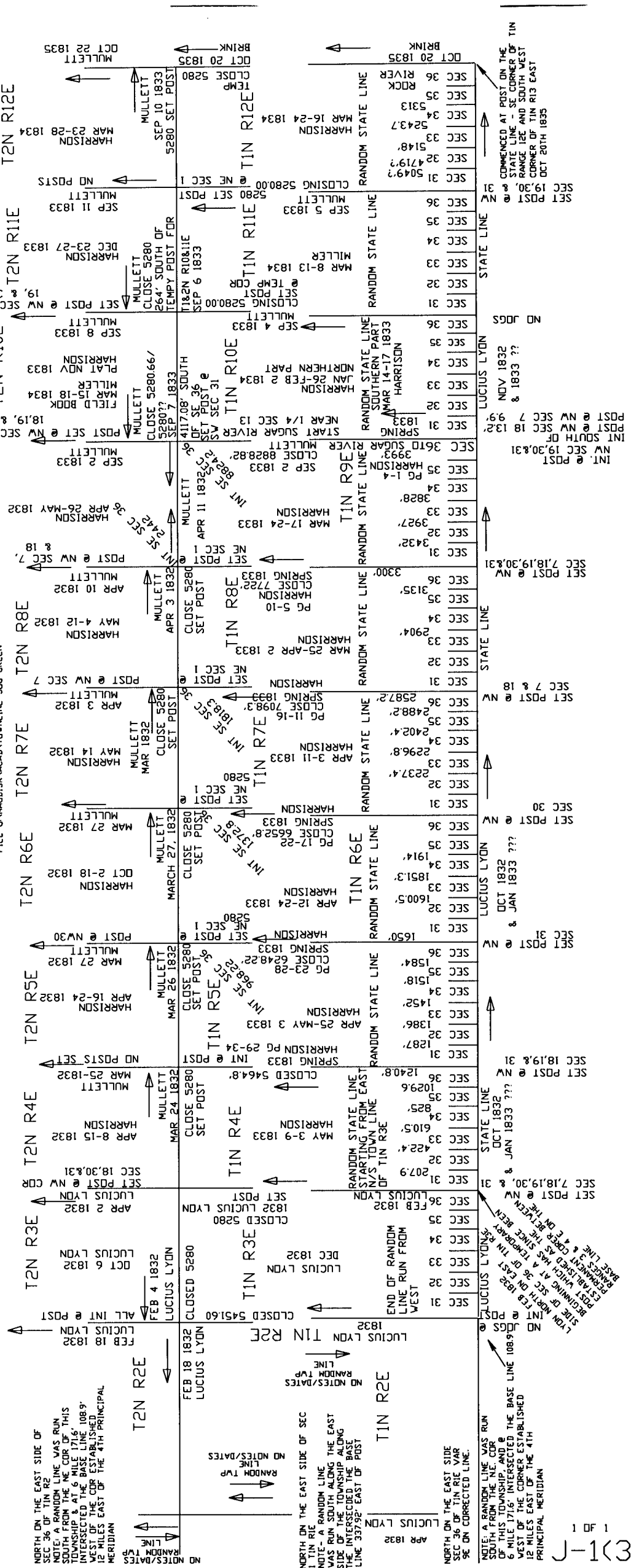

GREEN COUNTY

RDCK COUNTY

FILE G:\NAGDISK\ACAD\TOWNSHINE JOG-GREEN

→ DIRECTION OF LINE RUN

NORTH ON THE EAST SIDE OF
 SEC 36 OF TIN R2E
 NOTE- A RANDOM LINE WAS RUN
 SOUTH FROM THE NE COR OF THIS
 TOWNSHIP ALONG THE BASE LINE
 INTERSECTING THE 6 MILE LINE 1089'
 WEST OF THE COR ESTABLISHED
 12 MILES EAST OF THE 4TH PRINCIPAL
 MERIDIAN

NORTH ON THE EAST SIDE OF SEC
 1 TIN R1E
 NOTE- A RANDOM LINE
 WAS RUN SOUTH ALONG THE EAST
 SIDE OF THE TOWNSHIP ALONG
 WITH THE LINE RUN AND ESTABLISHED
 AS THE NORTHERN BOUNDARY OF
 ILLINOIS IN 1832 & 1833. THE
 FOREGOING NOTES ARE HEREBY
 CERTIFIED TO BE CORRECT BY
 LUCIUS LYON D.S. AND LATE
 COMM?? ON THE PART OF THE U.S.
 DETROIT MI JUNE 21, 1833

NORTH ON THE EAST SIDE
 SEC 36 OF TIN R2E VAR
 5-30E ON CORRECTED LINE:

NOTE: A RANDOM LINE WAS RUN
 SOUTH FROM THE NE COR
 OF THIS TOWNSHIP, AND @
 6 MILE 1716' INTERSECTED THE BASE LINE
 ESTABLISHED
 12 MILES EAST OF THE 4TH
 PRINCIPAL MERIDIAN

(3) J-1
 1 of 1