

U.S. PUBLIC LAND SURVEY MONUMENT RECORD

For Public Land Survey Corners in:

WI ADMINISTRATIVE CODE A-E 7.08 REQUIREMENT

T. 1N., R. 13E

CORNER CODE INDEX

	1	2	3	4	5	6	7	8	9	10	11	12	13	14	15	16	17	18	19	20	21	22	23	24	25
A																									
B																									
C	6																								
D																									
E																									
F																									
G	7																								
H																									
J																									
K	18																								
L																									
M																									
N																									
O																									
P	19																								
Q																									
R																									
S	30																								
T																									
U	29																								
V																									
W																									
X	31																								
Y																									
Z																									

TURTLE TWP
ROCK COUNTY WI

IF AVAILABLE
ROCK COUNTY COORDINATES PREFERRED

North _____ Elev. _____

East _____

Hor. Datum _____ Vert. Datum _____

LATITUDE _____ ELLIPS. HT. _____

LONGITUDE _____

GPS (X) _____ TRAVERSE (X) _____

BASED ON THE FOLLOWING CONTROL:

PLACE MONUMENT SYMBOL AT PROPER LOCATION ON ABOVE INDEX

CORNER MONUMENT

WITNESS MONUMENT

(a)

BEARINGS ARE BASED ON: _____

FIELD BOOK _____ PAGE # _____

SHEET _____ OF _____

SHOW A PLAN VIEW DRAWING DEPICTING THE CORNER MONUMENT AND SURROUNDING PHYSICAL FEATURES, INCLUDING THE EXCAVATION AREA AND DEPTH.

PLANNING & ZONING COMMITTEE ADOPTED THE ABOVE FORM ON 12/2/1982

CORNER CODE z 7/8 (1)

"MONUMENT RECORD"

OF
LAND SURVEY MONUMENTS
SITUATED IN SECTION 2
TOWNSHIP 46 NORTH
RANGE 2 EAST, THIRD P.M.
WINNEBAGO COUNTY, IL

RECOVERY TIE DRAWING
(NOT TO SCALE)

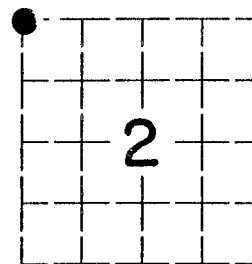

ROW CROPS

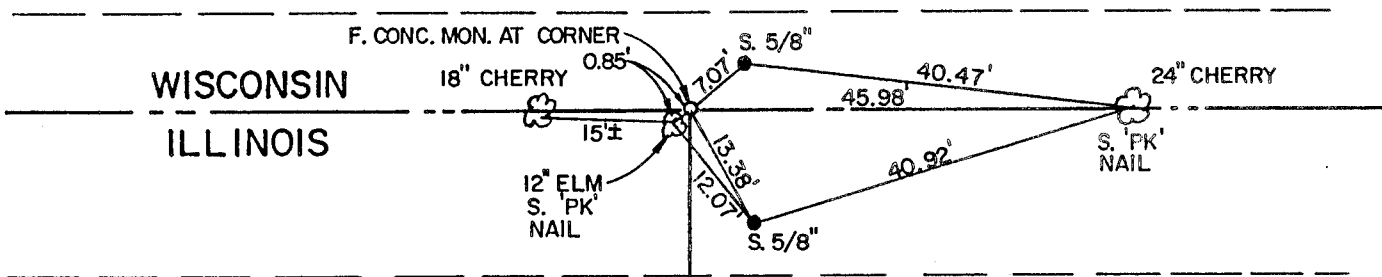

WISCONSIN
ILLINOIS

ROW CROPS

MONUMENT DESCRIPTION AND REMARKS:

FOUND CONC. MON. AT CORNER. SET (2)

5/8" IRON PINS. SET 'PK' NAILS IN

TREES.

SHEET 3 OF 4

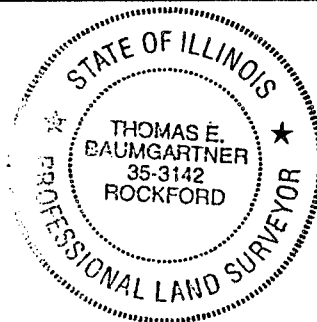

z 7/8 (1)