

298 VOL. 5 PLAT AND RECORD

Of a Survey on Section 26 T 2 R 14 E. of the 4 P. M. BRADFORD Township
Rock County, Wisconsin, made JULY 7 1977

I hereby certify that the following is a correct record of said survey as made by me.
COUNTY BUILDING
CITY OF JANESVILLE

Donald Barnes

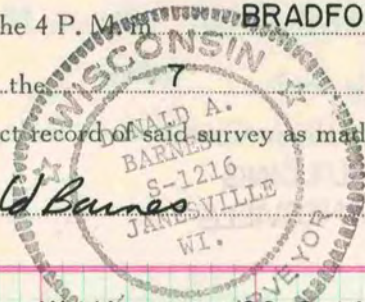

County Surveyor.

MICROFILMED

W 1/4 cor sec 26-2-14
fd 1/2" pin 0-3 HH as set by
C. Shimeall. set alum mon.

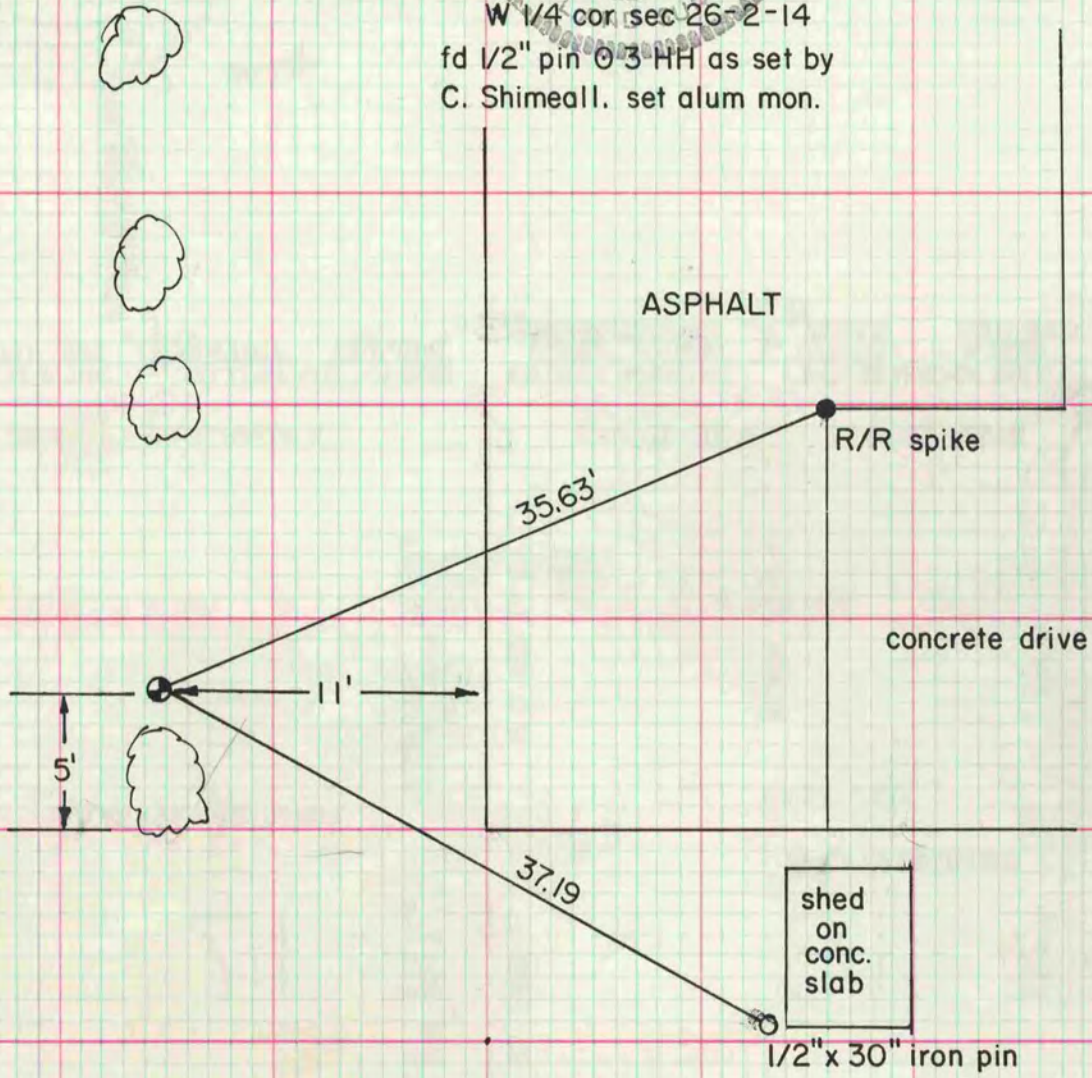

SW cor sec 26-2-14
fd 1/2" iron pin 0 by 4 HHs as set
by C. Shimeall. set alum mon.

