

572
VOL. 5

PLAT AND RECORD

COUNTY BUILDING
CITY OF JANESVILLE

Of a Survey on Section **22** T **4** R **14** E. of the 4 P. M. in **LIMA** Township
Rock County, Wisconsin, made **SEPTEMBER 10** 19**79**

I hereby certify that the following is a correct record of said survey as made by me.

Donald A. Barnes
County Surveyor.

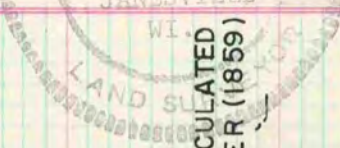

SET ALUMINUM MONUMENT ON LINE
WITH NE & SE CORNERS AT
SINGLE PROPORTIONATE DISTANCE

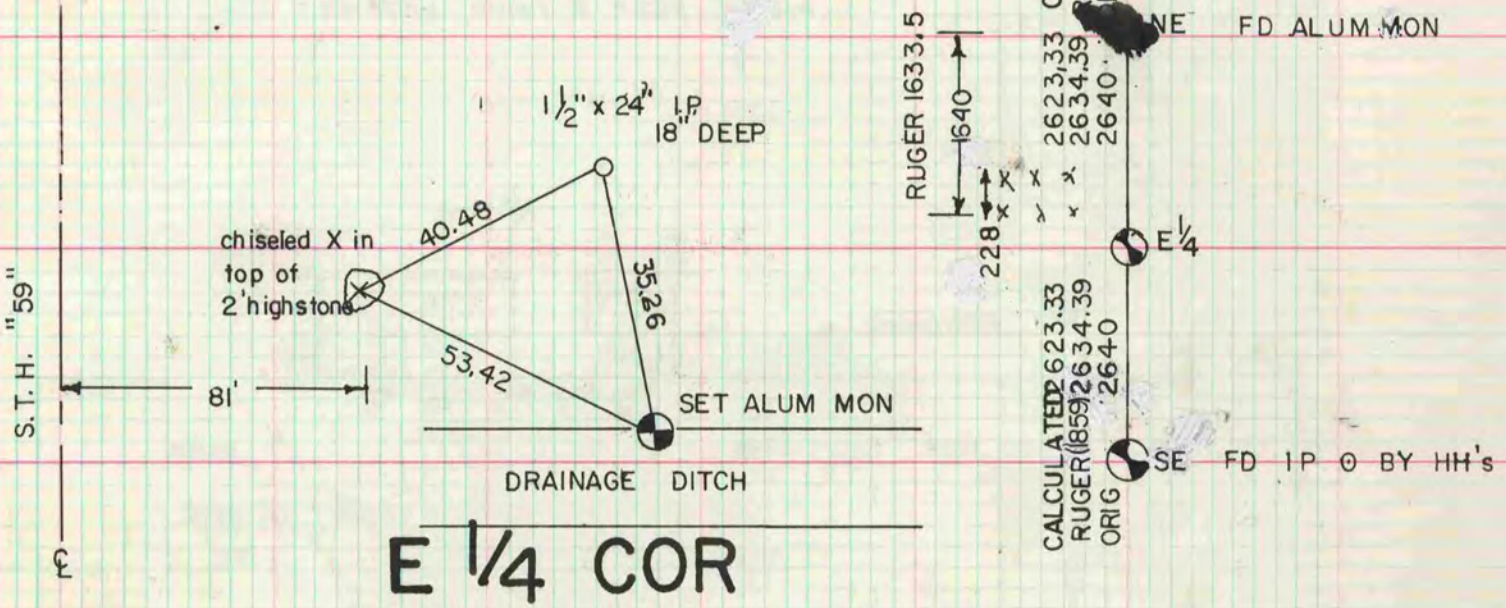

MICROFILMED