

PLAT AND RECORD

COUNTY BUILDING DEPT.
CITY OF JANESVILLE

Of a Survey on Section 11 T 3 R 13 E. of the 4 P. M. in HARMONY Township

Rock County, Wisconsin, made JULY the 15 1963

I hereby certify that the following is a correct record of said survey as made by me.

MICROFILMED

R.A. Bateman
County Surveyor.

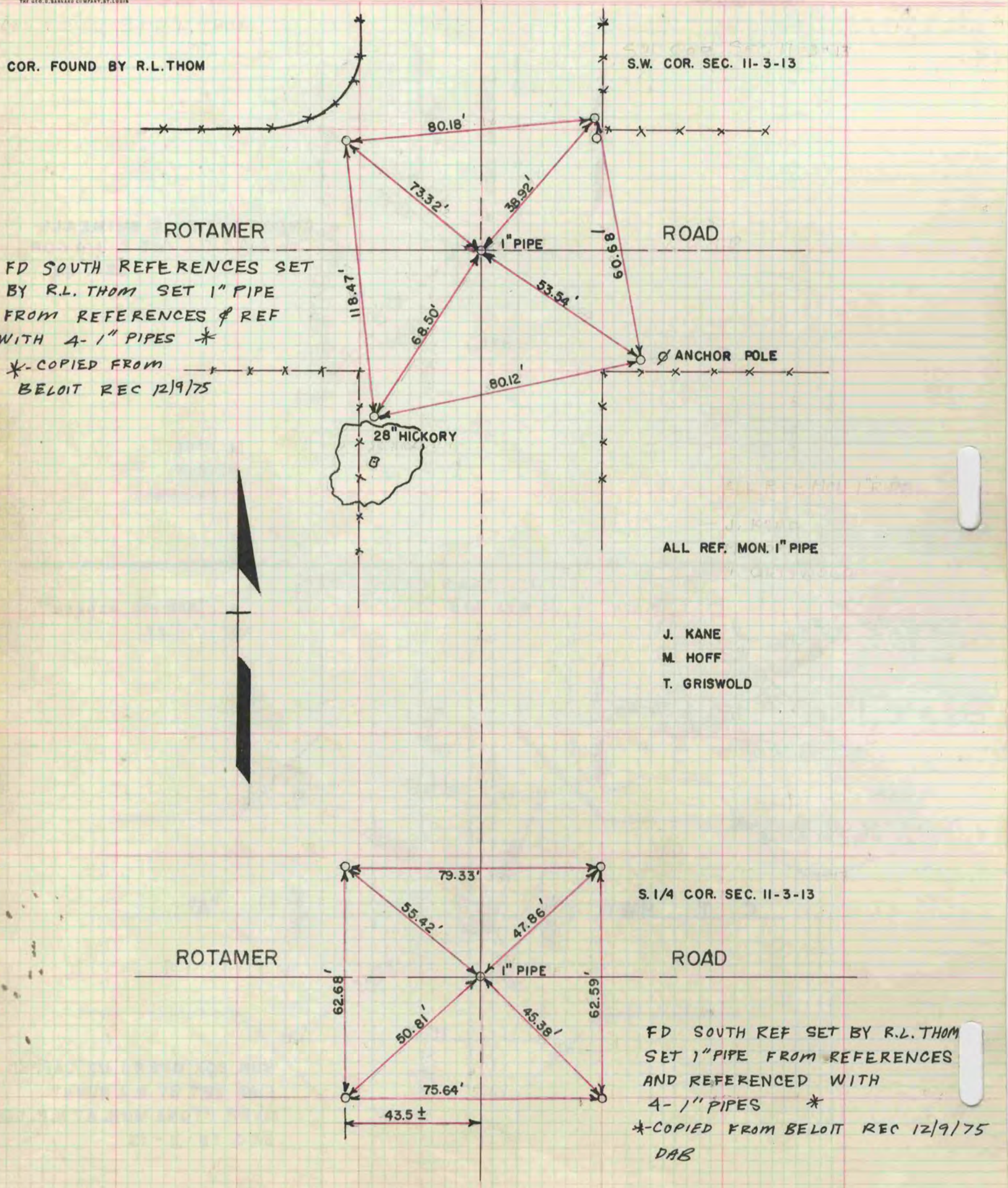

FD SOUTH REFERENCES SET BY R.L. THOM SET 1" PIPE FROM REFERENCES & REF WITH 4-1" PIPES *
*-COPIED FROM BELOIT REC 12/9/75

ALL REF. MON. 1" PIPE

- J. KANE
- M. HOFF
- T. GRISWOLD

S. 1/4 COR. SEC. 11-3-13

FD SOUTH REF SET BY R.L. THOM SET 1" PIPE FROM REFERENCES AND REFERENCED WITH 4-1" PIPES *
*-COPIED FROM BELOIT REC 12/9/75
DAB