

Of a Survey on Section **17, 8 T 2 R 11** E. of the 4 P. M. in **PLYMOUTH** Township  
Rock County, Wisconsin, made **DEC** the **1** 19**78**

I hereby certify that the following is a correct record of said survey as made by me.

*Donald Barnes*  
County Surveyor.

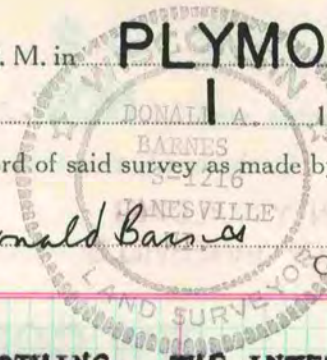

**SW COR SEC 17**

DUG AND FOUND NOTHING. THE INTERSECTION OF THE RECORD DISTANCES (LOCKE) FROM THE NORTH AND THE EAST IS IN THE BOTTOM OF A LARGE DRAINAGE DITCH. (EAST SIDE)

**W 1/4 COR SEC 17**

DUG & FD CUT LIMESTONE WITH I.P. ON EAST SIDE. REMOVED STONE & SET ALUM MON

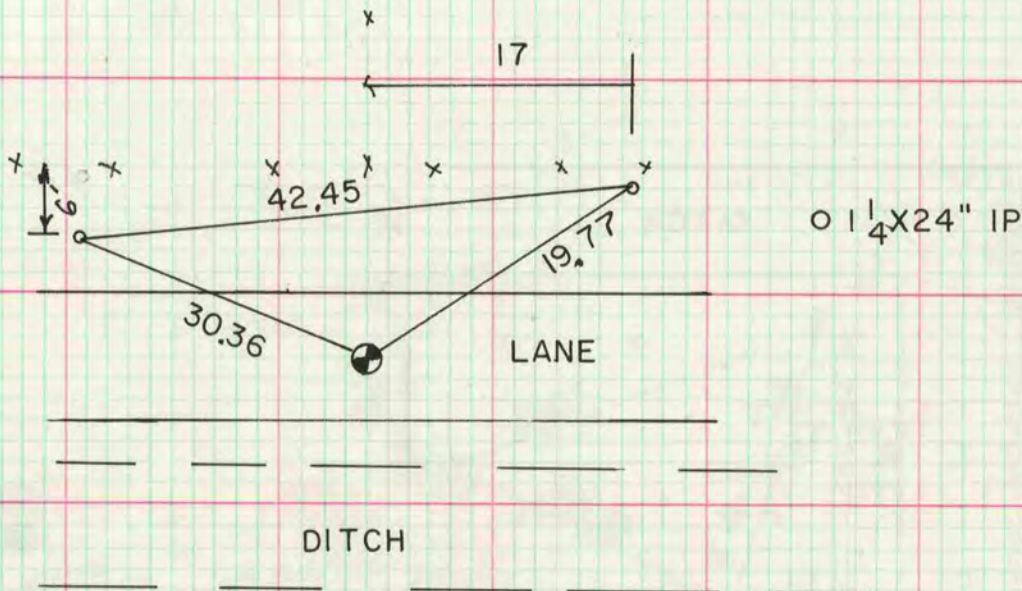

MICROFILMED

**SE COR SEC 8**

SET ALUM MON

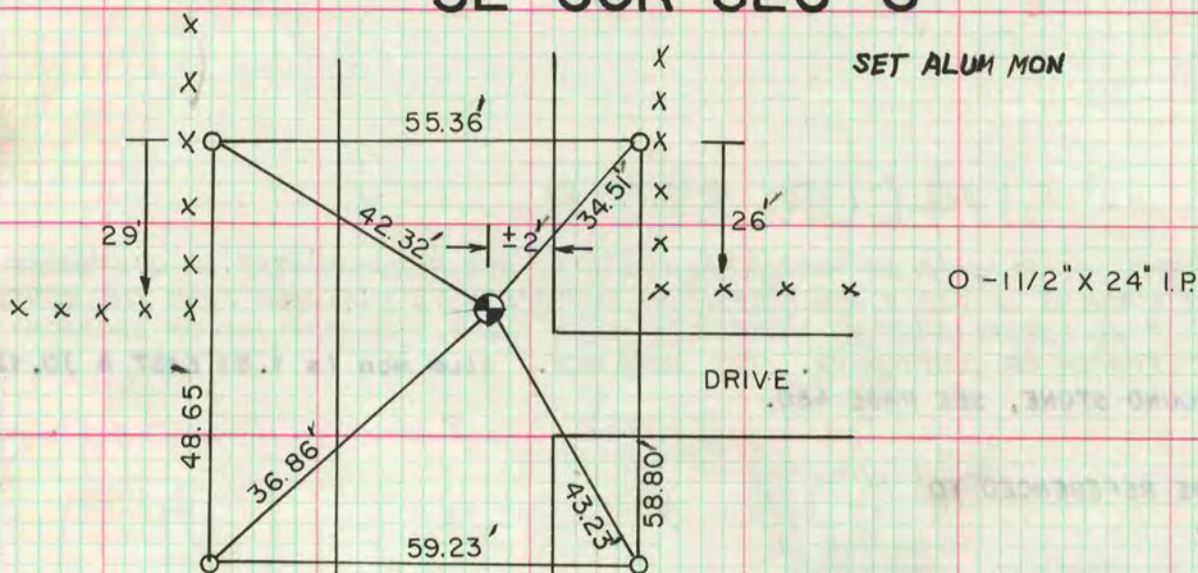

THE FORMER COUNTY SURVEYOR DUG AND FOUND NOTHING. THE CORNER WAS ESTABLISHED AT THE PRORATED DISTANCES FROM THE E 1/4 CORNER, OF SEC 8, THE E 1/4 COR OF SEC 17, THE SW COR OF SEC 8, AND THE S 1/4 COR OF SEC 9. THE DISTANCES WERE PRORATED WITH LOCKE'S 1868 REMONUMENTATION DISTANCES. THIS LOCATION IS ALSO IN HARMONY WITH EMMETT MURPHY'S STATEMENT "IN THE EARLY 1930s I LIVED AT THE FARM ADJACENT TO THE SECTION CORNER AND REMEMBER THE HIGHWAY DEPARTMENT REMOVING THE STONE DURING ROAD CONSTRUCTION, AS I RECALL THE STONE WAS ON LINE WITH THE FENCE TO THE EAST & ON THE EAST SIDE OF THE RD."

*Emmett W. Murphy*