

PLAT AND RECORD

VOL. 5

6,34 4 10
4 T 4 R 12

UNION

FULTON

Of a Survey on Section 4 Township 4 North Range 12 East of the 4 P. M. in

Rock County, Wisconsin, made MARCH the 10 19 78

I hereby certify that the following is a correct record of said survey as made by me.

COUNTY BUILDING
CITY OF JANESVILLE

Ronald Barnes
County Surveyor.

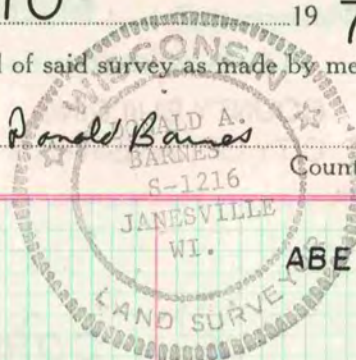

ABEX .LTD FB 510-78

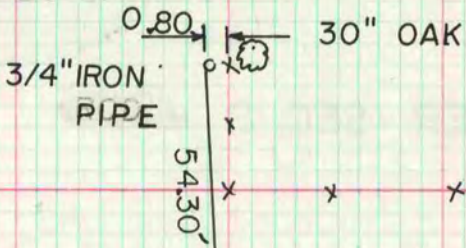

CTH "N"

SW CORNER SEC 33 ALBION TWP T5N R12E

RECEIVED THE INFORMATION FROM
GLEN NORTHROP S982

TWP	T	R	SEC	CORNER
UNION	4	10	34	W 1/4
UNION	4	10	6	SW & W 1/4

REMARKS

SET ALUMMON. FOUND
PK AS FOUND AND VERIFIED
1 YEAR AGO

FOUND PK AS PREVIOUSLY
SET. SET ALUM MON

MICROFILMED