

PLAT AND RECORD

479

VOL. 5

Of a Survey on Section 27 T 3 R 11 E. of the 4 P. M. in CENTER Township

Rock County, Wisconsin, made SEPTEMBER 5 1978

I hereby certify that the following is a correct record of said survey as made by me:

COUNTY BUILDING
CITY OF JANESVILLE

Donald Barnes

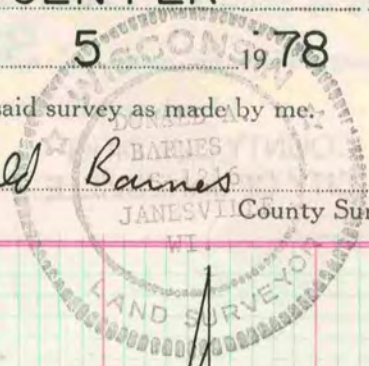

NW COR

2657.05'
2653.26'

EDM
LOCKE (1866)

W 1/4 COR

1333.55'
1331.06'

EDM
LOCKE (1866)

1/16th COR

EDM 1332.36'
LOCKE 1331.06'

DUG & FOUND H.H. SET 3/4" X 24" IP

SW COR

EDM 667.02'
LOCKE (1866) 666.19'

64th COR

DUG & FOUND LIMESTONE 20' X 8' X 5"
O HH ON N&S & LIMESTONE ON
E&W. SET 3/4" X 24" IP

DUG A HOLE 10 X 15 & 9' DEEP, FOUND
NOTHING. SET ALUM MON ON LINE
WITH THE 1/64th CORNERS & AT
PRORATED DISTANCE

EDM 1334.05'
LOCKE (1866) 1332.38'

64th COR

DUG & FOUND LIMESTONE 24" X 7' X 4"
O HH ON N&S & LIMESTONE ON
E&W SET 3/4" X 24" IP

S 1/4 COR

DUG A HOLE 8 X 6 & 3 DEEP,
FOUND NOTHING. SET ALUM MON
ON LINE WITH THE 1/64th CORNERS
& AT PRORATED DISTANCE.

SEC 27

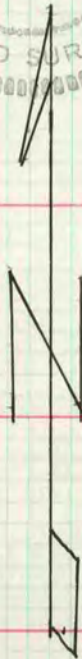

MICROFILM