

PLAT AND RECORD

COUNTY BUILDING
CITY OF JANESVILLE

VOL. 5

COUNTY OF JANESVILLE

Of a Survey on Section 33 T 1 R 13 E. of the 4 P. M. in TURTLE Township

Rock County, Wisconsin, made JULY 13 1978

I hereby certify that the following is a correct record of said survey as made by me.



County Surveyor.

S 1/4 COR SEC 33 T. 1 N. R. 13 E

DUG AND FD. NOTHING.

SET ALUM. MON. ON LINE

WITH CONCRETE MON. TO THE EAST AND THE SW COR SEC. 33

AND AT SINGLE PROPORTIONATE

DISTANCE FROM THE SW COR SEC. 33

AND THE S 1/4 COR, OF SEC. 36

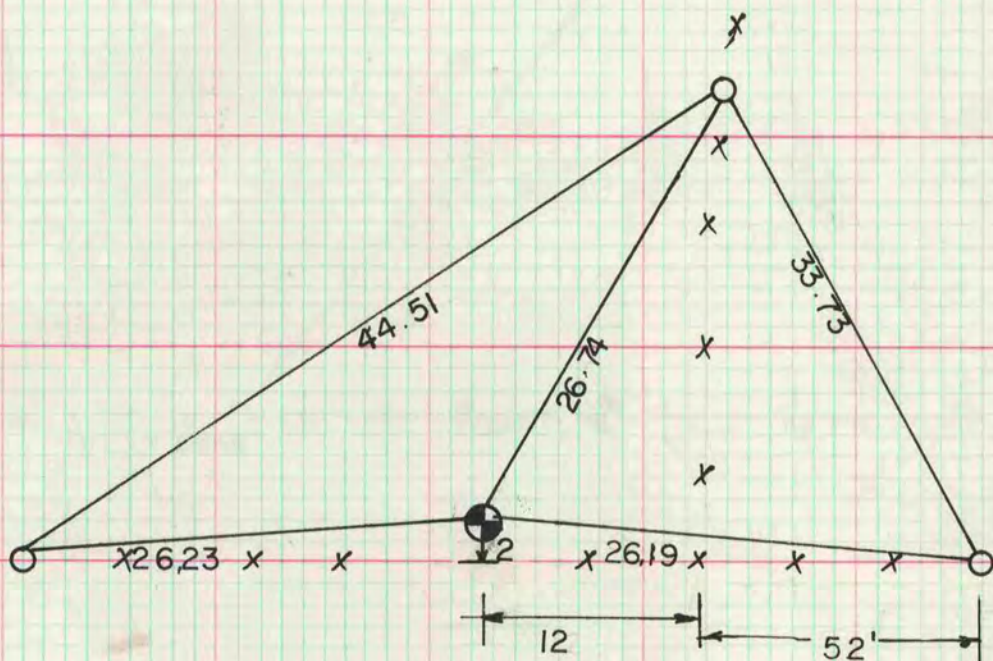
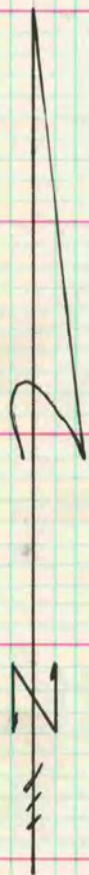

MICROFILMED

○ 1/4 x 24 IP