

U.S. PUBLIC LAND SURVEY MONUMENT RECORD

For Public Land Survey Corners in:

WI ADMINISTRATIVE CODE A-E 7.08 REQUIREMENT

T. 1 N., R. 10 E

CORNER CODE INDEX

A	1	2	3	4	5	6	7	8	9	10	11	12	13	14	15	16	17	18	19	20	21	22	23	24	25
B																									
C	6																								
D																									
E																									
F	1	8																							
G																									
H																									
J																									
K																									
L	18	17																							
M																									
N																									
O																									
P	19	20																							
Q																									
R																									
S																									
T	30	29																							
U																									
V																									
W																									
X	31	32																							
Y																									
Z																									

AVON TWP
ROCK COUNTY WI

IF AVAILABLE
ROCK COUNTY COORDINATES PREFERRED

North _____ Elev. _____

East _____

Hor. Datum _____ Vert. Datum _____

LATITUDE _____ ELLIPS. HT. _____

LONGITUDE _____

GPS (X) _____ TRAVERSE (X) _____

BASED ON THE FOLLOWING CONTROL:

PLACE MONUMENT SYMBOL \blacklozenge AT PROPER LOCATION ON ABOVE INDEX

\blacklozenge CORNER MONUMENT \circ WITNESS MONUMENT

(a)

1871 RUGER DROVE STAKE DEEP & \circ IT WITH 4 HH STONES

1939 SUNNY Fd HOLE DEEP DOWN WITH DECAYED STAKE IN IT. SET

2" x 40" PIPE FOR MON. SHOWS ON LINE WITH N/S FENCE LINE. REFERENCED TO 2 TREES & 1 FENCE POST

BEARINGS ARE BASED ON:

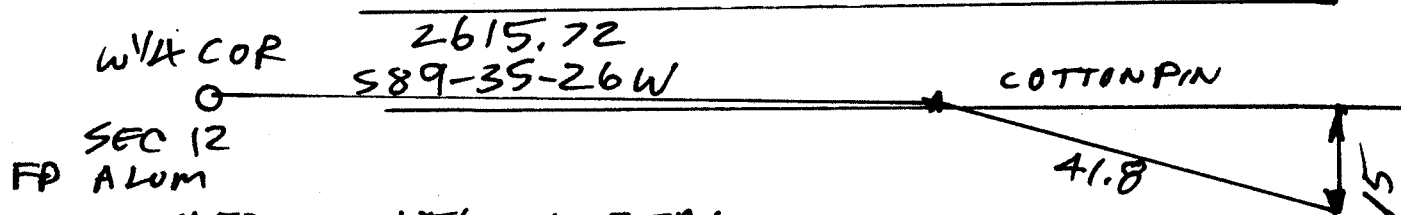

SEC 12
FP ALUM
SEARCHED WITH METAL LOCATOR & Fd NOTHING.

PIPE was probably DITCHED OUT

OBSERVATION SHEET 201 Donald Barnes
7-02-03 SHEET 1 OF 1

FIELD BOOK _____ PAGE # _____
SHOW A PLAN VIEW DRAWING DEPICTING THE CORNER MONUMENT AND SURROUNDING PHYSICAL FEATURES, INCLUDING THE EXCAVATION AREA AND DEPTH.
PLANNING & ZONING COMMITTEE ADOPTED THE ABOVE FORM ON 12/2/1982

CORNER CODE G-23(1)