

MICROFILMED

PLAT AND RECORD

79
V-1

COUNTY BUILDING
CITY OF JANESVILLE

Of a Survey on Section 16 T 3 R 11 E. of the 4 P. M. in Centre Township

Rock County, Wisconsin, made May the 28th 1858

I hereby certify that the following is a correct record of said survey as made by me.

(Signed) Joseph Church
R.H.B. County Surveyor.

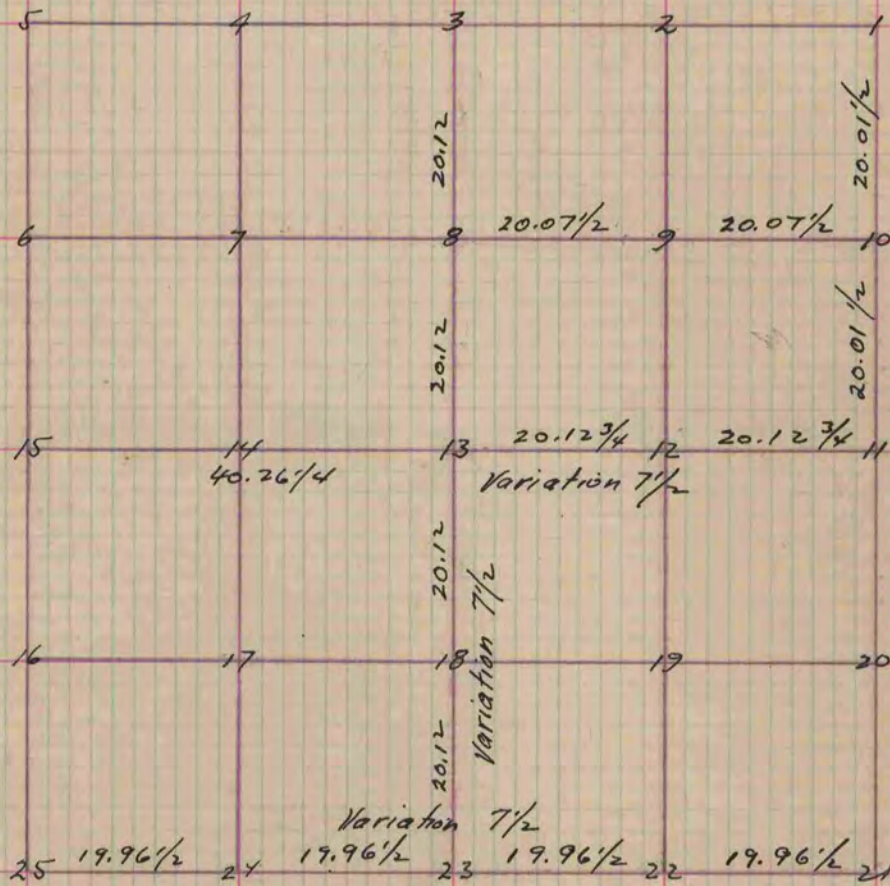

- Fig 13 Bl. O. 10 S. 41 W. 163
- Br. O. 4 N. 35 W. 142 1/2 Stone
- " 12 Stone no bearings on the ~~Prairie~~ Prairie
- " 18 Stone " " " " "
- " 8 Bl. O. 4 S. 85 1/2 E. 49
- " " 4 S 53 E 79 1/2 Stone
- " 11 Old trees gone took new ones Br. O. 8 S. 81 E 64 1/2
W. O. 6 N. 32 1/2 E 12
- " 3 Old trees gone " W. O. 18 N. 71 E. 170
" " 20 N 42 1/2 W 181
- " 10 Bl. O. 12 N. 89 1/2 W. 12 Stone
- Bl. O. 14 S 46 E 25
- " 9 Bl. O. 3 S 21 W 41 W. O. 2 S 48 W. 14 1/2 Stone

Copied from page 80 Vol. 1. Original County Surveyors Record