

U.S. PUBLIC LAND SURVEY MONUMENT RECORD

For Public Land Survey Corners in:

WI ADMINISTRATIVE CODE A-E 7.08 REQUIREMENT

T5 N., R. 14 E

CORNER CODE INDEX

A	1	2	3	4	5	6	7	8	9	10	11	12	13	14	15	16	17	18	19	20	21	22	23	24	25
B																									
C	6						5					A			3										1
D																									
E																									
F																									
G	1						8					9			10										12
H																									
J																									
K																									
L	18						17					16			15										13
M																									
N																									
O																									
P	19						20					21			22										24
Q																									
R																									
S	30						29					28			27										25
T																									
U																									
V																									
W																									
X	31						32					33			34										36
Y																									
Z																									

KOSHKONONG TWP

ROCK COUNTY WI

IF AVAILABLE
ROCK COUNTY COORDINATES PREFERRED

North _____ Elev. _____

East _____

Hor. Datum _____ Vert. Datum _____

LATITUDE _____ ELLIPS. HT. _____

LONGITUDE _____

GPS (X) _____ TRAVERSE (X) _____

BASED ON THE FOLLOWING CONTROL:

PLACE MONUMENT SYMBOL AT PROPER LOCATION ON ABOVE INDEX

CORNER MONUMENT WITNESS MONUMENT

BEARINGS ARE BASED ON:

FIELD BOOK _____ PAGE # _____

SHEET 1 OF 6

SHOW A PLAN VIEW DRAWING DEPICTING THE CORNER MONUMENT AND SURROUNDING PHYSICAL FEATURES, INCLUDING THE EXCAVATION AREA AND DEPTH.

PLANNING & ZONING COMMITTEE ADOPTED THE ABOVE FORM ON 12/2/1982

File in LIMA

CORNER CODE A 11/12

GOVERNMENT LAND CORNER RECORD*

JEFFERSON COUNTY

CORNER NO. 6301

TYPE OF MONUMENT Limestone
 STATE PLANE COORDINATES N.
E.
 ELEVATION M.S.L. DATUM: _____
 THETA ANGLE _____
 FIELD BOOK Koshkonong p. 15
 DRAWN BY TRW

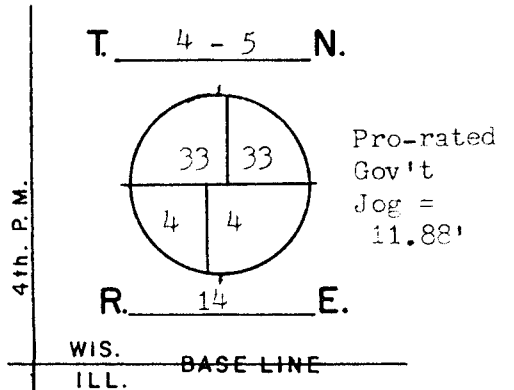

BASIS FOR MONUMENTATION

Original Survey, 1834-37, Wood Post & Bearing Trees Resurvey of Koshkonong Township, by Milo C. Jones, August-December, 1886. Field notes say that Bearing Tree evidence was found. From this evidence a Limestone monument, Approx. 6" by 36" long with a squared finished top, was set for the corner. Notes are recorded in the Register of Deeds, Miscellaneous Volume 1, pages 389-412.

1980, Found the stone monument, set for Koshkonong Township, extending about 4" out of ground in a fence intersection. I set a steel post and sign next to the stone. Lima Township in Rock County, was not Resurveyed.

SEAL:

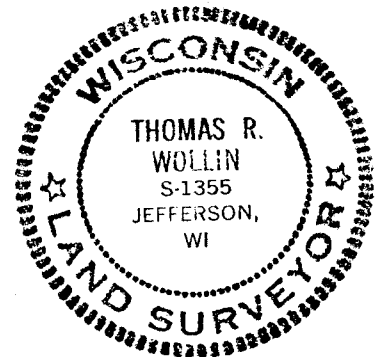

DATA SHOWN HERE ON CERTIFIED CORRECT:

Thomas R. Wollin
 REGISTERED LAND SURVEYOR

DATED 4/21/1982

LOCATION SKETCH

- SQUARE CUT LIMESTONE 6" by 36"
- CONCRETE / BRASS CAP
- ALUMINUM MAGNETIZED
- IRON PIPE
- RR SPIKE
- PK NAIL
- FENCE
- UTILITY POLE
- STEEL POST / SIGN

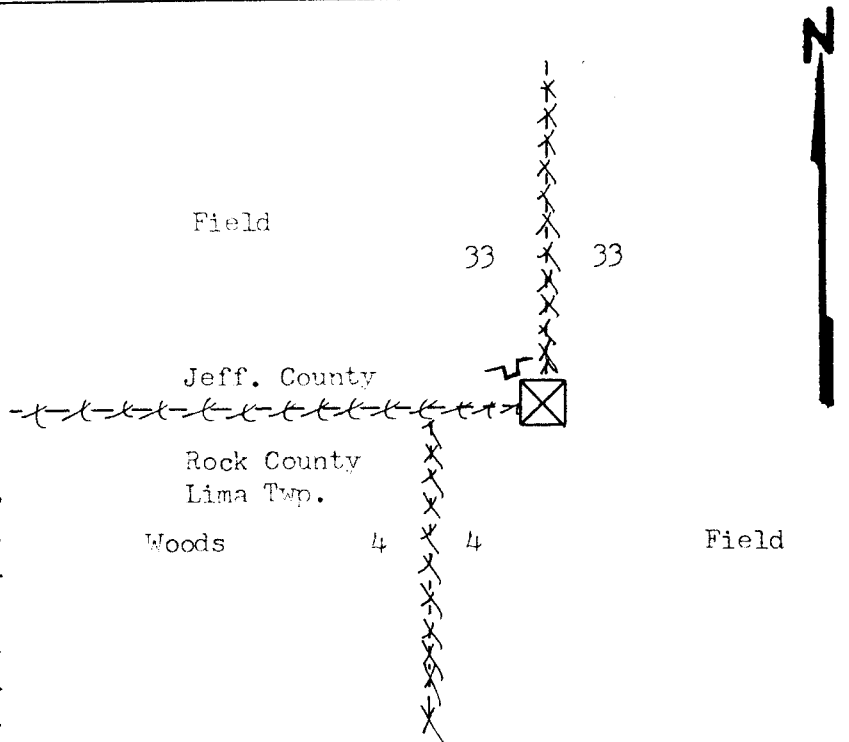

MAINTENANCE RECORD

DATE	INIT.	REMARKS

A-11/12