

# PLAT AND RECORD

**MICROFILMED**

Of a Survey on Section 36 T 3 R 13 E. of the 4 P. M. in Harmony Township  
Rock County, Wisconsin, made May the 30<sup>th</sup> 1860

I hereby certify that the following is a correct record of said survey as made by me.

COUNTY BUILDING  
CITY OF JANESVILLE

(Signed) Edward Ruger  
R.H.B. County Surveyor.

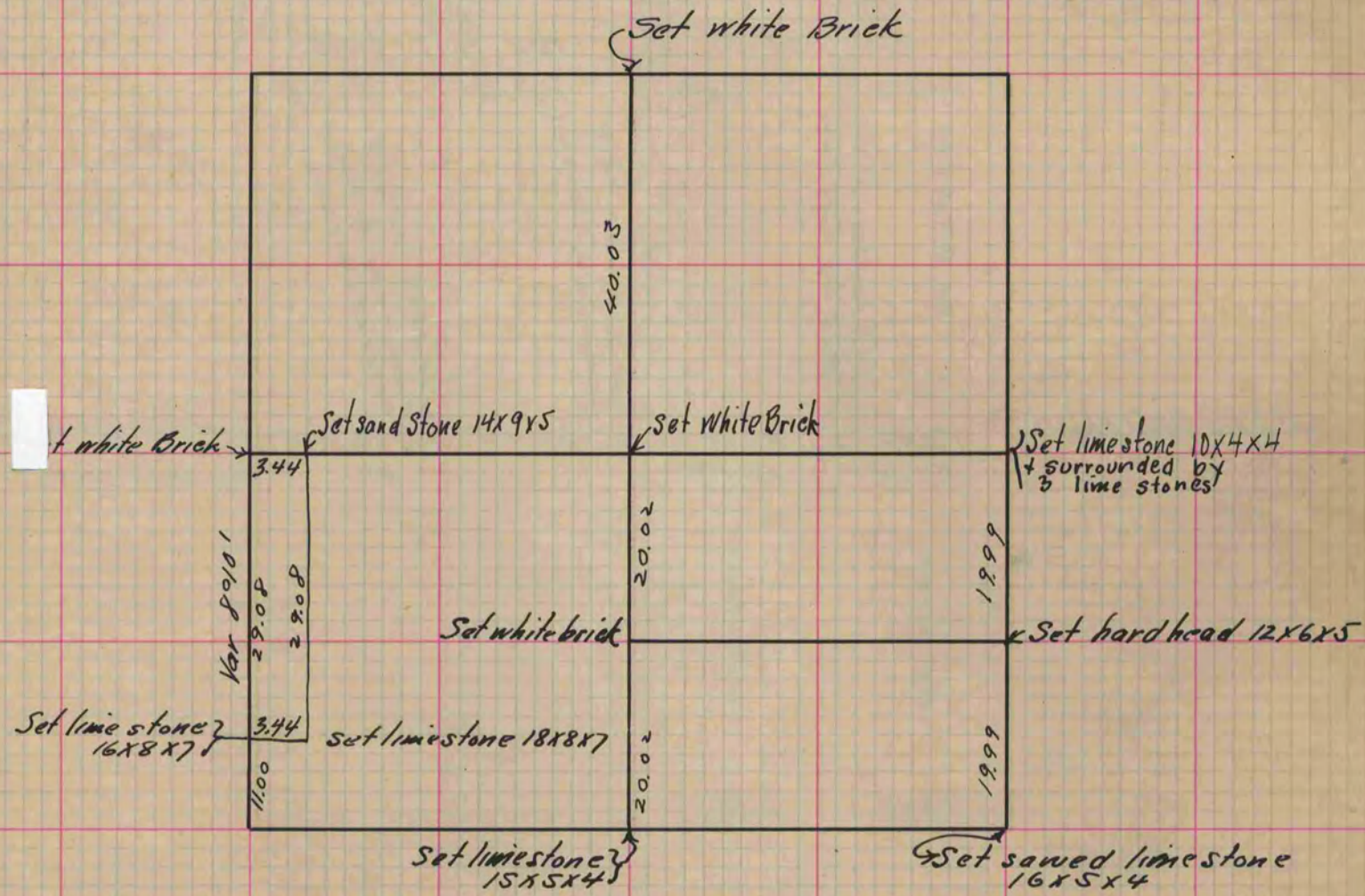

Copied From Page 144 Vol. 1. Original County Surveyors Record