

PLAT AND RECORD

VOL. 6

Of a Survey on Section 33 T 2 R 14 E. of the 4 P. M. in BRADFORD Township

Rock County, Wisconsin, made AUG. the

I hereby certify that the following is a correct record of said survey made by me

COUNTY OF DING
CITY OF JANESVILLE

Donald A. Barnes



County Surveyor.

CENTER COR SEC 33

FD NAIL IN SURFACE OF PVMT

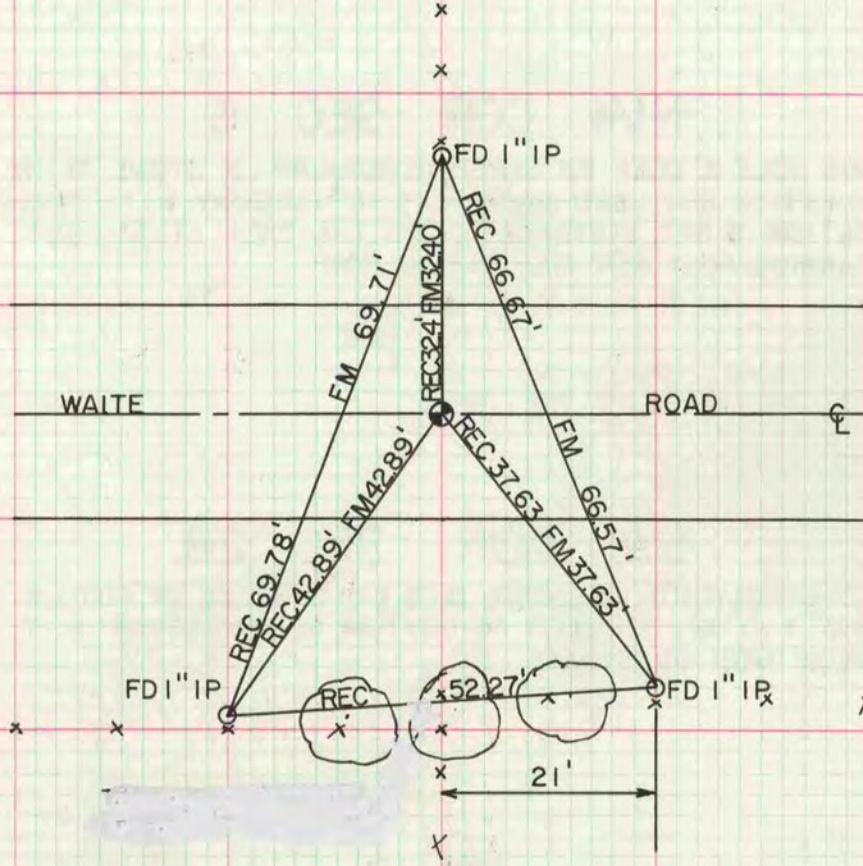

W 1/4 COR SEC 33

FD MON BOX W/LIGHTNING ROD SW OF RD INT

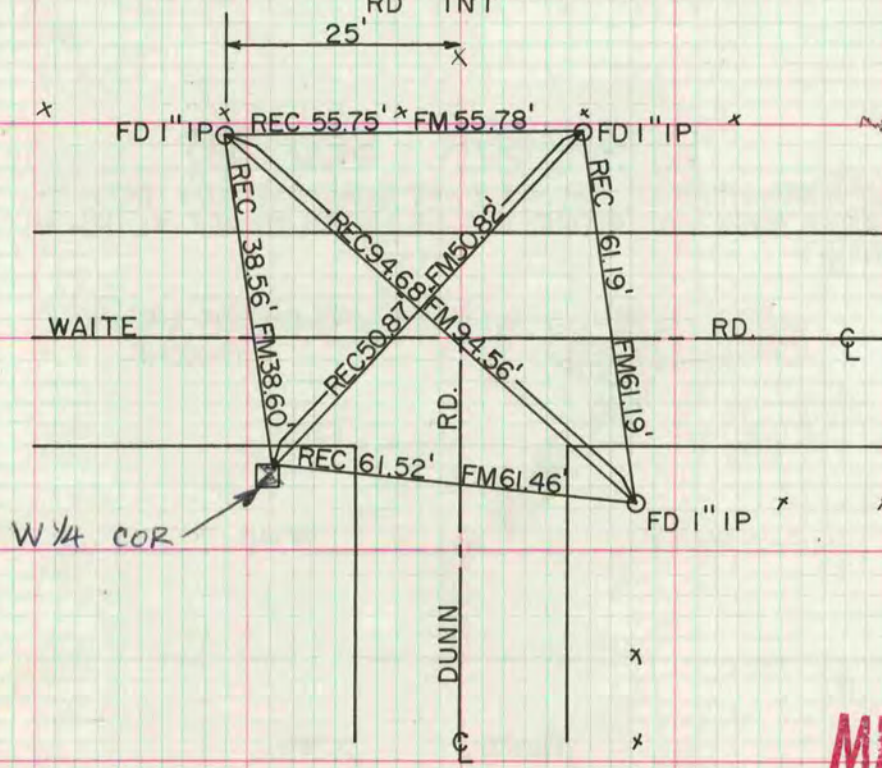

MICROFILMED