

# PLAT AND RECORD

529

VOL. 5

Of a Survey on Section 5 T 4 R 12 E. of the 4 P. M. in FULTON Township

Rock County, Wisconsin, made MARCH the 1979

I hereby certify that the following is a correct record of said survey as made by me.

COUNTY BUILDING  
CITY OF JANESVILLE

County Surveyor.

## N 1/4 COR SEC 5

MICROFILMED

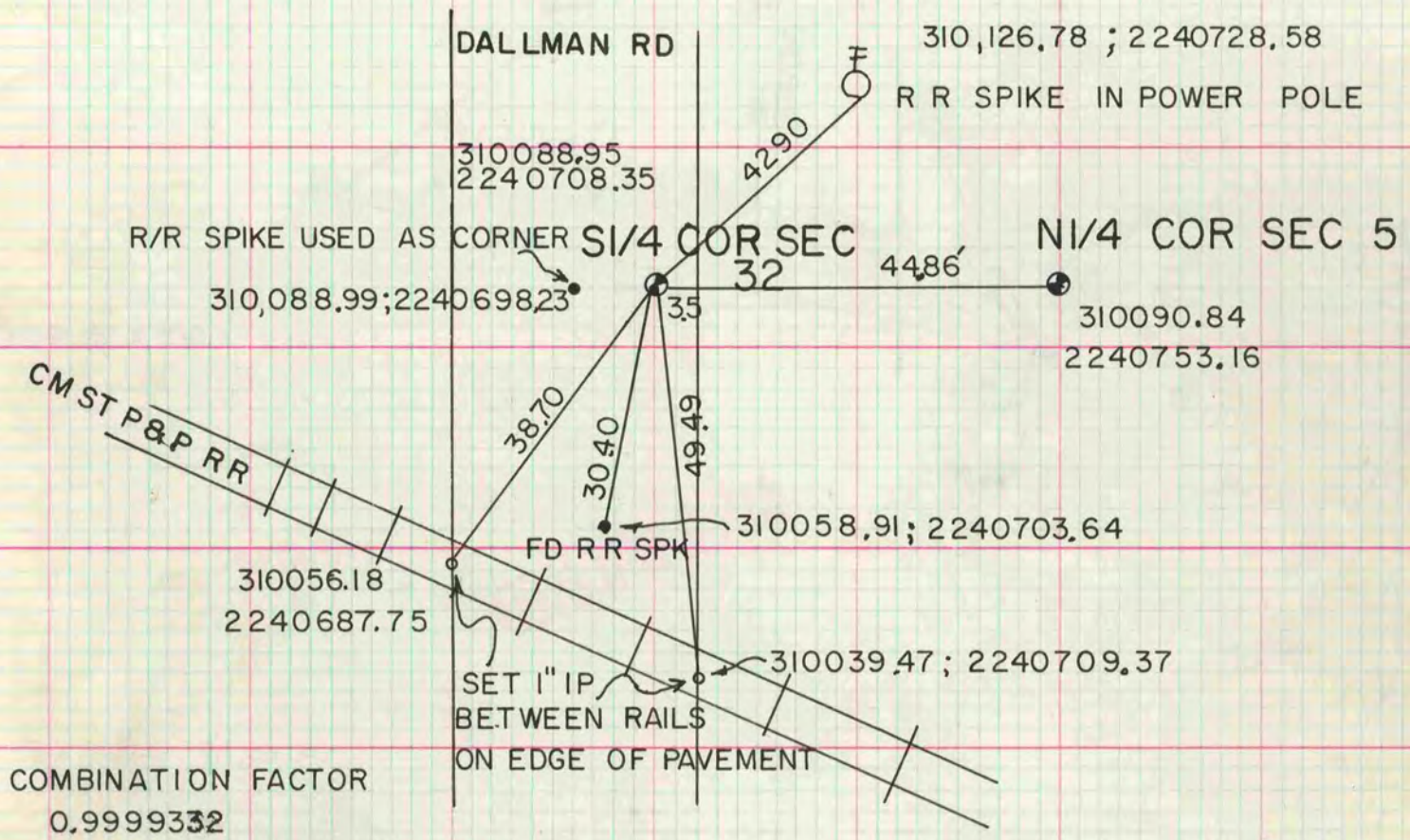

I DUG & FOUND CONCRETE MONUMENT SET ALUM MON TO SURFACE  
ABOVE FOUND CONCRETE MON. ORIGIN OF CONCRETE MON HINTZ RESURVEY  
TOWN OF ALBION, DATED 1911, RECORDED IN VOL 5 PAGE 78 & 7 A. OF PLATS

ARDEN SANDSNES S812 MARCH 1979