

PLAT AND RECORD

Of a Survey on Section 35 T 4 R 14 E. of the 4 P. M. in Clinton Township

Rock County, Wisconsin, made June the 27th & 28th 1881

I hereby certify that the following is a correct record of said survey as made by me.

COUNTY BUILDING
CITY OF JANESVILLE

(Signed) R. K. Lee
R. H. B.

County Surveyor.

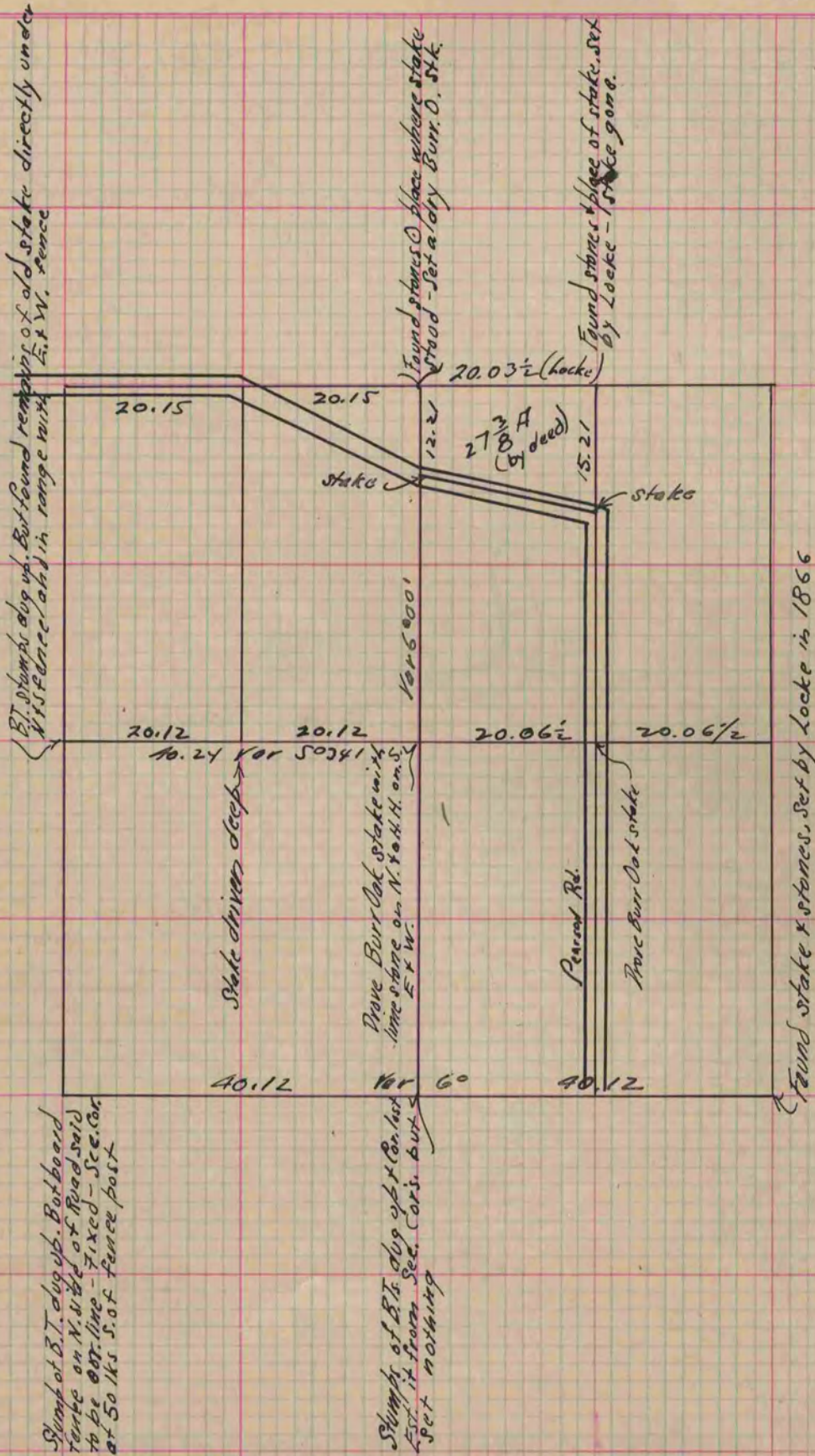

Copied from P. 268 Vol. 2. County Surveyors Record.