

232
VOL. 6

PLAT AND RECORD

33 4 14
4 3 14

LIMA
JOHNSTOWN

Of a Survey on Section T R E. of the 4 P. M. in Township

Rock County, Wisconsin, made..... the.....

I hereby certify that the following is a correct record of said survey as made by me.....

COUNTY BUILDING
CITY OF JANESVILLE

Donald A. Barnes

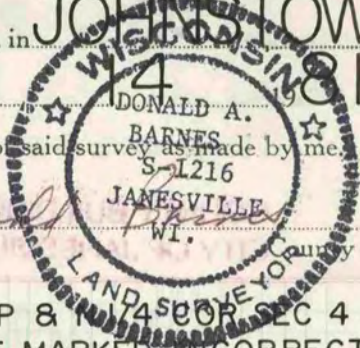

County Surveyor.

THE S 1/4 COR SEC 33 LIMA TWP & N 1/4 COR SEC 4 JOHNSTOWN
AS SHOWN ON VOL 4 PG 463 ARE MARKED INCORRECTLY.
VOL 6 PG 63 IS CORRECTLY MARKED.