

93
V-1

PLAT AND RECORD

MICROFILMED

Of a Survey on Section 1 T 1 R 13 E. of the 4 P. M. in Turtle Township

Rock County, Wisconsin, made February the 24th 1859

I hereby certify that the following is a correct record of said survey as made by me.

COUNTY BUILDING
CITY OF JANESVILLE

(Signed) Edward Roger
R.H.B. County Surveyor.

For Swingle

*Distances given in chains
variations marked on the lines*

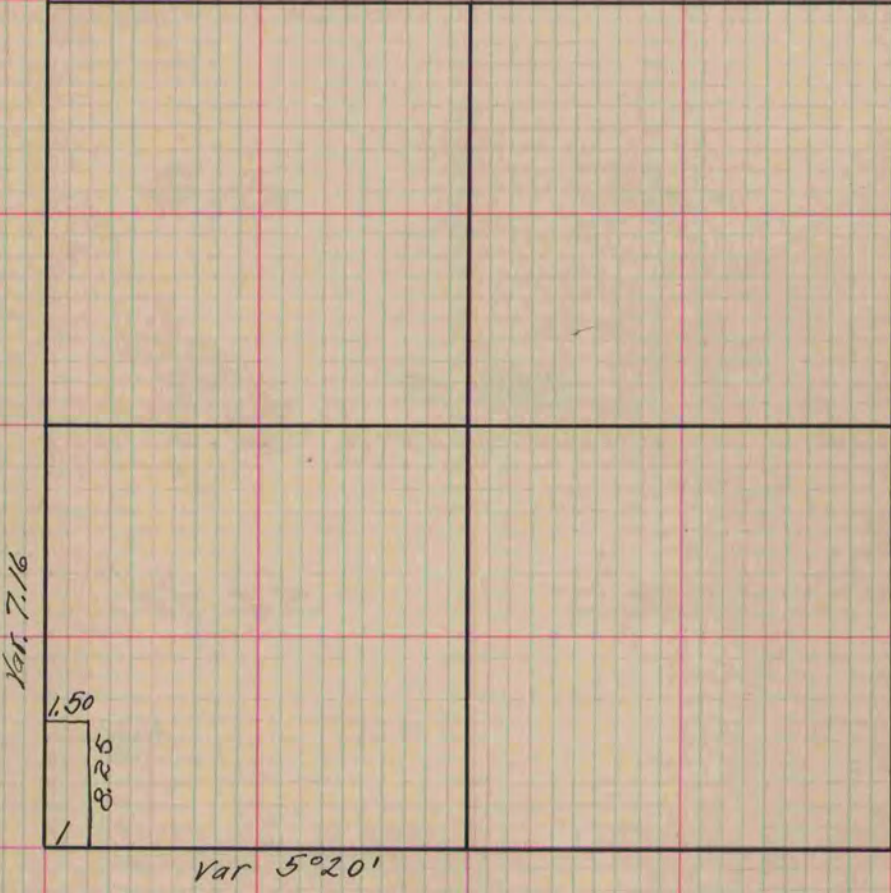

Copied from Page 101 Vol. 1. Original County Surveyors Record