

PLAT AND RECORD

PG 145 BELOIT REC

12/8/75 DAB

COUNTY BUILDING
CITY OF JANESVILLE

Of a Survey on Section 21 - 28 T 4N R 11 E. of the 4 P. M. in PORTER Township

Rock County, Wisconsin, made JUNE the 3.RD. 1963

MICROFILMED

I hereby certify that the following is a correct record of said survey as made by me.

R. B. Stumpf

County Surveyor.

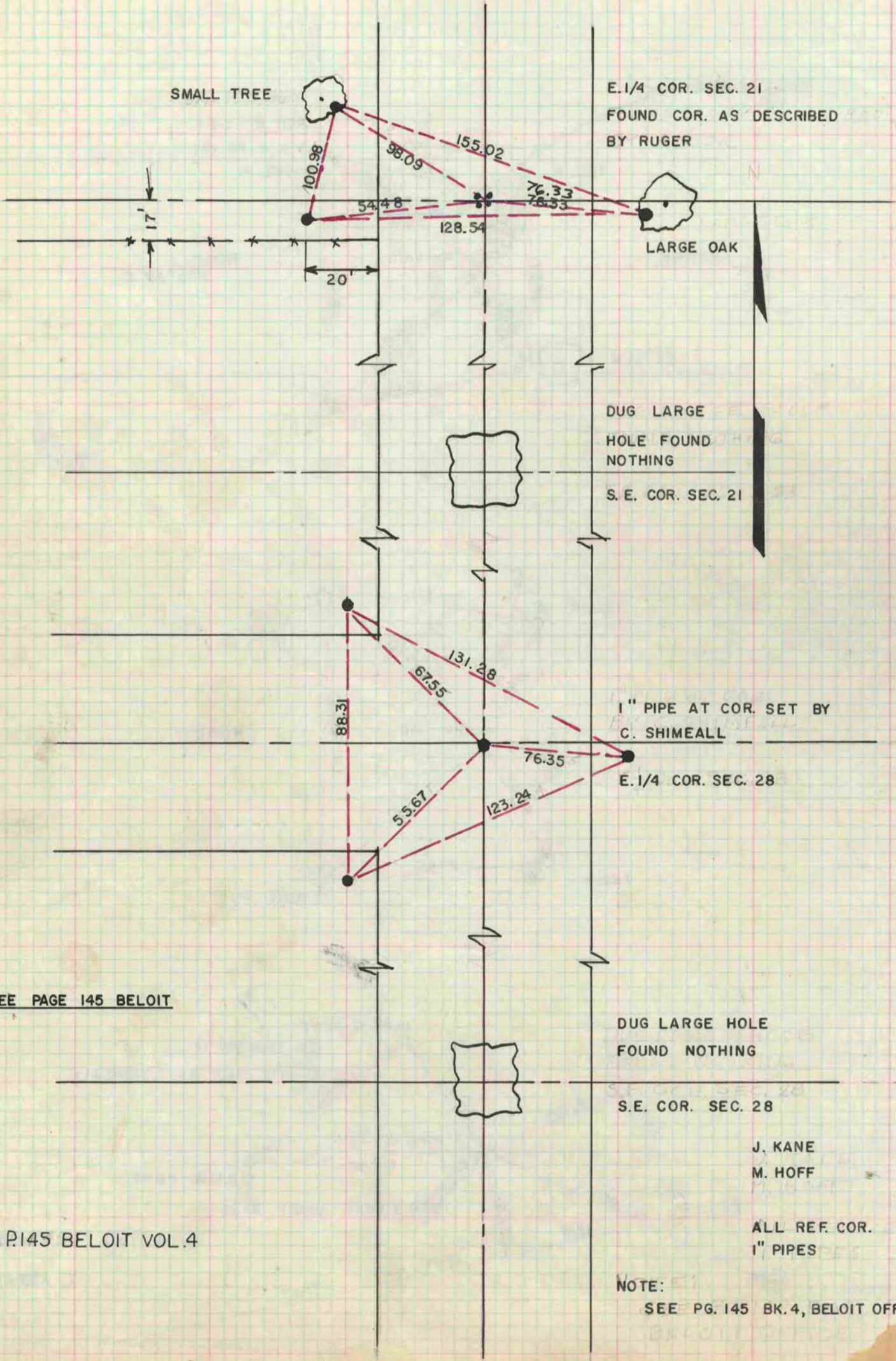

SEE PAGE 145 BELOIT

P145 BELOIT VOL.4

J. KANE
M. HOFF

ALL REF. COR.
1" PIPES

NOTE:
SEE PG. 145 BK. 4, BELOIT OFFICE