

COUNTY BUILDING  
CITY OF JANESVILLE

# PLAT AND RECORD

7  
VOL. 6

Of a Survey on Section **7** T **2** R **11** E. of the 4 P. M. in **PLYMOUTH** Township  
Rock County, Wisconsin, made **NOV** the **10** **1979**

I hereby certify that the following is a correct record of said survey as made by

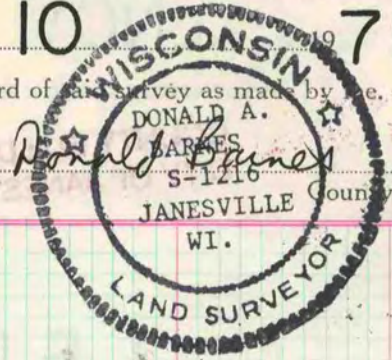

## S 1/4 COR SEC 7

DUG & FOUND NOTHING, THE CORNER WAS PROBABLY DESTROYED BY DITCHING. SET ALUM MON ON LINE WITH THE NW & NE CORNERS & SINGLE PROPORTIONATE MEASUREMENT WITH LOCKS DISTANCES.

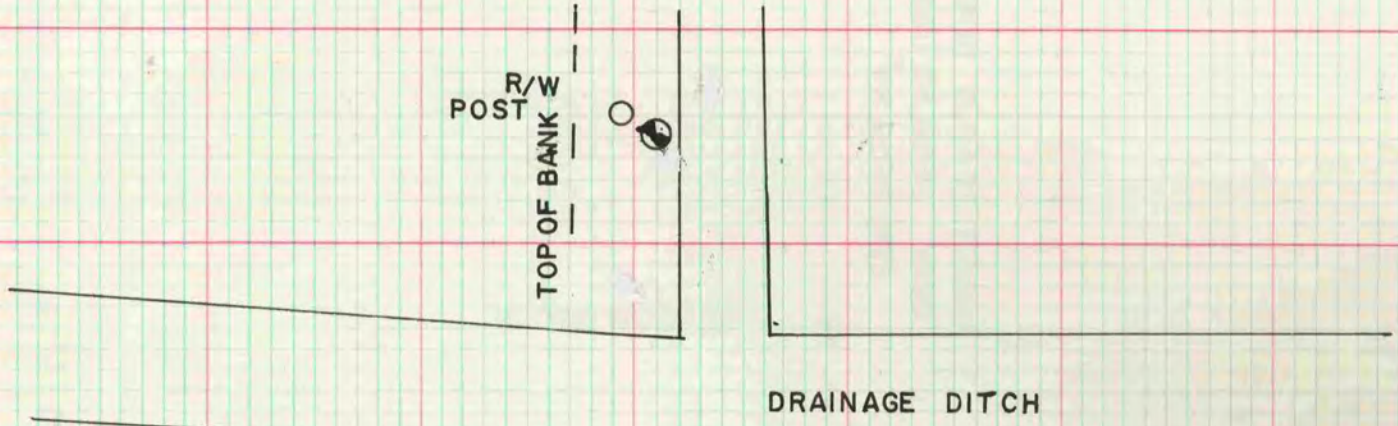

## NW COR SEC 7

DUG 5' DEEP & FD NOTHING

MICROFILMED

