

PLAT AND RECORD

VOL. 6

Of a Survey on Section 16, 21, 3, 12 E. of the 4 P. M. Township

Rock County, Wisconsin, made MARCH 11 1981 the

I hereby certify that the following is a correct record of said survey as made by me.

COUNTY BUILDING
CITY OF JANESVILLE

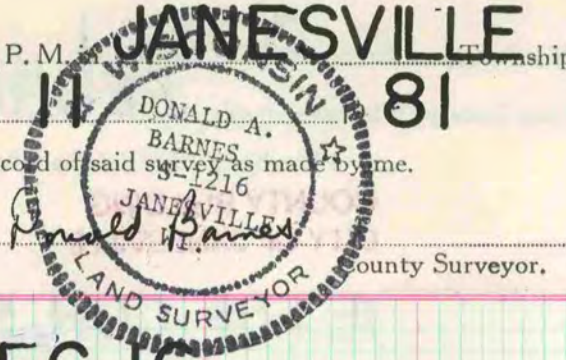

E 1/4 COR SEC 16

DUG & FOUND NOTHING. RE-ROD SET BY RICHARD THOM AT FENCE INTERSECTION IS IN HARMONY WITH RECORD DISTANCES. REPLACED RE-ROD WITH ALUM MON

W 1/4 COR SEC 16

FOUND 1"X6" IP . REPLACED WITH ALUM MON

MICROFILMED

NE COR SEC 21

DUG AND FOUND NOTHING. RE-ROD SET BY RICHARD THOM AT FENCE INTERSECTION IS IN HARMONY WITH RECORD DISTANCES. REPLACED RE-ROD WITH ALUM MON.

W 1/4 COR SEC 21

FD 1" IP IN CENTER OF RD DROVE DEEP & SET ALUM MON ON TOP.

NW COR SEC 21

FD 1" IP DROVE DEEP & SET ALUM MON

