

Of a Survey on Section 8 T 3 R 10 E. of the 4 P. M. in MAGNOLIA Township
Rock County, Wisconsin, made MARCH the 9 1978

I hereby certify that the following is a correct record of said survey as made by me.

Donald Barnes
County Surveyor.



SW CORNER SEC 8

FOUND LIMESTONE 16"X5"X20" WITH POINT UP.
SET ALUM MON.

o 1" X 24" IP

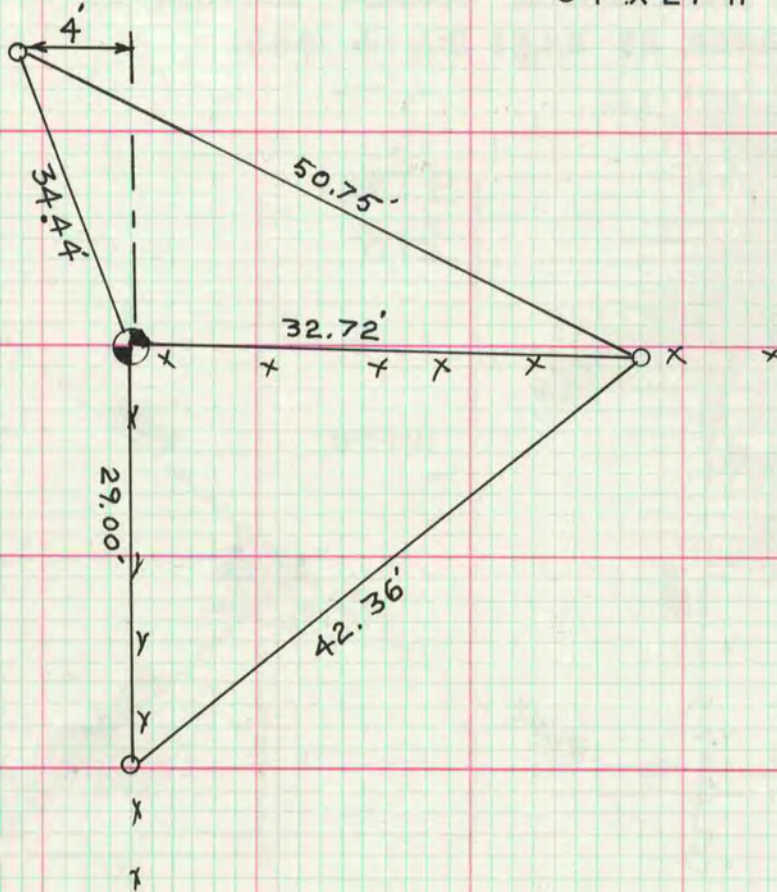

MICROFILMED

N 1/4 CORNER SEC 8

FOUND 1 1/4" X 18" IRON ROD. SET ALUM MON

