

PLAT AND RECORD VOL. 5

357

CITY OF JANESVILLE

Of a Survey on Section 12 T. 2 R. 14 E. of the 4 P. M. in Bradford Township

Rock County, Wisconsin, made October 21 1977

I hereby certify that the following is a correct record of said survey as made by me.

COUNTY BUILDING 1
CITY OF JANESVILLE



SE. COR. SEC. 12 T. 2 R. 14 E.

FD. CONC. MON. WITH BRASS DISC STAMPED WI. DEPT. OF TRANS.

- 1" X 24" I.P.
- FD. I.P.

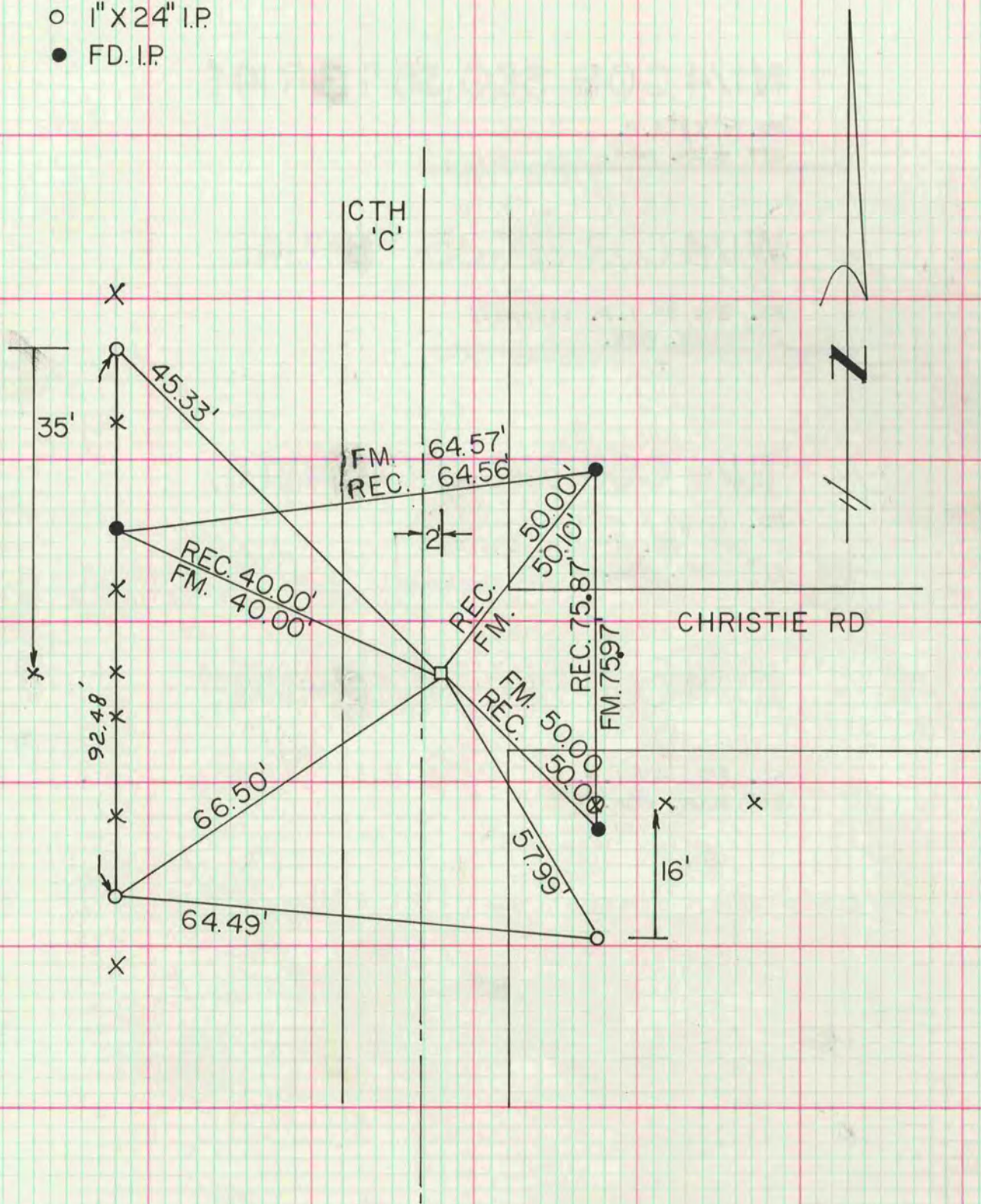

MICROFILMED