

V-1 MICROFILMED

PLAT AND RECORD

Of a Survey on Section 35 T 3 R 10 E. of the 4 P. M. in Magnolia Township

Rock County, Wisconsin, made September the 2nd 1858

I hereby certify that the following is a correct record of said survey as made by me.

COUNTY BUILDING
CITY OF JANESVILLE

(Signed) Joseph Church
R.H.B.

County Surveyor.

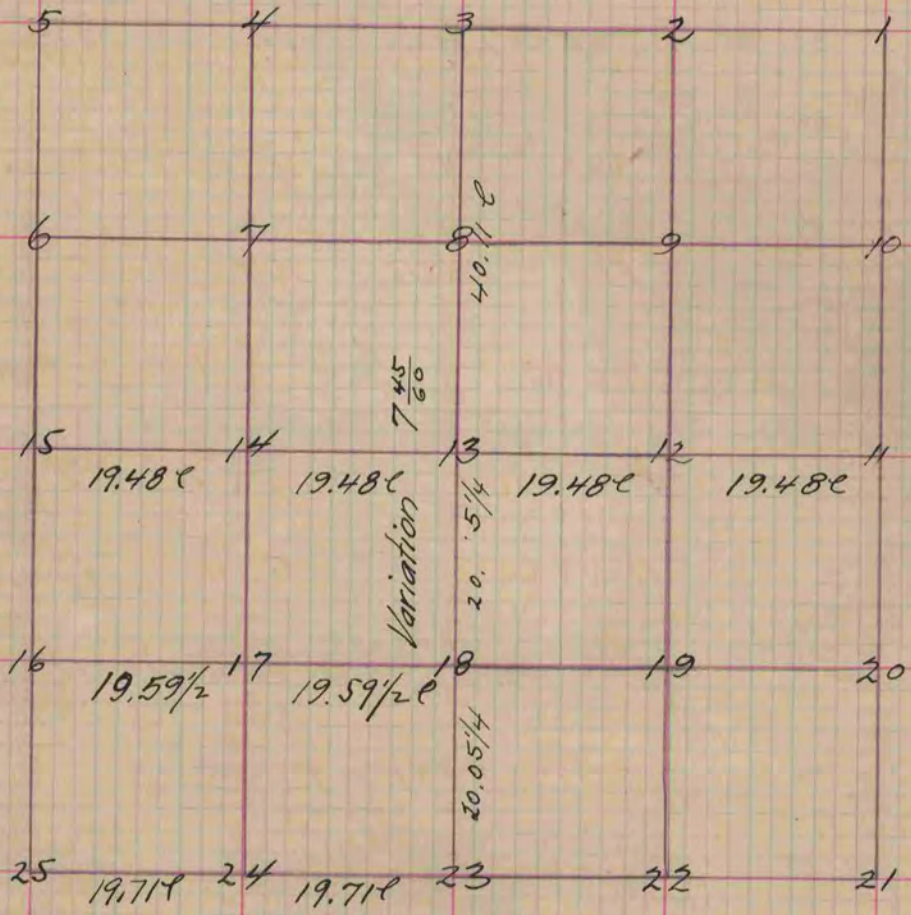

Fig. 13 Stake on the Prairie no bearings
 " 18 " " " " " "
 " 17 " " " " " "
 " 24 " " " " " "

Copied from Page 85 Vol. One Original County Surveyors Record