

MICROFILMED

PLAT AND RECORD

Of a Survey on Section 10 T 2 R 11 E. of the 4 P. M. in Plymouth Township
Rock County, Wisconsin, made June the 4th 1855

I hereby certify that the following is a correct record of said survey as made by me.

COUNTY BUILDING
CITY OF JANESVILLE

(Signed) Joseph Church
R.H.B. County Surveyor.

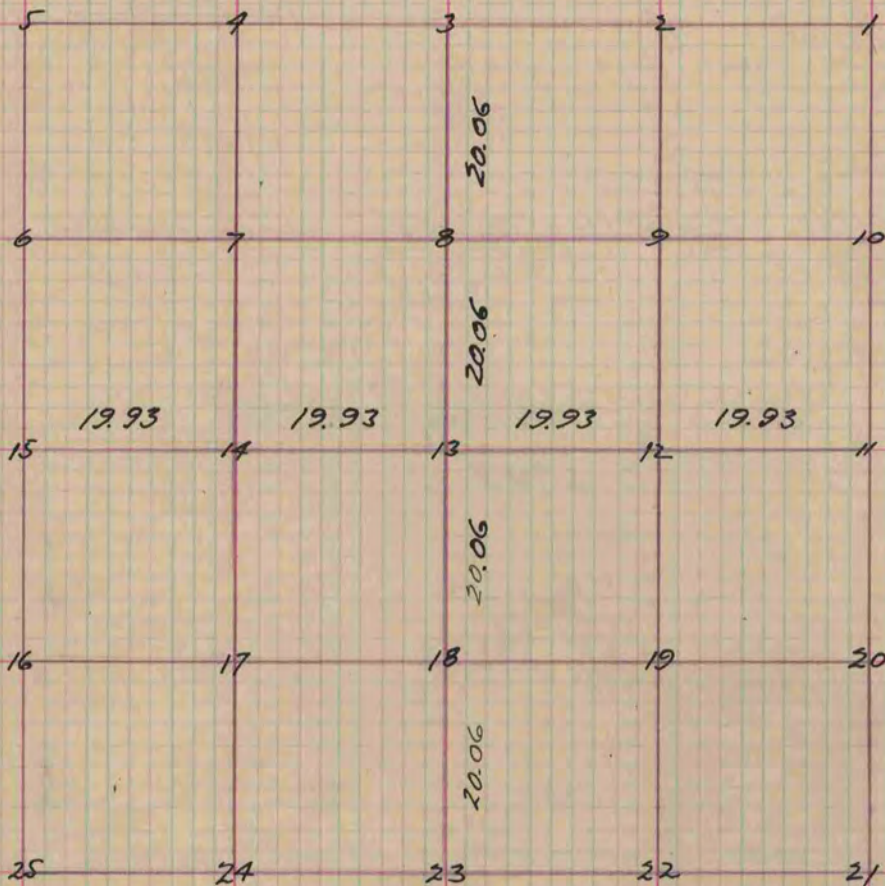

- Fig. 15 W.O. 24 S. 63 W. 270 links
Bur. O. 20. S. 85 E. 163
- 13 Stake no bearings
- 10 Stake " "
- 8 " " "

Copied from Page 41 Vol. 1 Original County Surveyors Record