

MICROFILMED PLAT AND RECORD

73
V-1

COUNTY BUILDING
CITY OF JANESVILLE

Of a Survey on Section 16 T 2 R 10 E. of the 4 P. M. in Spring Valley Township
Rock County, Wisconsin, made April the 3rd 1857

I hereby certify that the following is a correct record of said survey as made by me.

(Signed) Joseph Church by Chas. H. Brown
R.H.B. Deputy County Surveyor.

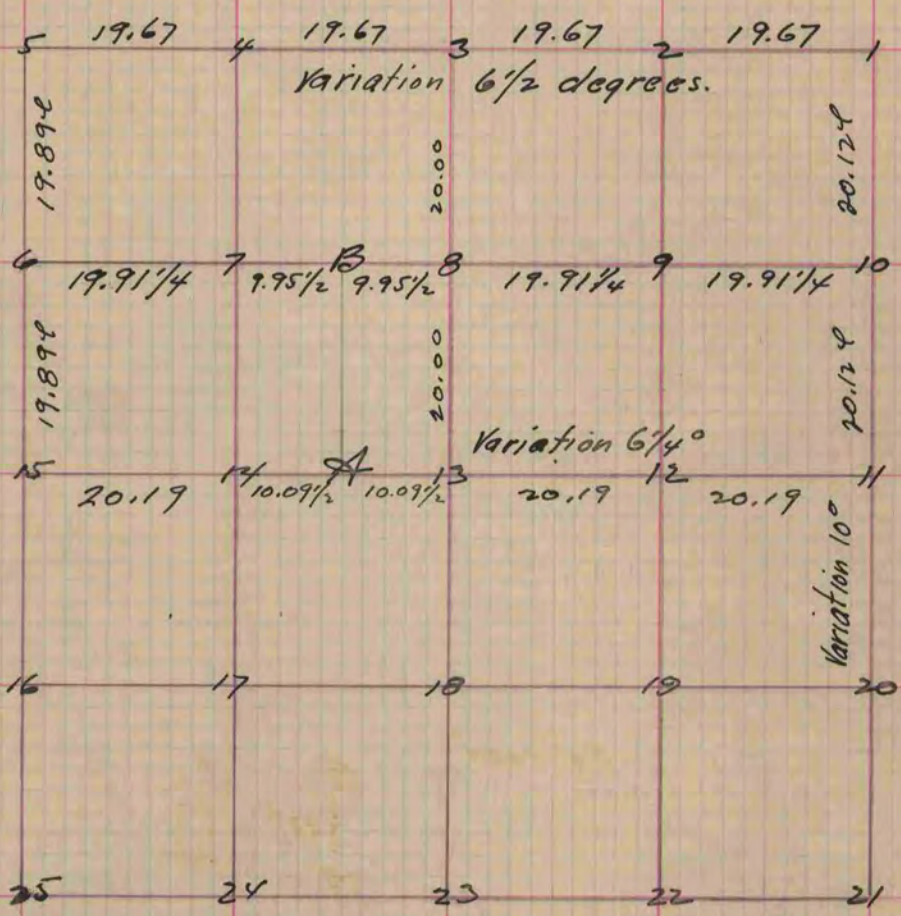

- | | | | |
|--------|-------------------------|------------|--------------------------|
| Fig. 3 | Br. O. 14 S 4 1/2 E 511 | Fig. 6 | Br. O. 12 N 24 E 206 |
| " 7 | 4 N 32 1/2 W. 330 | | 10 N 16 1/2 E 203 |
| " 8 | 12 S. 12 E 670 | Letter A | Br. O. 10 S 26 1/2 W 126 |
| " 9 | 14 S. 6 1/2 E. 673 | | Stump S. 179 |
| 12 | 12 S. 8 1/2 E 359 1/2 | " B. Y. O. | 10. N. 13 E. 5.15 |
| " 13 | 5 S 5 1/2 E 241 | | 12 N 31 1/4 E. 554 |
| " 14 | 10 S. 10 W. 240 | | |
| | 12 S 13 1/2 W. 291 | | |
| | 10 N 9 1/2 W. 60 | | |
| | Stump N 59 1/2 E 90 | | |
| | Y. O. 11 S. 75 E 261 | | |
| | Br. O 6 N 68 1/2 E 150 | | |
| | Stake no bearing | | |

Copied from Page 74 Vol. 1. Original County Surveyors Record