

PLAT AND RECORD

VOL. 6

35

JOHNSTOWN  
BRADFORD

Of a Survey on Section 11, 14, 15 T 2 R 14 E. of the 4 P. M. in Township

Rock County, Wisconsin, made MARCH the

25 1981  
DONALD A. BARNES  
JANESVILLE  
WI.  
County Surveyor.

I hereby certify that the following is a correct record of said survey as made by me.

COUNTY BUILDING  
CITY OF JANESVILLE

S 1/4 COR SEC 35  
JOHNSTOWN TWP

REMOVED STONE OF RECORD & SET ALUM MON 4' WEST  
OF CENTERLINE OF PAVEMENT.

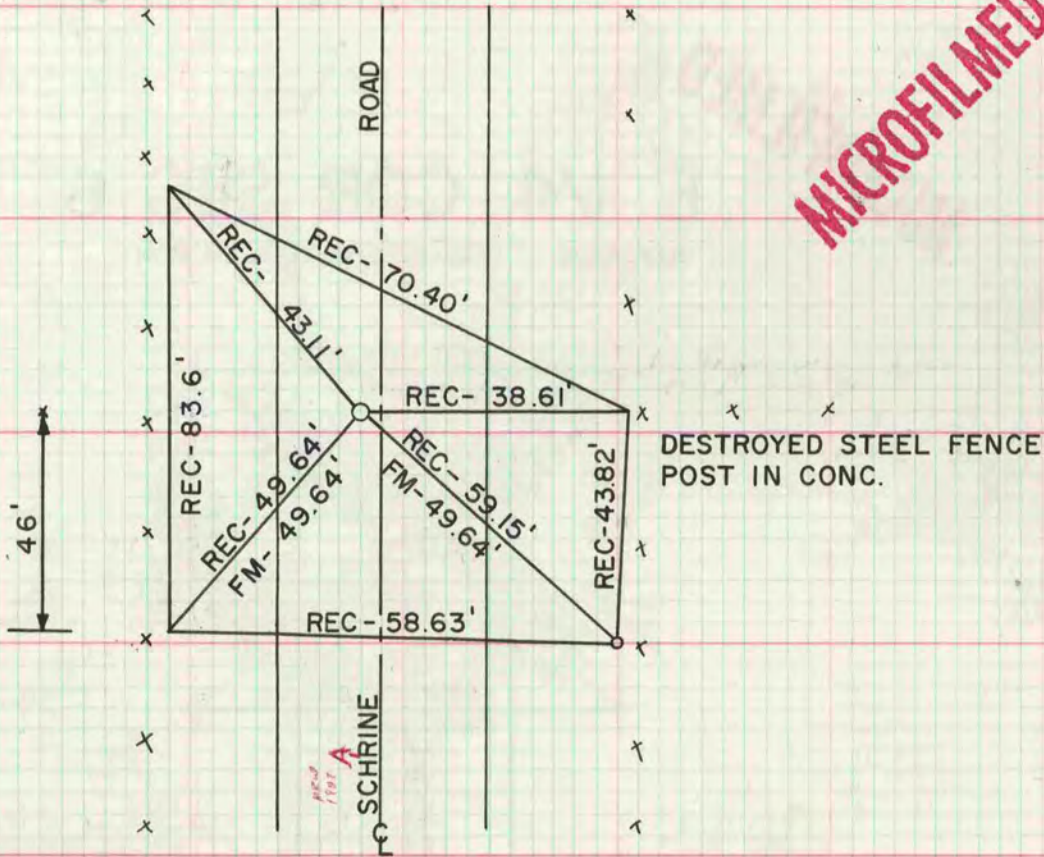

E 1/4 COR SEC 11 T2N R14E  
ADDED CAST IRON RISERS

SE COR SEC 11 T2N R14E  
CAST IRON MON BROKE OFF SET PK NAIL AT PAVEMENT  
SURFACE

S 1/4 COR SEC 14 T2N R14E  
ADDED ALUM RISER

NE COR SEC 15 T2N R14E  
ADDED RISER TO CAST IRON MON