

# PLAT AND RECORD

Of a Survey on Section 8 T 4 R 11 E. of the 4 P. M. in PORTER Township

Rock County, Wisconsin, made Oct the 28 19 84

I hereby certify that the following is a correct record of said survey as made by me.

COUNTY BUILDING  
CITY OF JANESVILLE

*Ronald Baines*

County Surveyor.

**MICROFILMED**

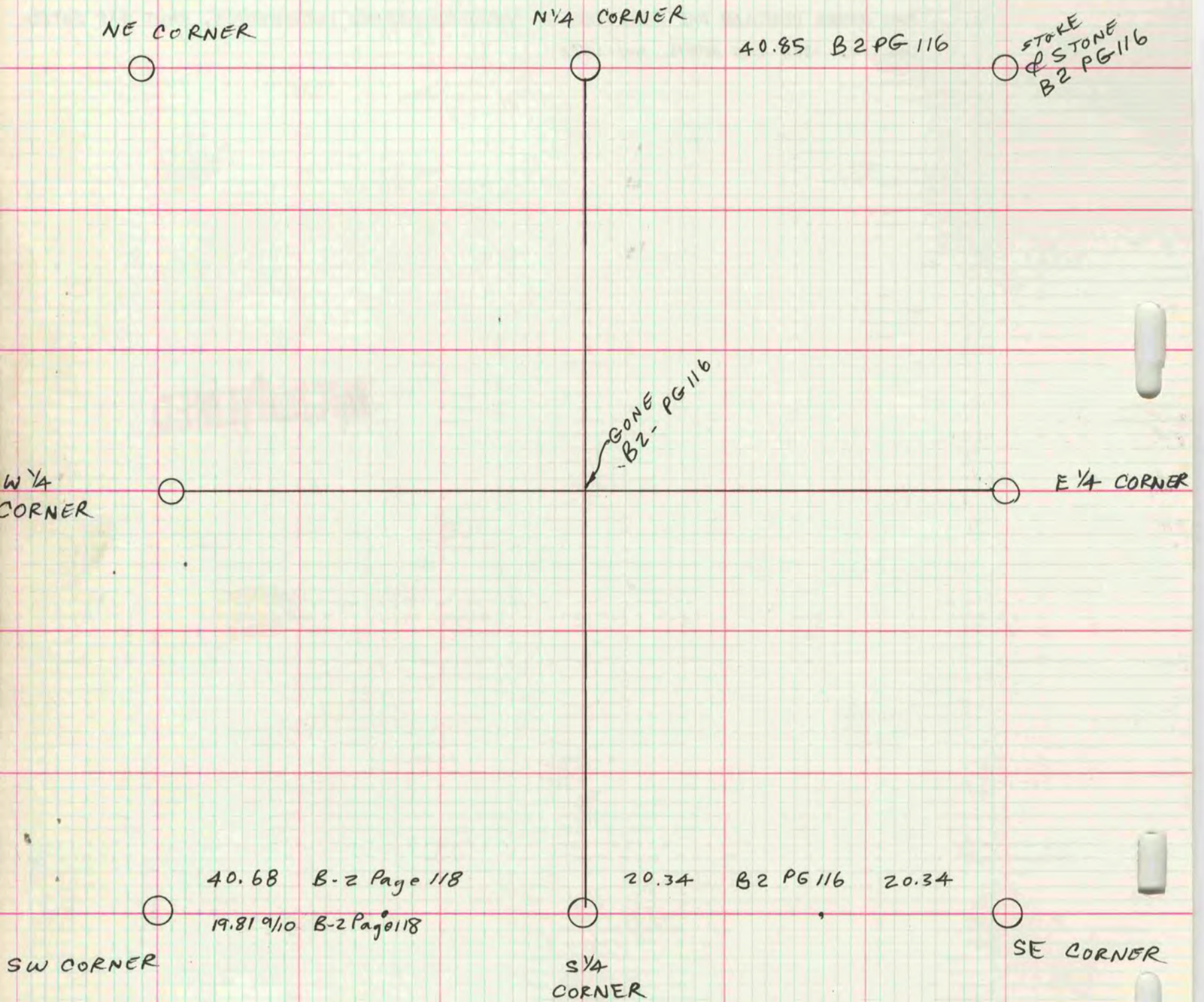

B-2 PG 116 DATED APR 30, 1892

INFORMATION FOUND IN MICROFILM COPIES OF FIELD NOTES.