

# PLAT AND RECORD

COUNTY BUILDING  
CITY OF JANESVILLE

Of a Survey on Sections 34 & 35 T 2 R 11 E. of the 4 P. M. in Plymouth Township  
Rock County, Wisconsin, made January the 8 & 9 1874

I hereby certify that the following is a correct record of said survey as made by me.

*Re-Survey of a Highway & the  
Alteration of a portion of it.*

*(Signed) Edward Roger*

R.H.B. County Surveyor.

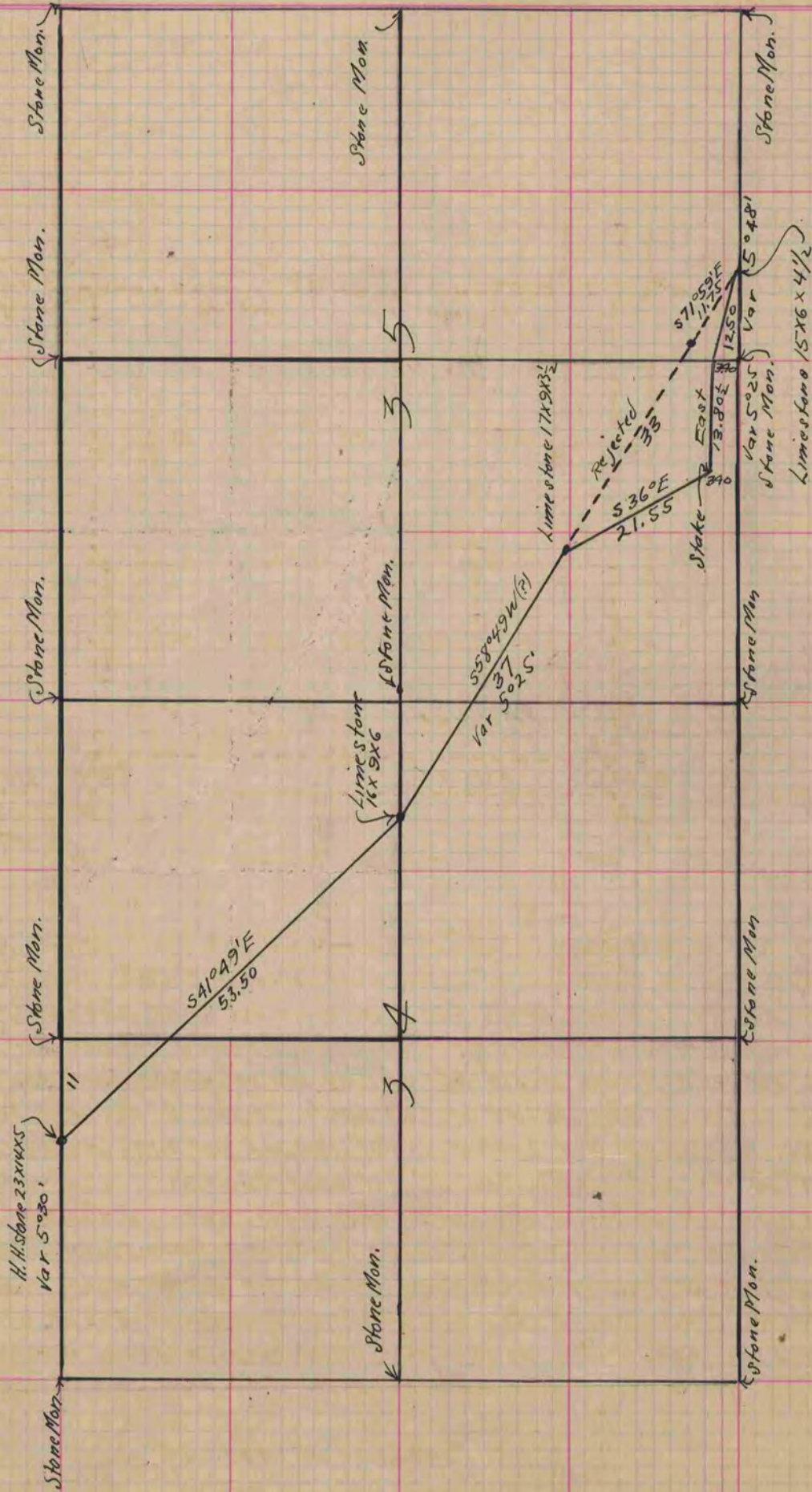

*Copied from Page 80 Vol. 2. Original County Surveyors Record*