

Of a Survey on Section **27** T **I** R **II** E. of the 4 P. M. in **NEWARK** Township
Rock County, Wisconsin, made **JUNE** the **11** 19 **79**

I hereby certify that the following is a correct record of said survey as made by me.

Donald Baines
DONALD A. BAINES
S-1216
JANESVILLE
County Surveyor.

S 1/4 COR SEC 27

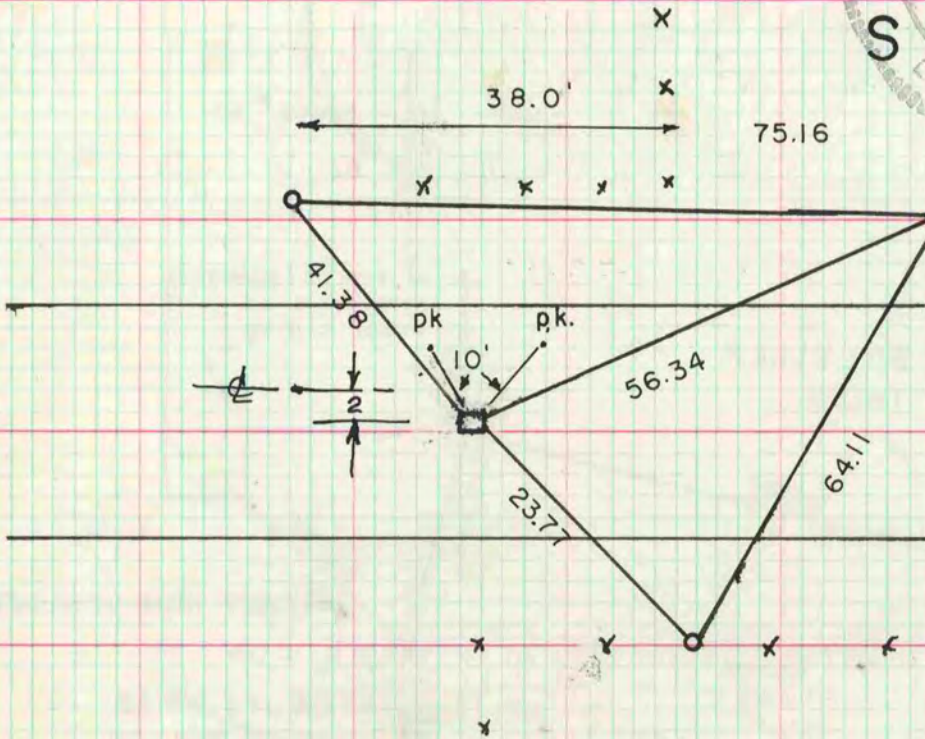

○ - 1" IRON PIPE
DUG AND FOUND CUT LIMESTONE
2' DEEP, PLACED I.P. HORIZONTALLY
ON N SIDE OF STONE.
SET ALUM. MON. ON TOP OF STONE.

MICROFILMED

E 1/4 COR SEC 27

FOUND PARTS OF CUT LIMESTONE
2.5' DEEP, SET ALUM. MON.

