

# PLAT AND RECORD

COUNTY BUILDING  
CITY OF JANESVILLE

Of a Survey on Section **5** T **4** R **11** E. of the 4 P. M. in **PORTER** Township

Rock County, Wisconsin, made the **1962**

I hereby certify that the following is a correct record of said survey as made by me.

**MICROFILMED**

*RWB*  
County Surveyor.

County Surveyor.

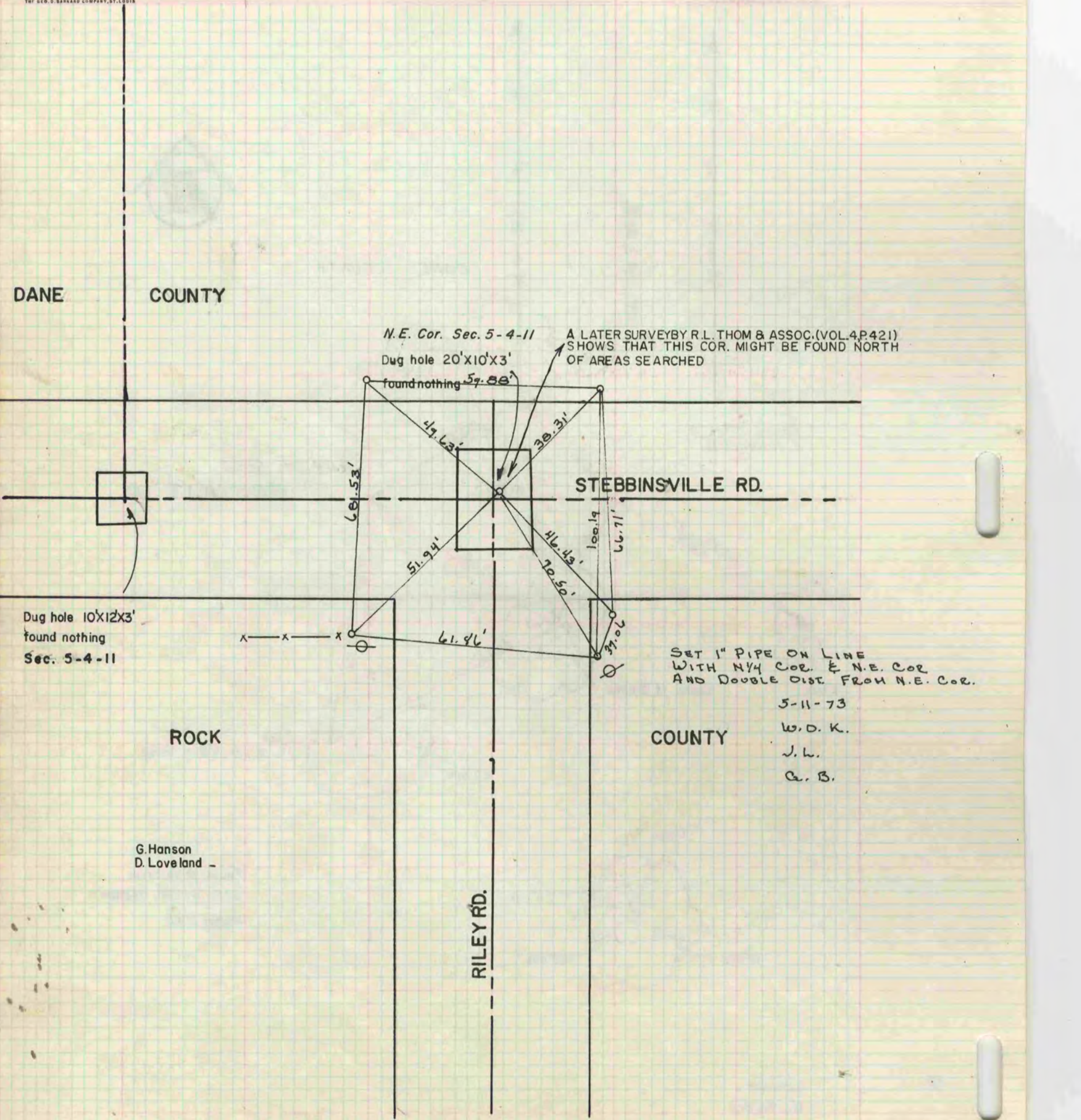

DANE COUNTY

N.E. Cor. Sec. 5-4-11

A LATER SURVEY BY R.L. THOM & ASSOC. (VOL. 4, P. 421) SHOWS THAT THIS COR. MIGHT BE FOUND NORTH OF AREAS SEARCHED

Dug hole 20'x10'x3'  
found nothing

STEBBINSVILLE RD.

Dug hole 10'x12'x3'  
found nothing  
Sec. 5-4-11

SET 1" PIPE ON LINE WITH 3/4 COR. & N.E. COR AND DOUBLE DIST. FROM N.E. COR.

5-11-73

W.D.K.

J.L.

G.B.

ROCK COUNTY

COUNTY

G. Hanson  
D. Loveland

RILEY RD.