

184
VOL. 6

PLAT AND RECORD

Of a Survey on Section ~~35~~³ T. 3 R. 13 E. of the 4 P. M. in HARMONY Township
Rock County, Wisconsin, made JULY the 31 19 81

I hereby certify that the following is a correct record of said survey ~~as made by me.~~

COUNTY BUILDING
CITY OF JANESVILLE

Ronald Barnes
County Surveyor.

FD IRON PIPE BELOW PAVEMENT

S¹/₄ ~~COR CENTER OF~~ SEC 33

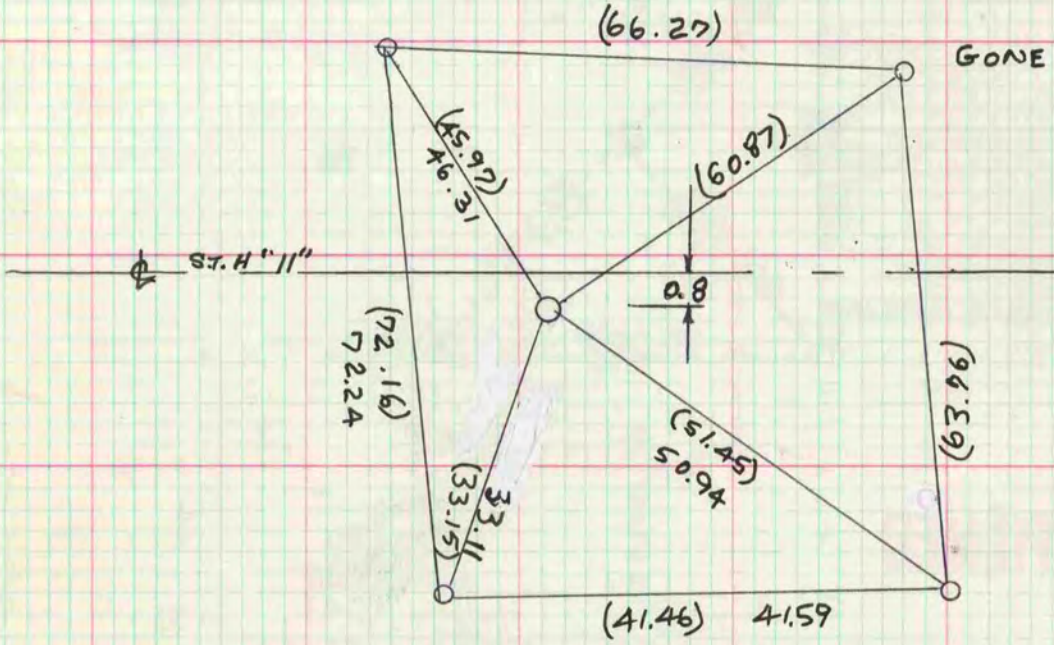

NUMBERS IN PARENTHESIS- TIE DISTANCES FROM VOL 4, P106 OF COUNTY SURVEYOR'S RECORDS

INFORMATION SUPPLIED BY NORMAN TRUE S-1024 AUG 6 1981

MICROFILMED