

MICROFILMED

PLAT AND RECORD

COUNTY BUILDING
CITY OF JANESVILLE

Of a Survey on Section 22 T 2 R 10 E. of the 4 P. M. in Spring Valley Township

Rock County, Wisconsin, made April the 1st 1857

I hereby certify that the following is a correct record of said survey as made by me.

(Signed) Joseph Church by Chas. H. Brown
Deputy County Surveyor
R. H. B. County Surveyor.

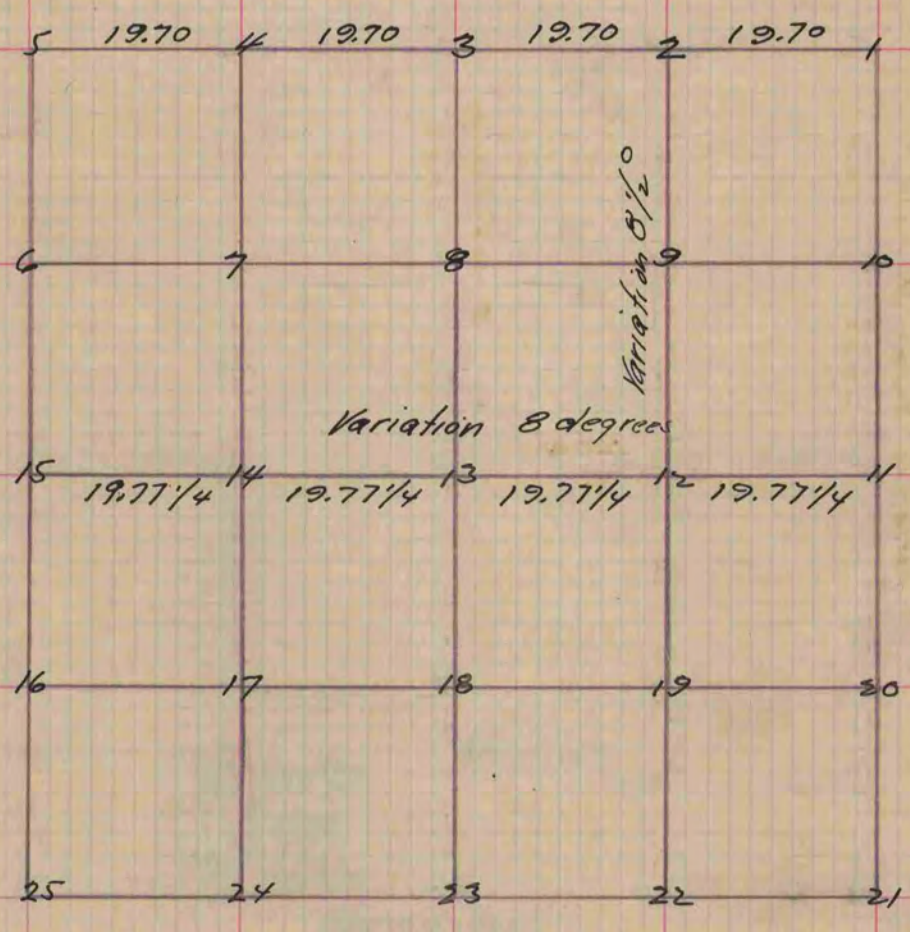

- Fig 12 Stump ten inches N. 4 1/2 E 9 1/2 links
- S. 22 1/2 W. 40 "
- " 13 W. O. 12 " N 76 W. 108 "
- Br. O. 12 " N 60 E. 140 "
- " 14 W. O. 20. " N 31 1/2 W. 36 "
- Stump " " S. 11 1/2 W 11 1/4 "

Copied from Page 72 Vol. 1. Original County Surveyors Record