

PLAT AND RECORD

VOL. 5

16
27
6, 8,
31

1
2
1

11
10
10
10

NEWARK
SPRING VALLEY
AVON
UNION

Of a Survey on Section T 4 R 10 E. of the 4 P. M. in Township

Rock County, Wisconsin, made SEPT 13 the 1977

I hereby certify that the following is a correct record of said survey as made by me
**COUNTY BUILDING
CITY OF JANESVILLE**

Donald Barnes
County Surveyor.

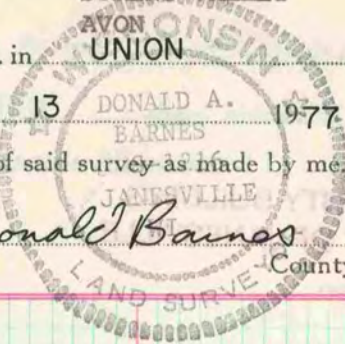

S 1/4 cor sec 31-4-10
fd 1/4" rebar. set alum mon

O = fd 1" I.P.
● = set G-I mon with cap

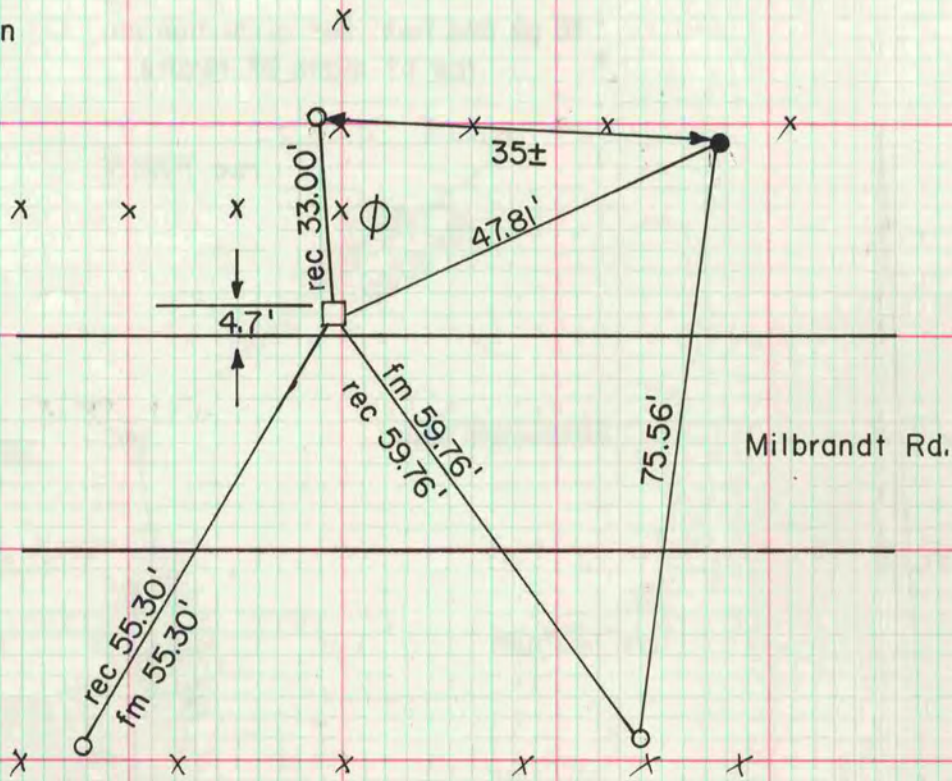

TOWNSHIP	SEC	CORNER	FOUND	SET	REMARKS
Spring Valley	27	SW SW	1" IP	Alum mon 1' deep	IP bent
Avon	6	S1/4	2" IP	Alum mon	
Avon	8	E1/4	2" IP	Alum mon	
Newark	16	E1/4	R/R spike	Alum mon	3' deep fd cut stone

MICROFILMED