

PLAT AND RECORD

393

VOL. 5

Of a Survey on Section 22 T 3 R 10 E. of the 4 P. M. in MAGNOLIA Township
Rock County, Wisconsin, made FEBRUARY 27 1978

I hereby certify that the following is a correct record of said survey as made by me.

COUNTY BUILDING
CITY OF JANESVILLE



County Surveyor.

E 1/4 CORNER SEC 22

FORMER COUNTY SURVEYOR DUG AND FOUND NOTHING. SET ON LINE WITH NE & SE CORNER SECTION 22 AT SINGLE PROPORTIONATE DISTANCE. AS R. LEE DID IN 1869.

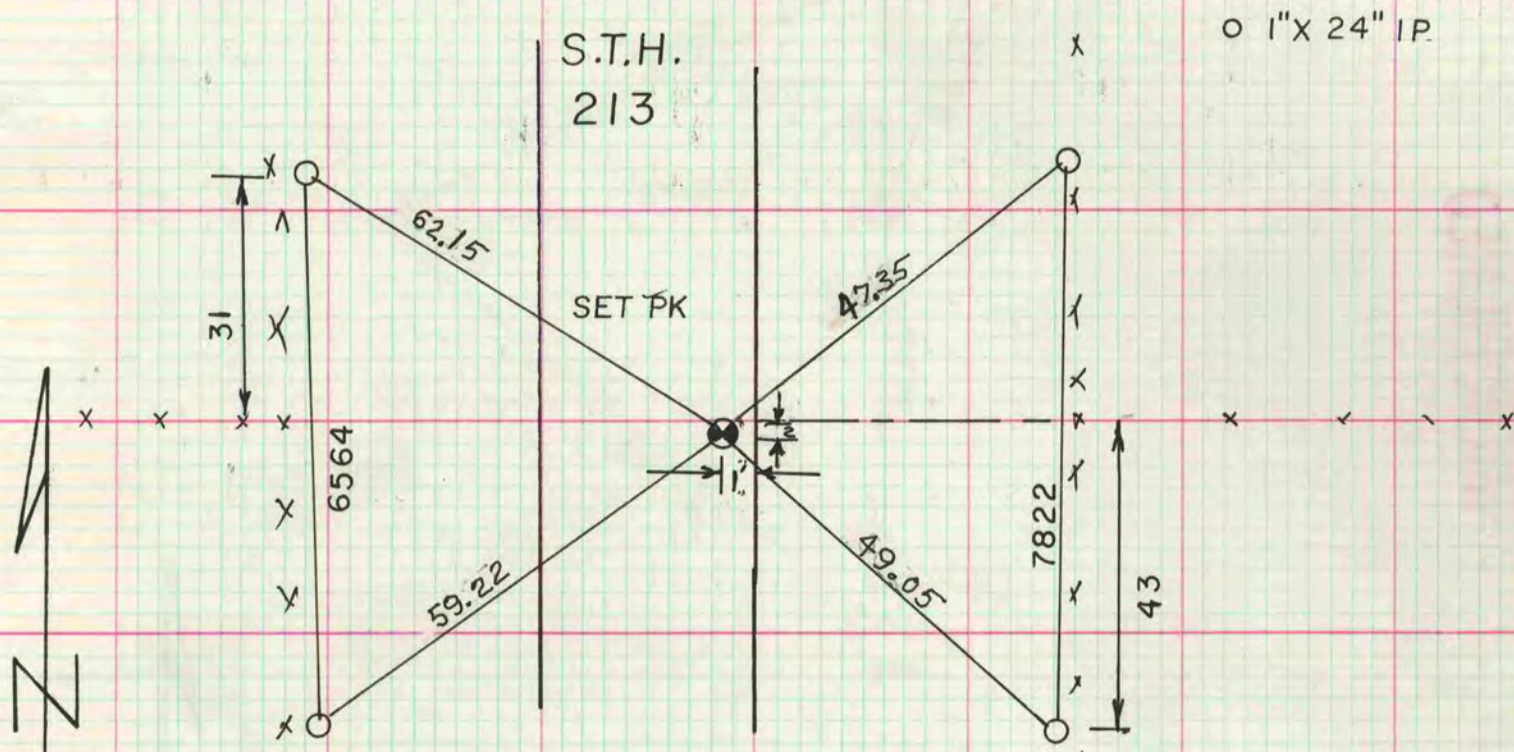

MICROFILMED

