

PLAT AND RECORD

207

V-5

COUNTY BUILDING
CITY OF JANESVILLE

Of a Survey on Section 5, 29, T 3 R 11 E. of the 4 P. M. in Center PORTER Township

Rock County, Wisconsin, made AUG the 19 1976

I hereby certify that the following is a correct record of said survey as made by me

MICROFILMED

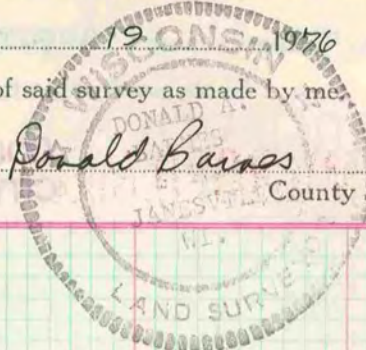

CENTER of SEC 29 PORTER TWP

○ dug & found nothing

SW COR of NW 1/4 of NE 1/4 SEC 32 PORTER TWP

○ dug & found nothing

SW COR of NW 1/4 of NE 1/4 SEC 5 CENTER TWP.

○ dug & found nothing

CENTER of SEC 5 CENTER TWP,

○ dug & found nothing