

PLAT AND RECORD

COUNTY BUILDING
CITY OF JANESVILLE

Of a Survey on Section 24 T 1 N. R 13 E. of the 4 P. M. in TURTLE Township

Rock County, Wisconsin, made October the 21 1976

I hereby certify that the following is a correct record of said survey as made by me.

MICROFILMED

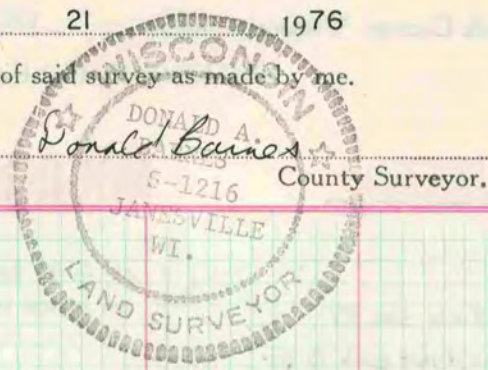

S 1/4 cor sec 24

Dug large hole 10' wide and 4' deep across the road and fd. nothing. Set cor by single proportionate measurement and on line with the SE & SW cors sec 24.

