

202  
V-5

# PLAT AND RECORD

COUNTY BUILDING  
CITY OF JANESVILLE

Of a Survey on Section 8 T 1 R 10 E. of the 4 P. M. in Avon Township

Rock County, Wisconsin, made August the 17



I hereby certify that the following is a correct record of said survey as made by me.

**MICROFILMED**

NW Cor. SW<sup>1</sup>/<sub>4</sub> of the NE<sup>1</sup>/<sub>4</sub> Sec. 8

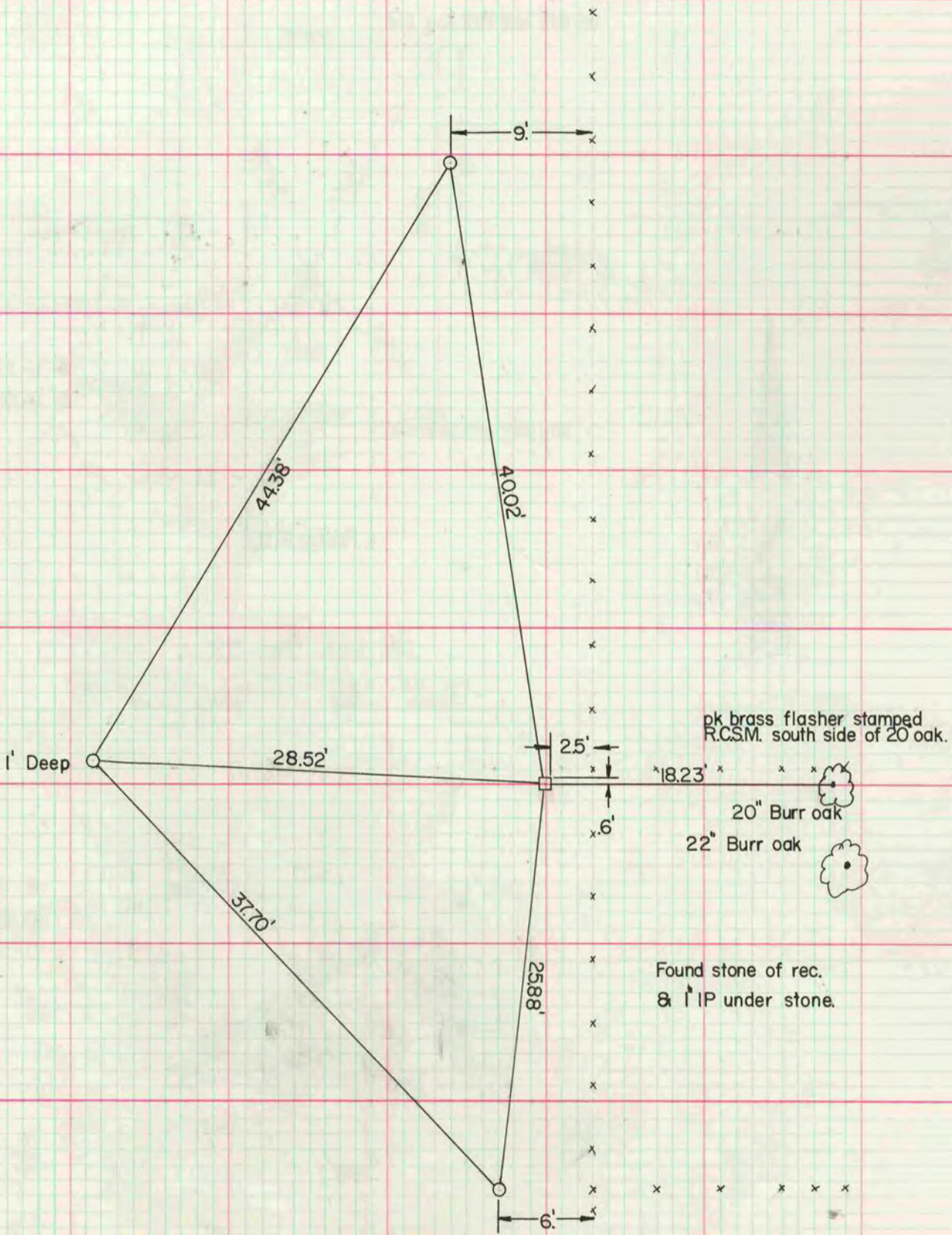

○ 1 1/2 x 24 I.P.