

V-1 MICROFILMED

# PLAT AND RECORD

Of a Survey on Section 10 T 1 R 13 E. of the 4 P. M. in Turtle Township

Rock County, Wisconsin, made May the 17th 1864

I hereby certify that the following is a correct record of said survey as made by me.

COUNTY BUILDING  
CITY OF JANESVILLE

(Signed) S. D. Locke  
R.H.B. County Surveyor.

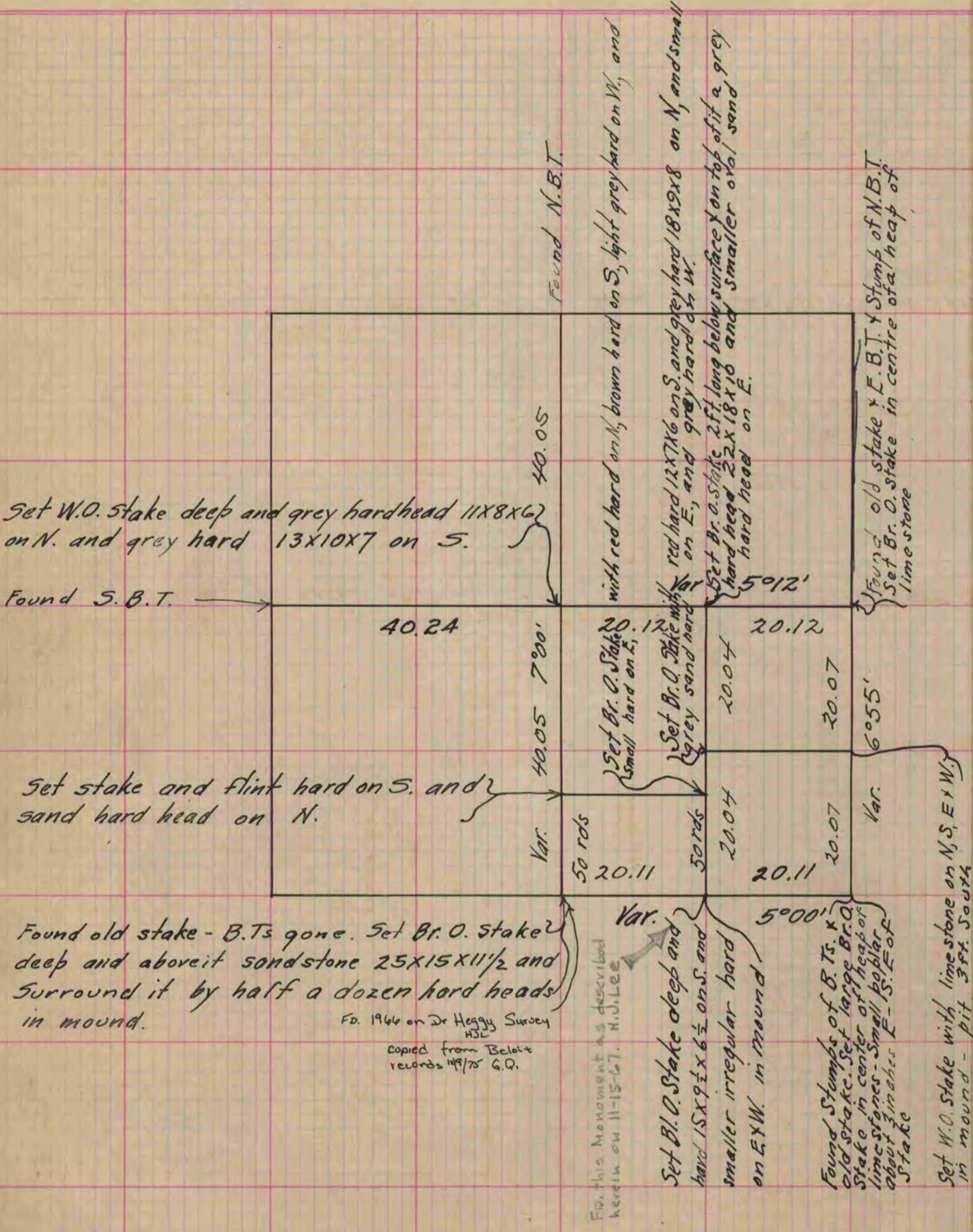

Copied from lower 1/2 of Page 202 Vol. 1. Original County Surveyors Record