

MICROFILMED

PLAT AND RECORD

491
V-2

COUNTY BUILDING
CITY OF JANESVILLE

Of a Survey on Section 31 T 4 R 13 E. of the 4 P. M. in Milton Township

Rock County, Wisconsin, made May the 2 1895

I hereby certify that the following is a correct record of said survey ~~as made by me.~~

(Signed) P. F. Brown
R. H. B. County Surveyor.

Bleedorn Survey.

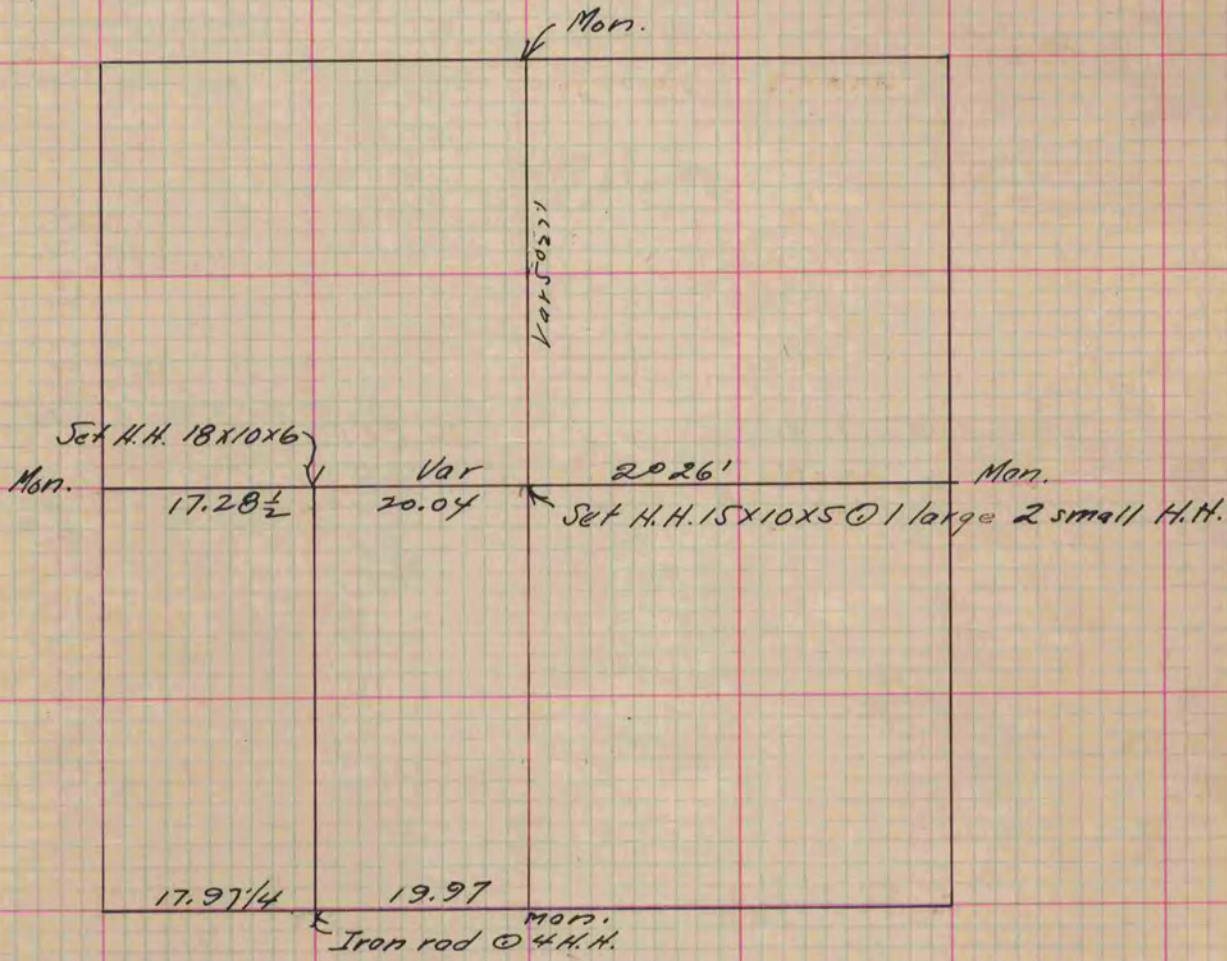

H. H. set on N. W. cor. of E. 1/2, S. W. 1/4, Sec. 30. set 6 1/2 ft. too far N. by mistake

Copied from P. 379 Vol. 2. County Surveyors Record.