

42  
VI **MICROFILMED** PLAT AND RECORD

Of a Survey on Section 8 T 2 R 10 E. of the 4 P. M. in Spring Valley Township  
 Rock County, Wisconsin, made June the 6<sup>th</sup> & 7<sup>th</sup> 1855

I hereby certify that the following is a correct record of said survey as made by me.

COUNTY BUILDING  
CITY OF JANESVILLE

(Signed) Joseph Church  
County Surveyor.

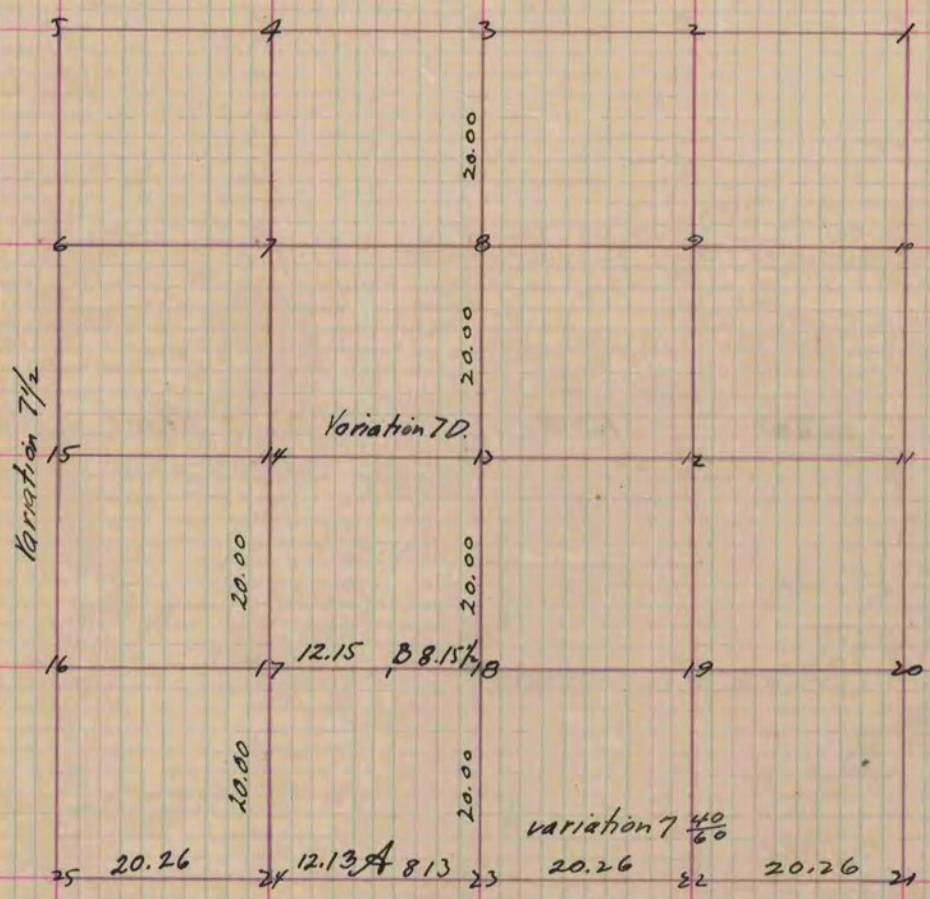

Fig 13	Bur 0 24 S 59 1/2 E 200 links	Bur 0. 16 S 28 1/2 E 115 links
B.	" " 24 N 48 W 688 "	" " N 25 W 335 "
A	" " 18 S 12 E 196 "	" " 16 S 49 1/2 E 112 "
" 23	" " S 59 W 48 "	" " 20 S 17 1/2 W 87 "
" 18	Bur " 20 N 14 1/2 W 25 "	" " 20 S 81 W 17 "
" 17	" " 20 S 51 E 57 "	" " 24 N 26 W 53 "
" 8	" " 24 S 63 E 135 "	" " 18 S 19 W 66 "

Copied from Page 43 Vol. 1. Original County Surveyors Record