

PLAT AND RECORD

Of a Survey on Section **29, 28** T **12** R **14** E. of the 4 P. M. in **BRADFORD** Township
Rock County, Wisconsin, made **NOV** the _____ 19**81**

I hereby certify that the following is a correct record of said survey as made by me.

**COUNTY BUILDING
CITY OF JANESVILLE**

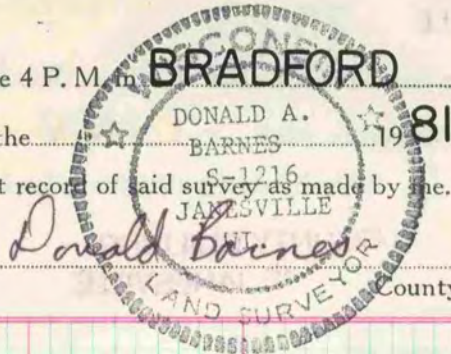

County Surveyor.

CENTER OF SEC 28

FD Δ SHAPED HH 3" THICK 17"X12X11" ALONG EDGE OF STONE. REPLACED WITH BERNTSEN W-1-C POLYSTYRENE MON. STONE IS .57' EAST OF N/S $\frac{1}{4}$ LINE AND 5.2' NORTH OF E/W $\frac{1}{4}$ LINE.

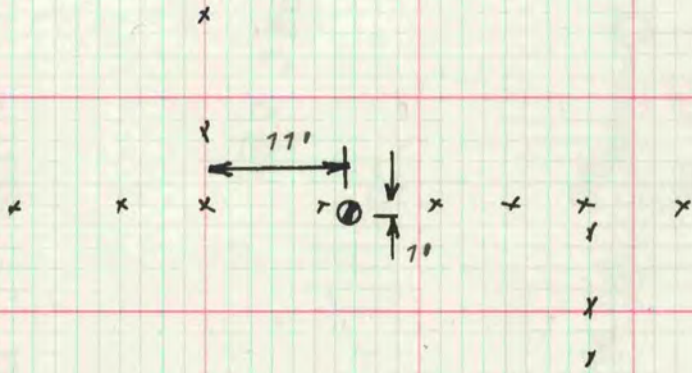

SI/16th COR NW 1/4 SEC 28

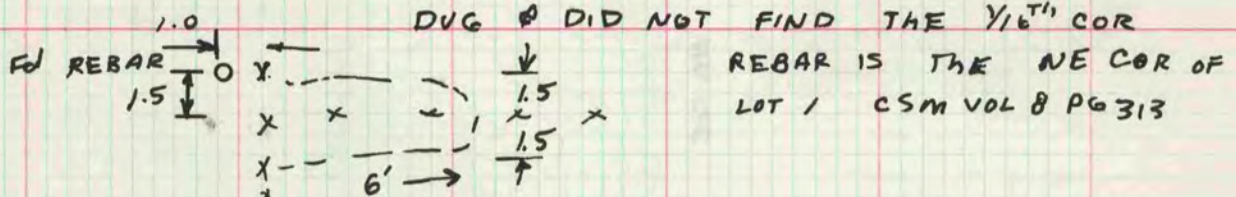

CENTER OF SEC 29

LOCK DID NOT STATE WHAT IF ANYTHING HE SET AT THE CENTER. FOUND 2 LARGE PIECES OF LIMESTONE ON TOP OF EACH OTHER (PROBABLY ONE STONE THAT WAS BROKEN). 3.68' SOUTH OF E/W $\frac{1}{4}$ LINE & 1.31 EAST OF N/S $\frac{1}{4}$ LINE

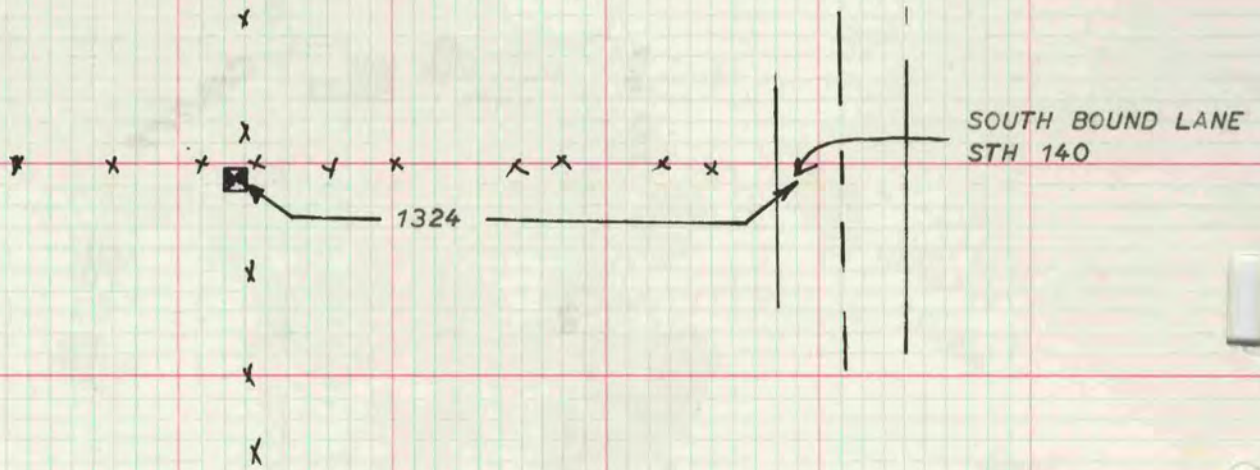

MICROFILMED