

# PLAT AND RECORD

229

VOL. 6

Of a Survey on Section 8, 19 T 2 R 14 E. of the 4 P. M. in BRADFORD Township  
Rock County, Wisconsin, made NOV the

I hereby certify that the following is a correct record of said survey as made by me.

COUNTY BUILDING 1  
CITY OF JANESVILLE

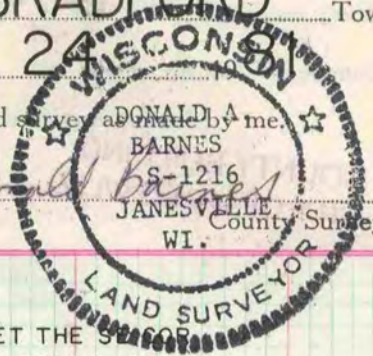

## SE COR SEC 8

SET R & R SPIKE. IT IS ON LINE WITH FENCE TO THE EAST. RUGER SET THE SE COR SEC 8, THE S 1/4 COR SEC 8, & THE SE COR SEC 9 ALL ON LINE. I ESTABLISHED THE SE COR SEC 8 BY PROJECTING THE S 1/4 COR & THE SE COR SEC 9. THIS IS IN HARMONY WITH OCCUPATION & ORIG GOV DISTANCE.

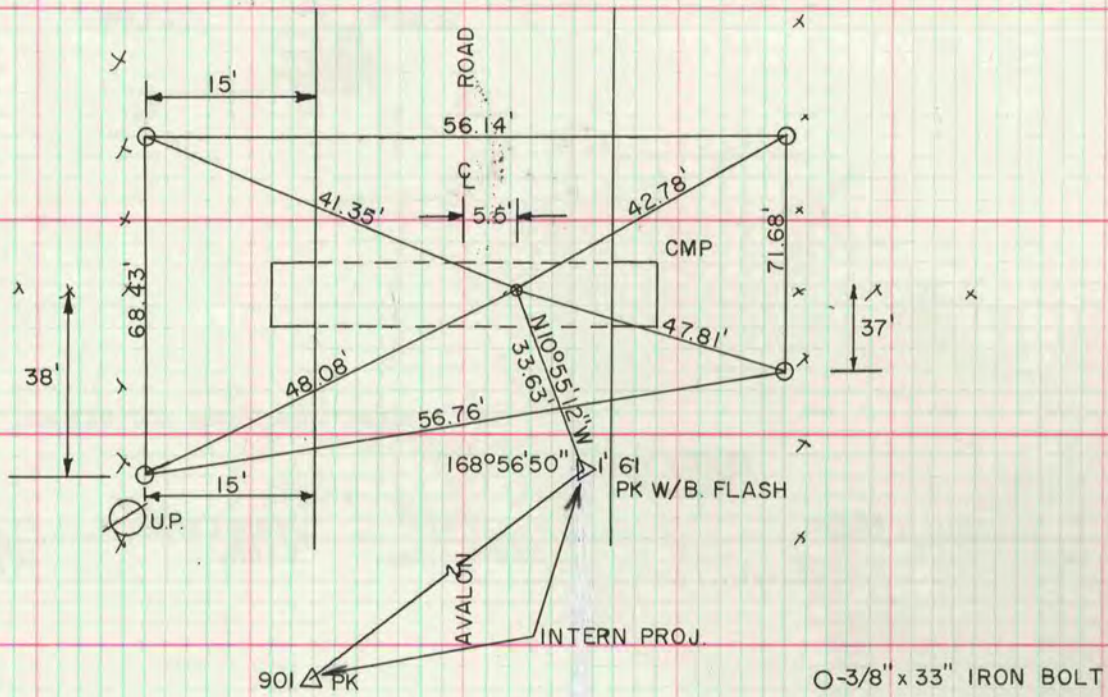

## E 1/4 COR SEC 19

DUG & FOUND NOTHING SET POLYSTYRENE MON ON STRAIGHT LINE AT MID POINT BETWEEN NE & SE COR. THIS IS IN HARMONY WITH OLD & NEW FENCE LINES. SET CARSONITE POST

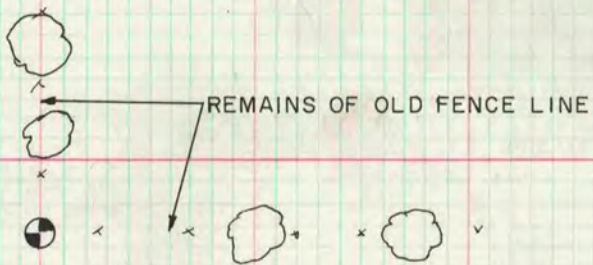

## E 1/4 COR SEC 8

SET POLYSTYRENE MON OLD MON MAP INDICATES FORMER COUNTY SURVEYOR DUG & FOUND NOTHING, ROAD CONDITIONS INDICATE SUCH. MON ON LINE WITH SE & NE CORNERS AT MID POINT

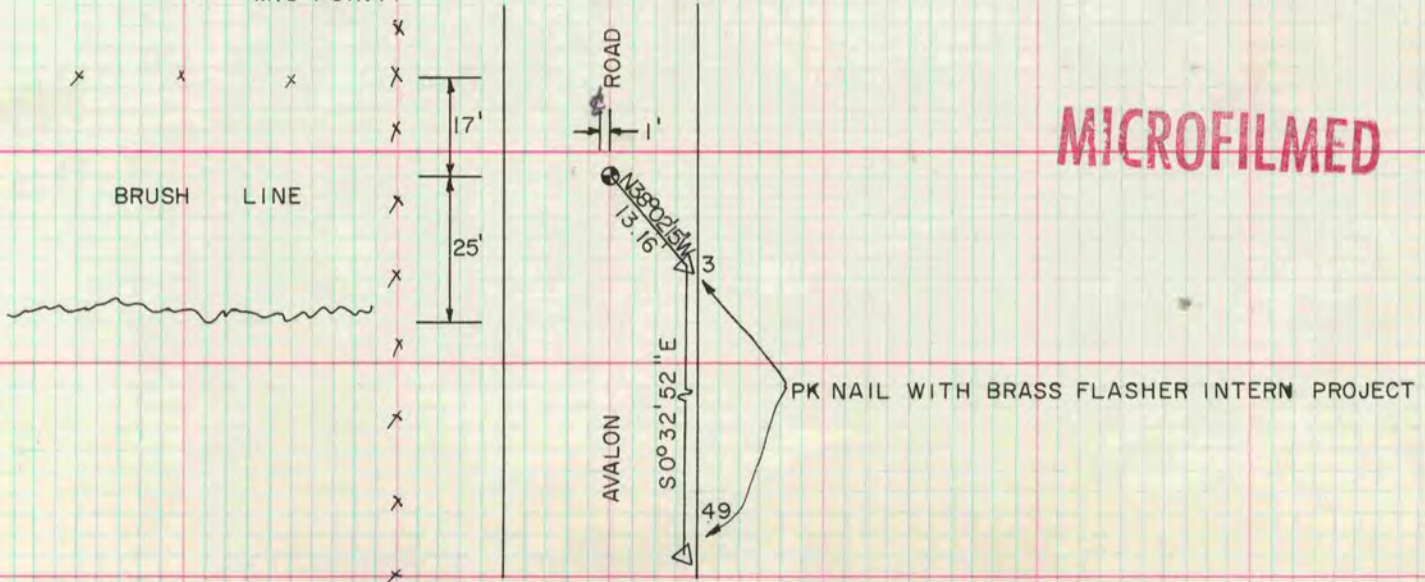

MICROFILMED