

PLAT AND RECORD

245

COUNTY BUILDING
CITY OF JANESVILLE

v-5

Of a Survey on Section 2 T 4 R 12 E. of the 4 P. M. in FULTON Township

Rock County, Wisconsin, made FEB the 22 1977

I hereby certify that the following is a correct record of said survey as made by me.



County Surveyor.

S 1/4 cor sec 2-4-12
fd. C.I. mon

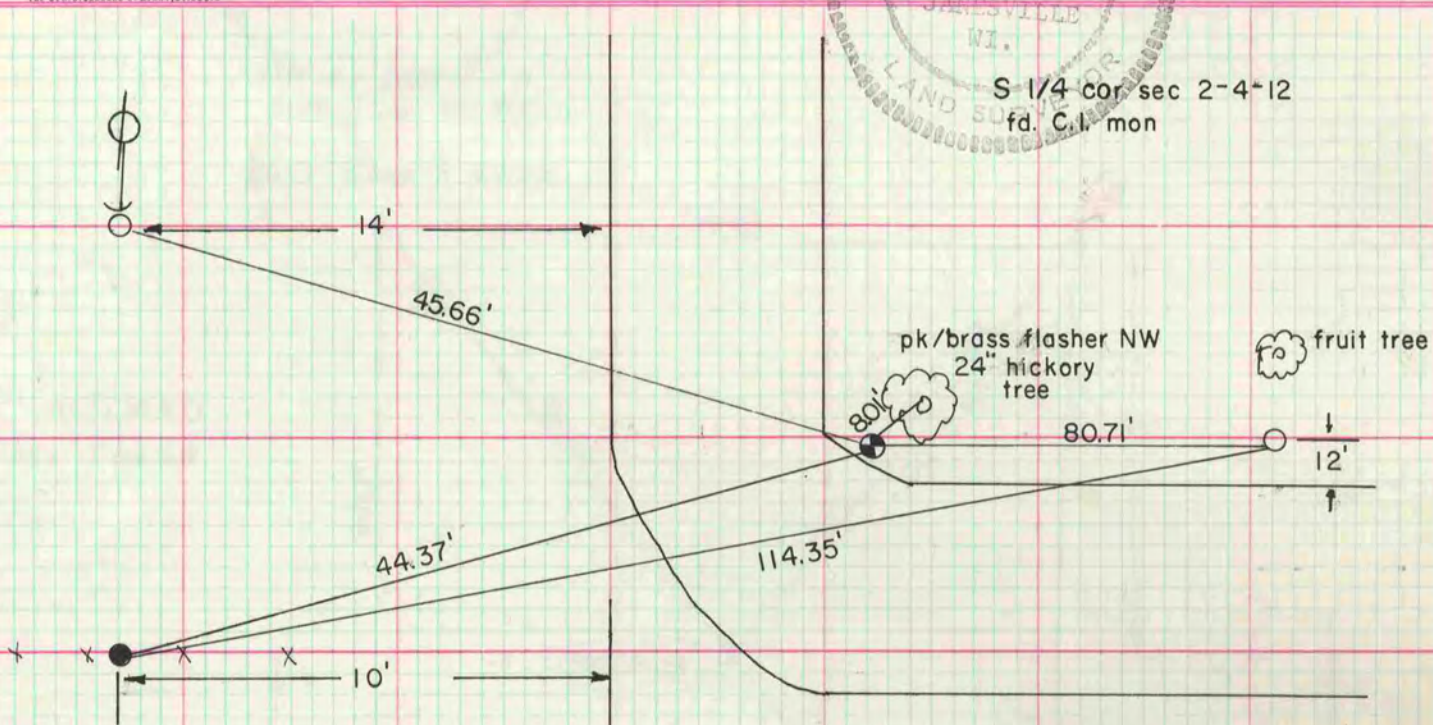

MICROFILMED

● = 1" x 24" I.P.
○ = 1" x 24" I.P.

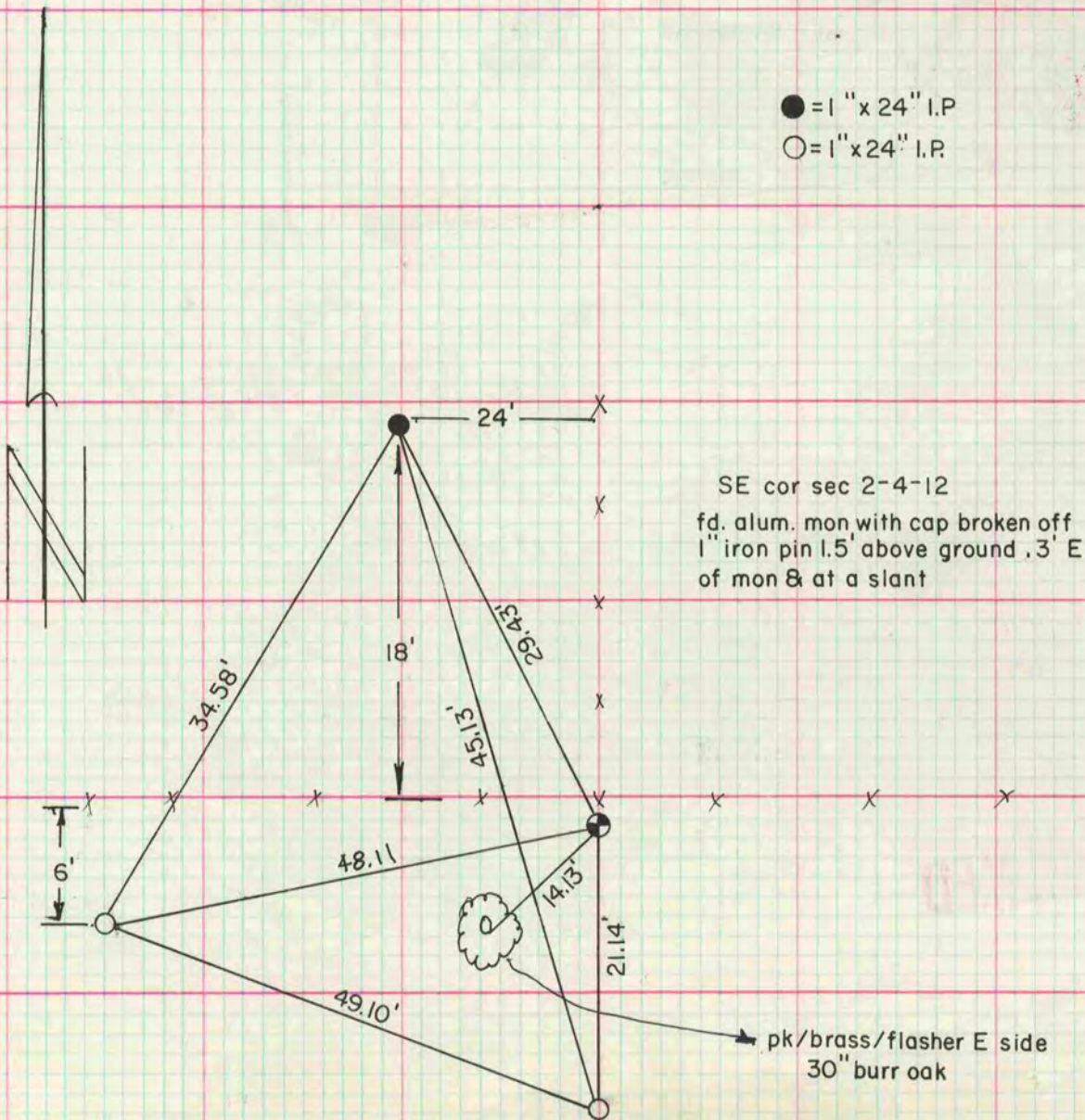

SE cor sec 2-4-12
fd. alum. mon with cap broken off
1" iron pin 1.5' above ground, 3' E
of mon & at a slant

MICROFILMED