

294 VOL. 5 PLAT AND RECORD

Of a Survey on Section 17 T 1 R 10 E. of the 4 P. M. in AVON Township
Rock County, Wisconsin, made JULY the 7

COUNTY BUILDING
CITY OF JANESVILLE



I hereby certify that the following is a correct record of said survey as made by me

NE cor sec 17-1-10
dug and fd sandstone 3"x12"x24"
stone was broken and laying on its
side with painted "X" on it, area
was marked by old lath and flagging
set alum mon.

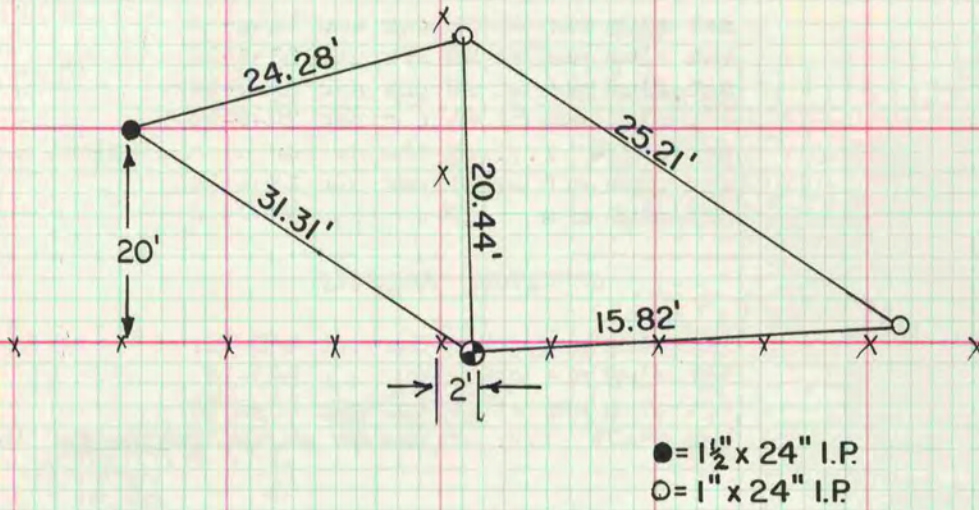

W 1/4 cor sec 17-1-10
set alum mon.

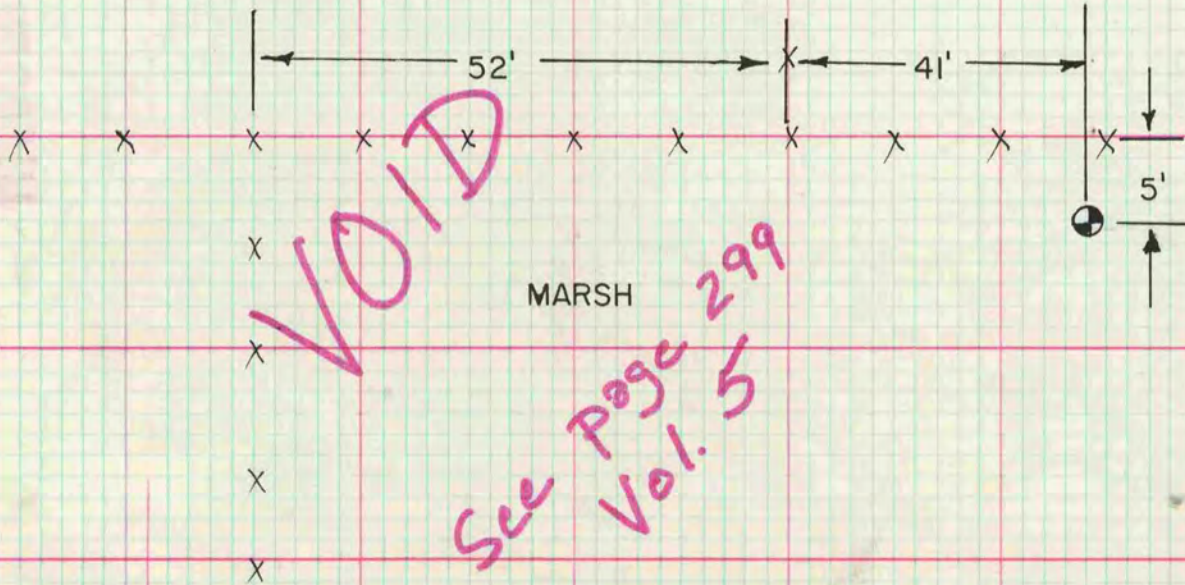

VOID
See Page 299
Vol. 5

MICROFILMED