

VOL. 5

Of a Survey on Section 13 T 3 R 14 E. of the 4 P. M. in JOHNSTOWN Township

Rock County, Wisconsin, made JUNE the 22 1978

I hereby certify that the following is a correct record of said survey as made by me

Donald Barnes
County Surveyor.

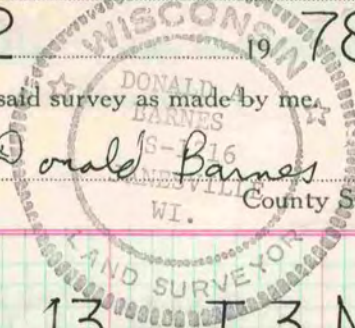

N.W. COR. SEC 13 T.3 N. R.14E

0-3/4" X 24" IP
FD. ALUM. MON.

CORNER WILL BE DESTROYED
OLD TIES WERE DESTROYED

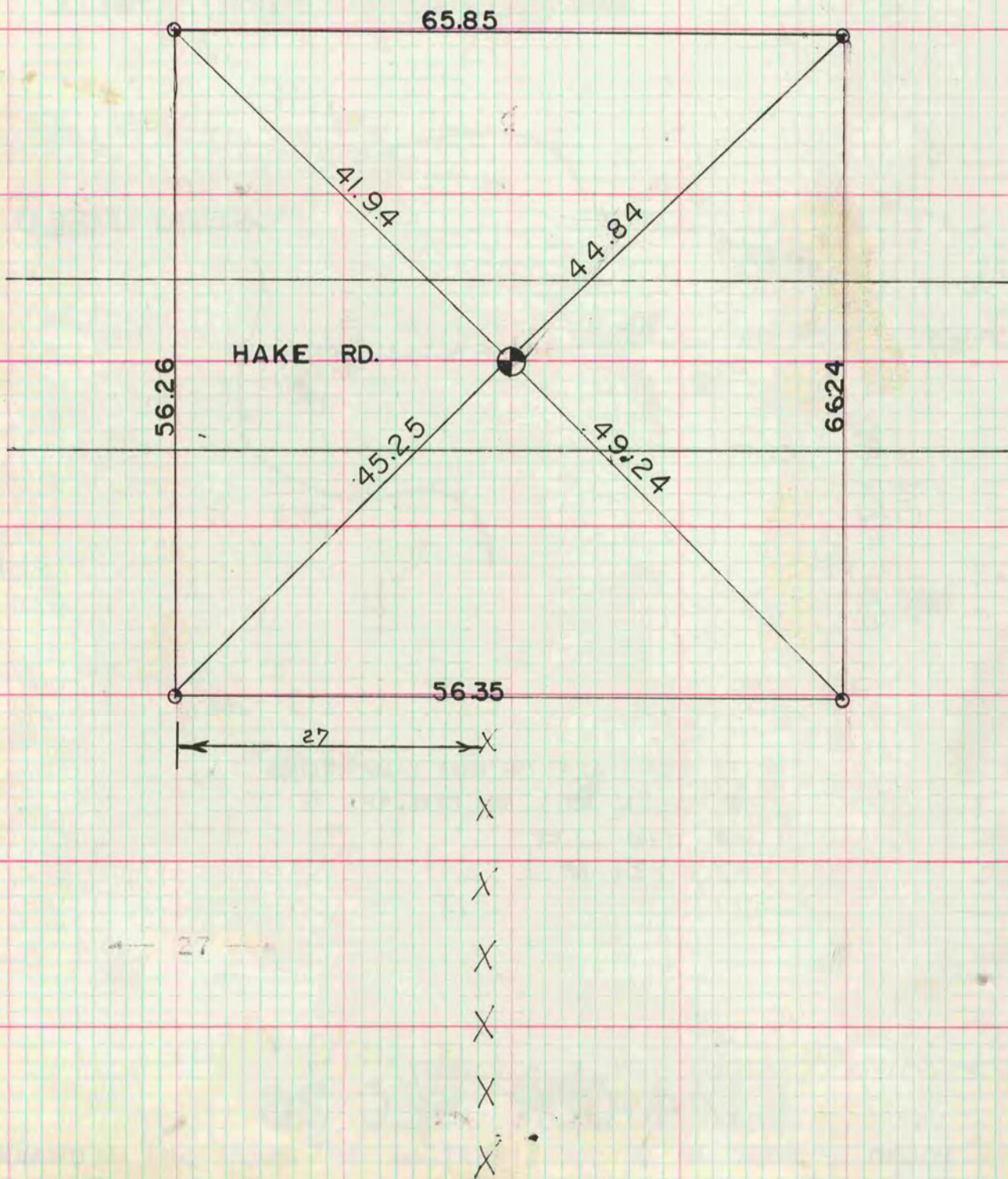
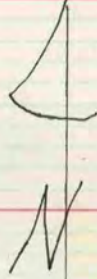

MICROFILMED