

# PLAT AND RECORD

**MICROFILMED**

COUNTY BUILDING  
CITY OF JANESVILLE

Of a Survey on Section 11 T 1 R 10 E. of the 4 P. M. in Avon Township

Rock County, Wisconsin, made June the 25 1874

I hereby certify that the following is a correct record of said survey as made by me.

(Signed) Edward Ruger  
R. H. B. County Surveyor.

Found remains of old stake - also found where stumps of B. Ts. had been dug up. Drove large Burr Oak stake in the place of old stake and set it with several stones

Drove stake + set it with 6 small stones

Found Cor. Est. by Locke, Corner Correct

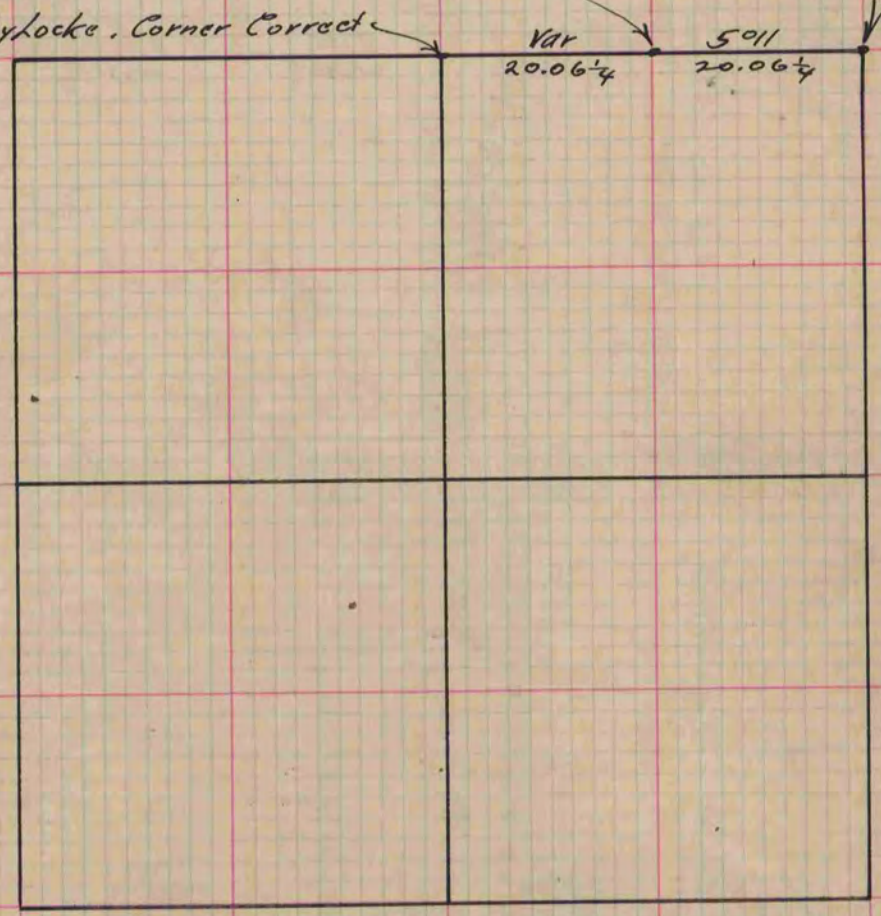

Copied from P. 102 V. 2, Original County Surveyors Record.