

PLAT AND RECORD

VOL. 6

Of a Survey on Section 7,6 T 1 R 15 E. of the 4 P. M. in SHARON Township
Rock County, Wisconsin, made JAN the _____ 1980

I hereby certify that the following is a correct record of said BARNES as made by me.

COUNTY BUILDING
CITY OF JANESVILLE

DONALD A. BARNES
 8-1216
 JANESVILLE
 WI.
 COUNTY SURVEYOR

NW COR
DATA SUPPLIED BY WALWORTH COUNTY SURVEYORS OFFICE

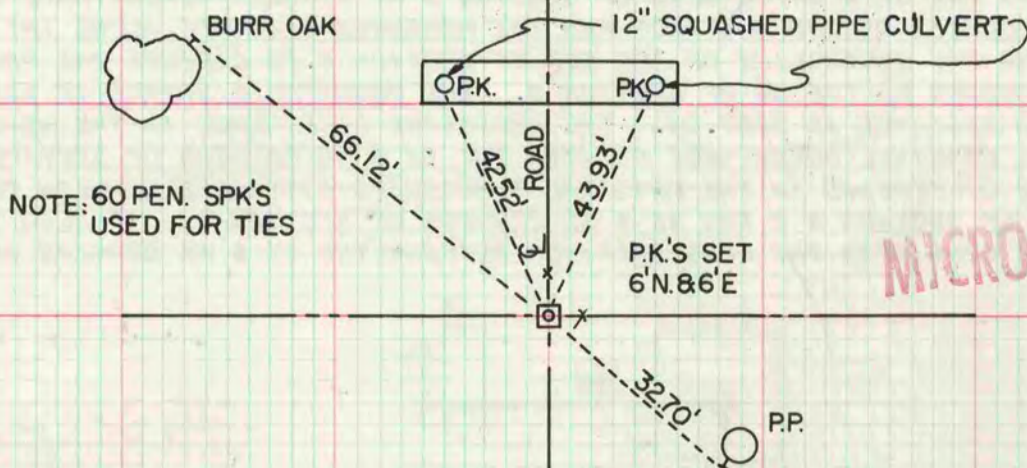

NOTE: 60 PEN. SPK'S
USED FOR TIES

MICROFILMED

REVISED

LOCATED BY T. JENSEN, S-1084, AUG 25, 1975

FOUND OLD CONC. MONUMENT 16" BELOW RD. SURFACE SET CONC.
CO. MARKER.

NW COR SEC 6

DATA SUPPLIED BY WALWORTH COUNTY SURVEYORS OFFICE

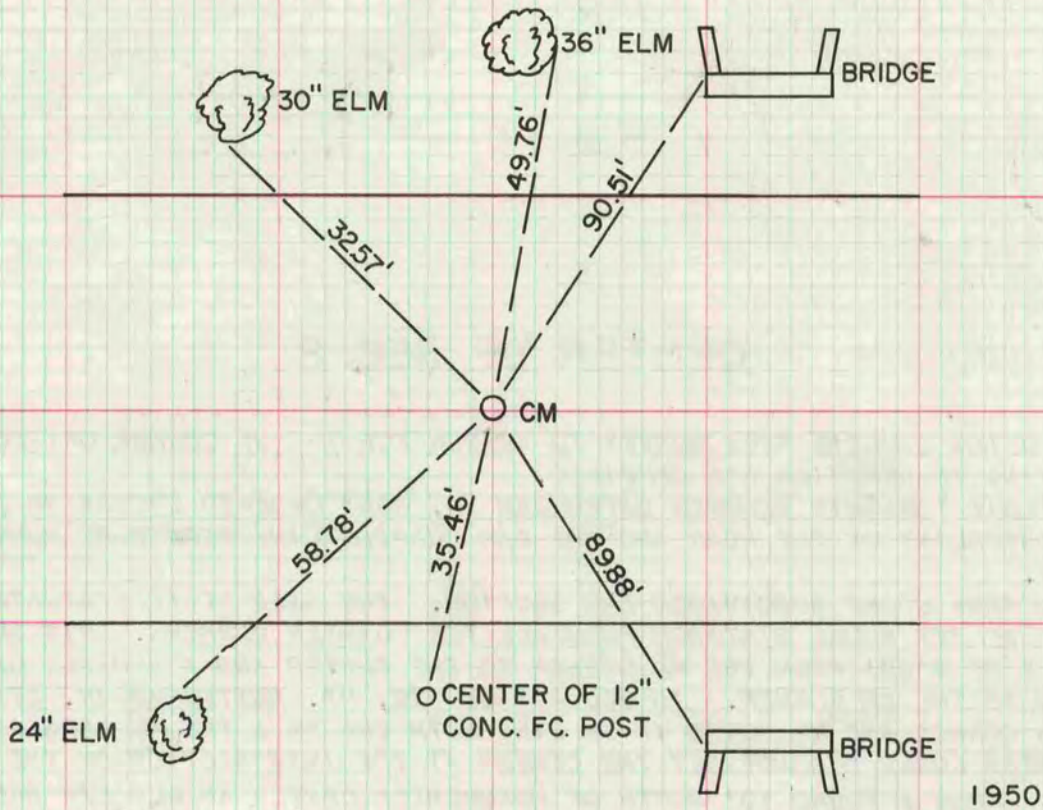

1950